



# Route Log and Progress Chart

**DRAFT**

Please Note: Errors and Omissions May Exist.  
Contact the VTrans Mapping Section with questions or concerns.

DISTRICT	TOWN	ROUTE
6	ORANGE	VT-110

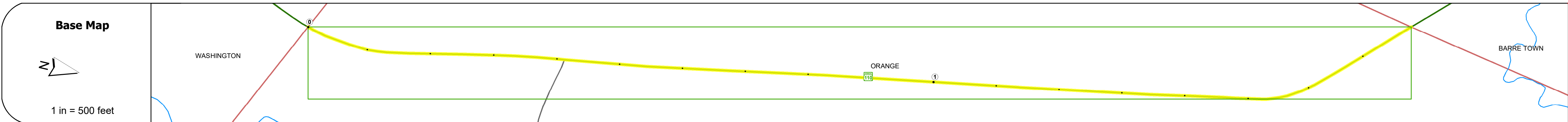
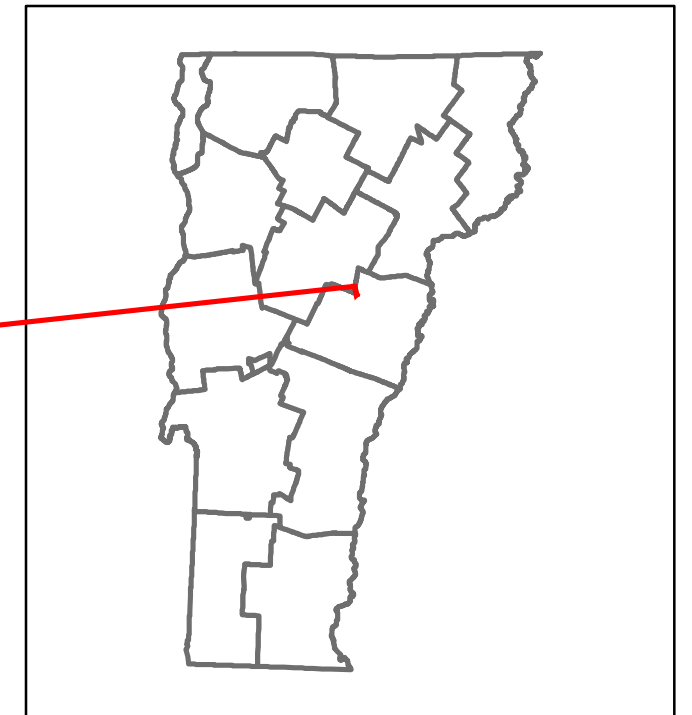

## STRUCTURE DESCRIPTIONS

Road Widths	<table border="1"> <tr><td>Travellane</td><td>27</td><td>22</td><td>26</td><td>27</td><td>28</td></tr> <tr><td>Roadway</td><td></td><td></td><td></td><td></td><td></td></tr> <tr><td>Lane Count</td><td>2</td><td></td><td></td><td></td><td></td></tr> <tr><td>Base</td><td></td><td></td><td></td><td></td><td></td></tr> <tr><td>Subbase</td><td></td><td>12" S.B.</td><td></td><td></td><td></td></tr> </table>	Travellane	27	22	26	27	28	Roadway						Lane Count	2					Base						Subbase		12" S.B.			
Travellane	27	22	26	27	28																										
Roadway																															
Lane Count	2																														
Base																															
Subbase		12" S.B.																													

Curves	3, 5, 6
--------	---------

Grades	-6.3
--------	------

Guardrails	
------------	--

Rumblestrips	
--------------	--

Historic Projects	<ul style="list-style-type: none"> <li>2020: STP FPAV(37)</li> <li>1999: STP 8744(1)S</li> <li>1989: HMA 2022</li> <li>1983: RS 0109(A)</li> <li>1977: Unknown</li> <li>1934: NRS 141</li> </ul>
-------------------	--

Maintenance Garage	District 6 - DMF Maintenance No. Montpelier Garage
--------------------	--

Speed Zone	
------------	--

Functional Class	5
------------------	---

National Highway System	
-------------------------	--

Limited Access Highway	
------------------------	--

Customer Service Level	Local Connector
------------------------	-----------------

Traffic Counters	N126
------------------	------

AADT	<table border="1"> <tr><td>2021</td><td>1991</td><td>1991</td></tr> <tr><td>2020</td><td>1757</td><td>1776</td></tr> <tr><td>2019</td><td>2074</td><td>2097</td></tr> <tr><td>2018</td><td>2100</td><td>2100</td></tr> <tr><td>2017</td><td>2100</td><td>2400</td></tr> </table>	2021	1991	1991	2020	1757	1776	2019	2074	2097	2018	2100	2100	2017	2100	2400
2021	1991	1991														
2020	1757	1776														
2019	2074	2097														
2018	2100	2100														
2017	2100	2400														

Crash Locations	<table border="1"> <tr><td>(Incomplete) 2022</td><td></td><td></td></tr> <tr><td>2021</td><td></td><td></td></tr> <tr><td>2020</td><td></td><td></td></tr> <tr><td>2019</td><td></td><td></td></tr> <tr><td>2018</td><td></td><td></td></tr> </table>	(Incomplete) 2022			2021			2020			2019			2018		
(Incomplete) 2022																
2021																
2020																
2019																
2018																

<b>Historic Projects</b> <ul style="list-style-type: none"> <li>Unknown</li> <li>Retreatment</li> <li>Resurface</li> <li>Bituminous Mix</li> <li>Skinny Mix</li> <li>Bituminous Seal</li> </ul>	<b>Functional Class</b> <ul style="list-style-type: none"> <li>1 - Interstate System</li> <li>2 - Other</li> <li>3 - Principal Arterial</li> <li>4 - Minor Arterial</li> <li>5 - Major Collector</li> <li>6 - Minor Collector</li> </ul>	<b>Curves</b> <ul style="list-style-type: none"> <li>Left</li> <li>Right</li> </ul>	<b>Grades</b> <ul style="list-style-type: none"> <li>grade up</li> <li>grade down</li> </ul>	<b>Traffic Counters</b> <ul style="list-style-type: none"> <li>Continuous (CTC)</li> <li>Weight-In-Motion (WIM)</li> <li>Short-Term, Scheduled</li> <li>Short-Term, Unscheduled</li> </ul>	<b>Crash Locations</b> <ul style="list-style-type: none"> <li>Fatal</li> <li>Injury</li> <li>Property Damage Only</li> <li>Unknown Crash Type</li> </ul>	<b>Mileage by Functional Class By Sheet</b> 0169 5 - Major Collector 1.790 <b>Page Total Mileage: 1.790 mi</b>	<b>Mileage by Town By Sheet</b> ORANGE - V110-0908 1.79 of 1.79 <b>Page Total Mileage: 1.79 mi</b>	<b>DISTRICT</b> 6	<b>TOWN</b> ORANGE	<b>Date:</b> 10/03/22	<b>ROUTE</b> VT-110 ETE mileage: 24.239 to 26.029
--	---	--	---	---	---	--	--	----------------------	-----------------------	-----------------------	---

For More Information Contact - Vermont Agency of Transportation, Policy, Planning and Intermodal Development Division - Mapping Section, 219 North Main Street, Barre, VT 05641 Telephone: 802-828-2600.