



Route Log and Progress Chart

DRAFT

Please Note: Errors and Omissions May Exist.
Contact the VTrans Mapping Section with questions or concerns.

DISTRICT	TOWN	ROUTE
1	WOODFORD	VT-9

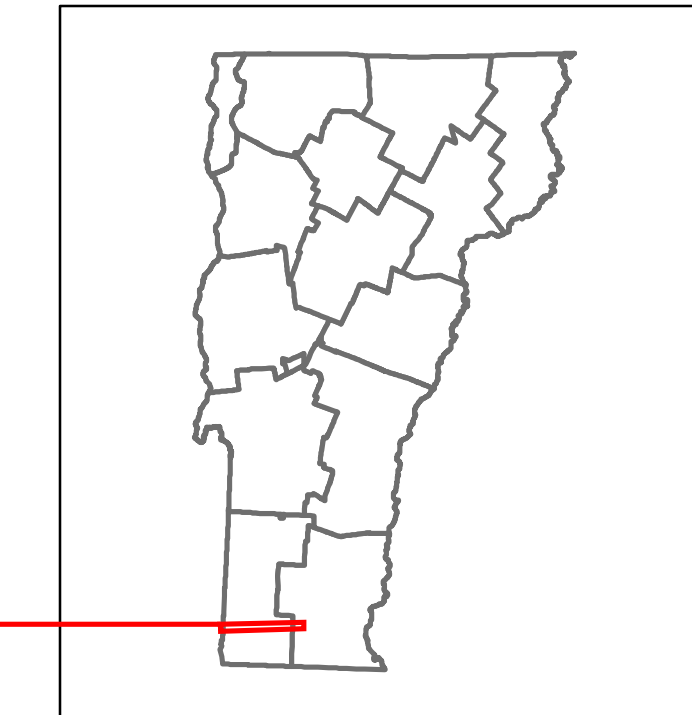

Base Map

1 in = 0.9 miles

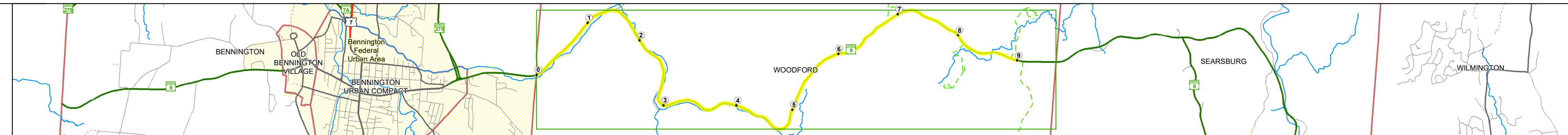

Stick Diagram

- Town Center
- Intersecting State Routes (excl. ramps/approaches)
- Other Intersecting Highways, Ramps, Approaches
- Railroad Crossings
- Primary Structures
- Secondary Structures
- Divided State Highway
- State Highway
- Divided Town Highway
- Town Highway
- Streams (Hydraulic Structure)
- Town Boundary
- Village/C Boundaries
- District Boundaries
- State/Town Highway Change
- Divided Highway Limits
- Ghost Section Boundary
- Federal Urban Area Limits

Scale: 1 INCH = 2,000 FEET

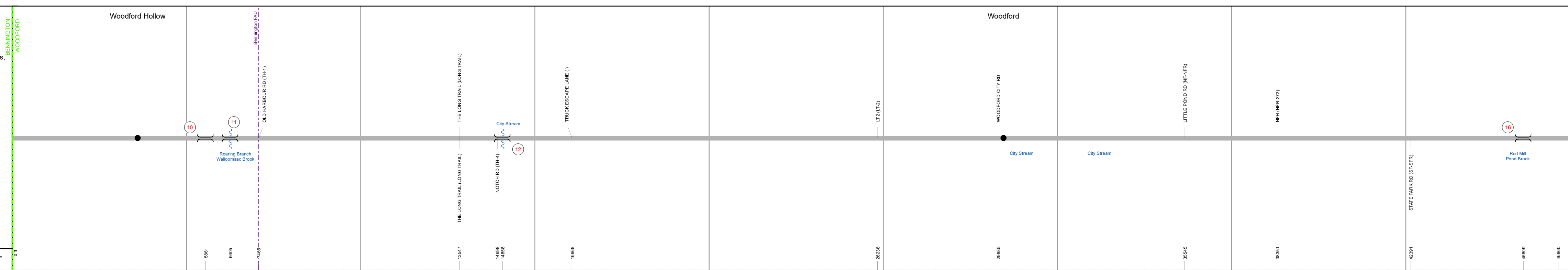

STRUCTURE DESCRIPTIONS

- Bridge 10:**
Slab - 1925
Structure No. 300010001002171
Length: 10'
Facility Carried: VT09
Structure Type: CONCRETE SLAB
Features Intersected: RELIEF STRUCTURE
Surface: Bituminous
Maintenance/Ownership: State
- Bridge 11:**
Stringer/multi-beam or girder - 2007
Structure No. 200010001102172
Length: 279'
Height: 5.33'
Width: 4.3'
Facility Carried: VT 09 ML
Structure Type: 3 SP CONT PLT GIRDER
Features Intersected: ROARING BRANCH
Surface: Bituminous
Maintenance/Ownership: State
- Bridge 12:**
Stringer/multi-beam or girder - 1959
Structure No. 200010001202172
Length: 237'
Height: 5.33'
Width: 4.3'
Facility Carried: VT 09 ML
Structure Type: 3 SPAN ROLLED BEAM
Features Intersected: CITY STREAM
Surface: Bituminous
Maintenance/Ownership: State
- Bridge 16:**
Culvert - 1932
Structure No. 300010001602171
Length: 13'
Facility Carried: VT09
Structure Type: RC BOX
Features Intersected: RED MILL POND OUTLET
Maintenance/Ownership: State

Road Widths	Travellane	Roadway	Lane Count	Base	Subbase
	37	38	37	26	27

Curves	5.8	5.4	6	3	3.5	7.5	3.9	1.5	4.5	7.3	5	0	8	6	6	6	6	6	7	5	7	3	3	4	6	3	6	5.3	3
--------	-----	-----	---	---	-----	-----	-----	-----	-----	-----	---	---	---	---	---	---	---	---	---	---	---	---	---	---	---	---	---	-----	---

Grades	+3.0A	+3.8	+4.2	+8.0	+6.3	+8.0	+7.6	+4.5	+7.1	+5.0	+7.0	+7.0	+4.4	+7.0															
--------	-------	------	------	------	------	------	------	------	------	------	------	------	------	------	--	--	--	--	--	--	--	--	--	--	--	--	--	--	--

Guardrails																													
------------	--	--	--	--	--	--	--	--	--	--	--	--	--	--	--	--	--	--	--	--	--	--	--	--	--	--	--	--	--

Rumblestrips																													
--------------	--	--	--	--	--	--	--	--	--	--	--	--	--	--	--	--	--	--	--	--	--	--	--	--	--	--	--	--	--

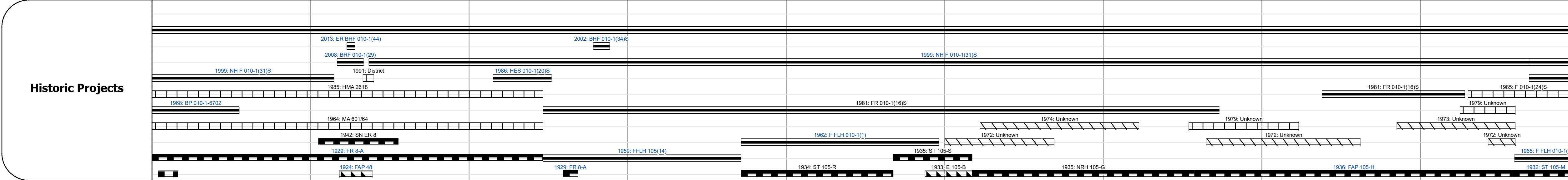

Maintenance Garage	District 1 - DMF Maintenance Bennington Garage
--------------------	--

Speed Zone	20
------------	----

Functional Class	3
------------------	---

National Highway System	NHS - Other NHS Routes
-------------------------	------------------------

Limited Access Highway	
------------------------	--

Customer Service Level	Arterial Highway
------------------------	------------------

Traffic Counters	B140, B129
------------------	------------

AADT	2021: 4607, 3941, 4312 2020: 3951, 3478, 3806 2019: 4801, 4106, 4494 2018: 4800, 4100, 4500 2017: 4600, 4100, 4200
------	--

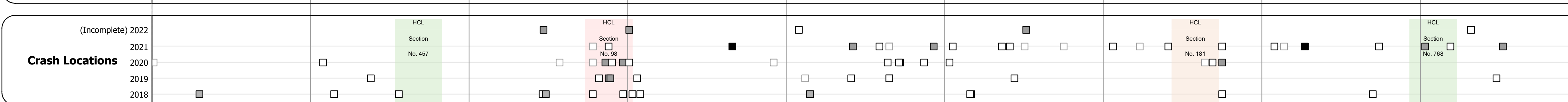

<p>Historic Projects</p> <ul style="list-style-type: none"> Unknown Retreatment Resurface Bituminous Mix Skinny Mix Bituminous Seal 	<p>Functional Class</p> <ul style="list-style-type: none"> 1 - Interstate System 2 - Other Freeways and Expressways 3 - Principal Arterial 4 - Minor Arterial 5 - Major Collector 6 - Minor Collector 	<p>Curves</p> <ul style="list-style-type: none"> Left (degree) Right (degree) 	<p>Grades</p> <ul style="list-style-type: none"> grade up (percent) grade down (percent) 	<p>Traffic Counters</p> <ul style="list-style-type: none"> Continuous (CTC) Weight-In-Motion (WIM) Short-Term, Scheduled Short-Term, Unscheduled 	<p>Crash Locations</p> <ul style="list-style-type: none"> Fatal Injury Property Damage Only Unknown Crash Type 	<p>Mileage by Functional Class By Sheet</p> <p>010-1 3 - Other Principal Arterial 9.000</p>	<p>Mileage by Town By Sheet</p> <p>WOODFORD - V009-0217 9.0 of 9.575</p>	<p>DISTRICT</p> <p>1</p>	<p>TOWN</p> <p>WOODFORD</p>	<p>Date: 10/03/22</p>	<p>ROUTE</p> <p>VT-9</p> <p>ETE mileage: 6.869 to 15.869</p>
--	--	--	---	---	---	--	---	---------------------------------	------------------------------------	------------------------------	---