



# Route Log and Progress Chart

**DRAFT**

Please Note: Errors and Omissions May Exist.  
Contact the VTrans Mapping Section with questions or concerns.

DISTRICT	TOWN	ROUTE
8	SAINT ALBANS TOWN	Min-8204

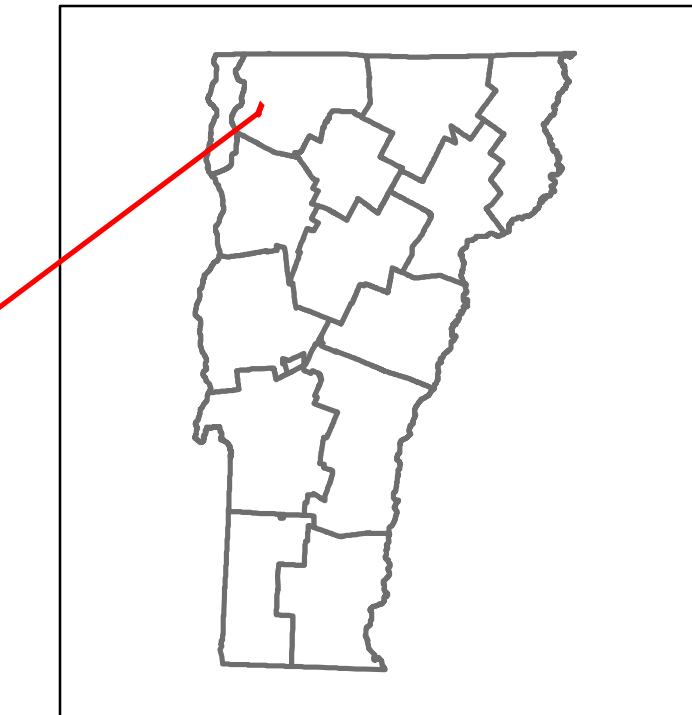

Min-8204

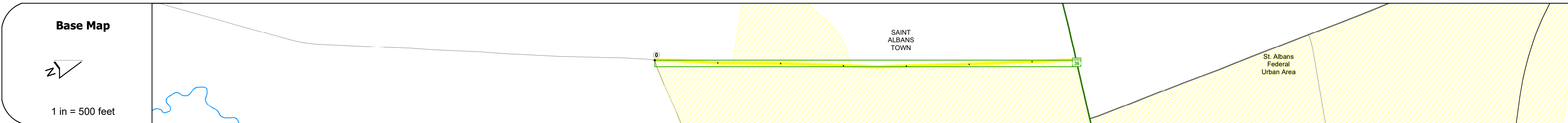

## STRUCTURE DESCRIPTIONS

Road Widths	Travellane	Roadway	Lane Count	Base	Subbase
	20	20	2		

Curves

Grades

Guardrails

Rumblestrips

Historic Projects

Maintenance Garage

Speed Zone

Functional Class
4

National Highway System

Limited Access Highway

Customer Service Level

Traffic Counters
F204

AADT	2021	2020	2019	2018	2017
	1278	1140	1385	1500	1500

Crash Locations	(Incomplete) 2022	2021	2020	2019	2018
				□ □	

<b>Historic Projects</b> Unknown, Retreatment, Resurface, Bituminous Mix, Skiny Mix, Bituminous Seal Bituminous Concrete, Cold Plane and Bituminous Concrete, Concrete, Gravel, Plant Mix, Reclaimed Base and Bituminous Concrete	<b>Functional Class</b> 1 - Interstate System, 2 - Other Freeways and Expressways, 3 - Principal Arterial, 4 - Minor Arterial, 5 - Major Collector, 6 - Minor Collector	<b>Curves</b> Left (degrees), Right (degrees) <b>Grades</b> (percent) grade up, (percent) grade down <b>Road Widths</b> (ft)	<b>Traffic Counters</b> Continuous (CTC), Weigh-In-Motion (WIM), Short-Term, Scheduled, Short-Term, Unscheduled <b>Crash Locations</b> Fatal, Injury, Property Damage Only, Unknown Crash Type <b>High Crash Locations (HCL's)</b> Sections (& Intersections) HCL No. 1-100 (1-10), 101-200 (11-20), 201-300 (21-30), 301-400 (31-40), 401-800 (41-113)	<b>Mileage by Functional Class By Sheet</b> 8204 4 - minor Arterial 0.670	<b>Mileage by Town By Sheet</b> SAINT ALBANS TOWN - S82040613 0.67 of 0.67	<b>DISTRICT</b> 8	<b>TOWN</b> SAINT ALBANS TOWN	<b>Date:</b> 10/04/22	<b>ROUTE</b> Min-8204 ETE mileage: 0.0 to 0.67
				<b>Page Total Mileage: 0.670 mi</b>		<b>Page Total Mileage: 0.67 mi</b>		<b>1 of 1</b> TWN mileage: 0.0 to 0.67	

For More Information Contact - Vermont Agency of Transportation, Policy, Planning and Intermodal Development Division - Mapping Section, 219 North Main Street, Barre, VT 05641 Telephone: 802-828-2600.