



Route Log and Progress Chart

DRAFT

Please Note: Errors and Omissions May Exist.
Contact the VTrans Mapping Section with questions or concerns.

DISTRICT	TOWN	ROUTE
3	PROCTOR	Urb-3814

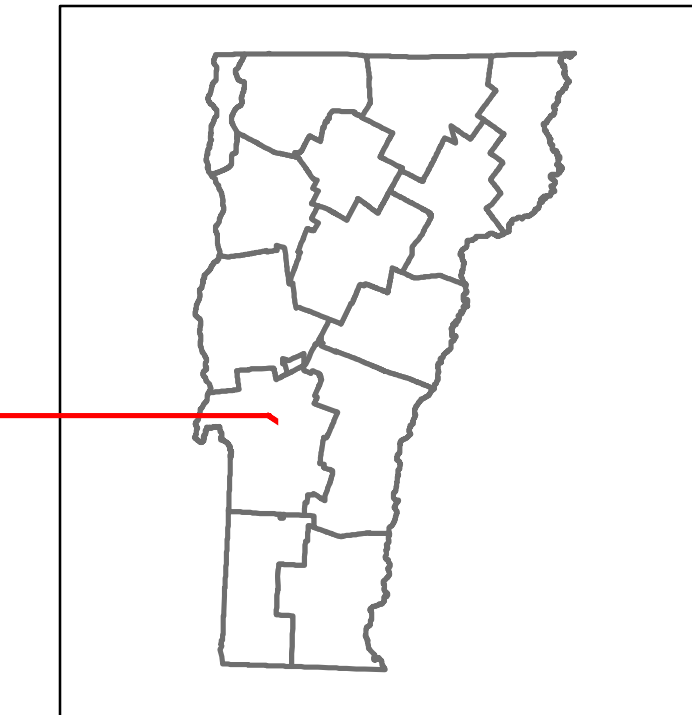

Urb-3814

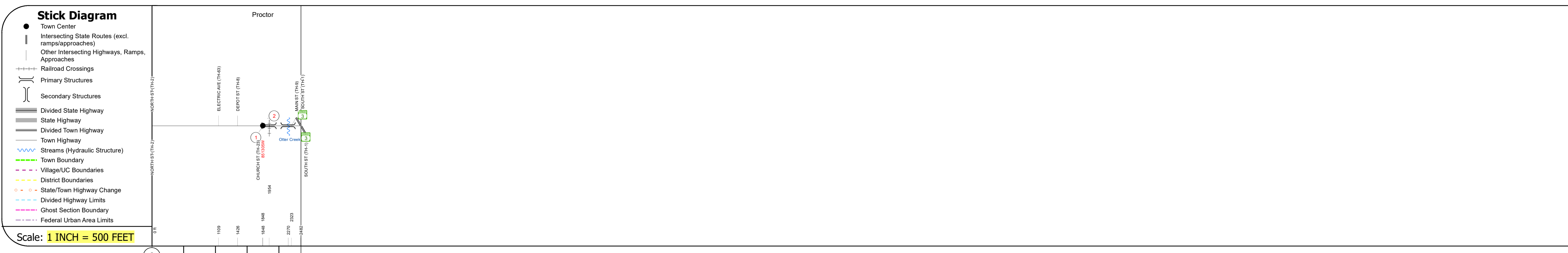

STRUCTURE DESCRIPTIONS

Bridge 1:
Stringer/multi-beam or girder - 1920
Structure No: 200155000111182
Length: 36'
Height: 5.33'
Width: 3.6'
Under Clearance: 1.58'
Facility Carried: TR 03 FAS 155
Structure Type: CONC ENCASED GIRDER
Features Intersected: VERMONT RAILWAY
Surface: Bituminous
Maintenance/Ownership: State

Bridge 2:
Culvert (Arch) - 1915
Structure No: 200155000211182
Length: 164'
Height: 5.33'
Width: 3.6'
Facility Carried: TR 03 FAS 155
Structure Type: CLOSED SPN CONC ARCH
Features Intersected: OTTER CREEK
3
Surface: Bituminous
Maintenance/Ownership: Town

Road Widths	Travellane: 36, 38, 44, 38, 36, 26, 24, 22 Roadway: 36, 38, 44, 38, 36, 26, 24, 22 Lane Count: 2 Base Subbase
-------------	---

Curves	9.6, 16.5, 11.6, 19.4
--------	-----------------------

Grades	
--------	--

Guardrails	
------------	--

Rumblestrips	
--------------	--

Historic Projects	1976: RS 0155(3) SA, 2003: BHF 0155(5)
-------------------	--

Maintenance Garage	
--------------------	--

Speed Zone	
------------	--

Functional Class	4
------------------	---

National Highway System	
-------------------------	--

Limited Access Highway	
------------------------	--

Customer Service Level	
------------------------	--

Traffic Counters	
------------------	--

AADT	2021: 1012, 1550 2020: 903, 1383 2019: 1097, 1681 2018: 1400, 2100 2017: 1400, 2100
------	---

Crash Locations	(Incomplete) 2022, 2021, 2020, 2019, 2018
-----------------	---

Historic Projects Unknown, Bituminous Concrete, Retreatment, Bituminous Macadam, Resurface, Cold Plane and Bituminous Concrete, Bituminous Mix, Concrete, Bituminous Seal, Gravel, Surface Treated Gravel, Plant Mix, Reclaimed Base and Bituminous Concrete	Functional Class 1 - Interstate System, 2 - Other Freeways and Expressways, 3 - Principal Arterial, 4 - Minor Arterial, 5 - Major Collector, 6 - Minor Collector	Curves Left, Right, Grades (degrees), Left, Right, grade up, grade down	Traffic Counters Continuous (CTC), Weigh-In-Motion (WIM), Short-Term, Scheduled, Short-Term, Unscheduled (counter ID)	Crash Locations Fatal, Injury, Property Damage Only, Unknown Crash Type, High Crash Locations (HCL's)	Mileage by Functional Class By Sheet 3814 4 - minor Arterial 0.470	Mileage by Town By Sheet PROCTOR - S38141118 0.47 of 0.47	DISTRICT 3	TOWN PROCTOR	Date: 10/03/22	ROUTE Urb-3814
Page Total Mileage: 0.470 mi						Page Total Mileage: 0.47 mi				
1 of 1 TWN mileage: 0.0 to 0.47									ETE mileage: 0.0 to 0.47	

For More Information Contact - Vermont Agency of Transportation, Policy, Planning and Intermodal Development Division - Mapping Section, 219 North Main Street, Barre, VT 05641 Telephone: 802-828-2600.