



# Route Log and Progress Chart

**DRAFT**

Please Note: Errors and Omissions May Exist.  
Contact the VTrans Mapping Section with questions or concerns.

DISTRICT	TOWN	ROUTE
8	SAINT ALBANS TOWN	Min-0787

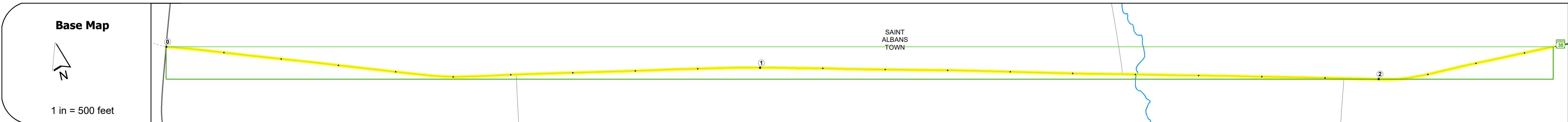
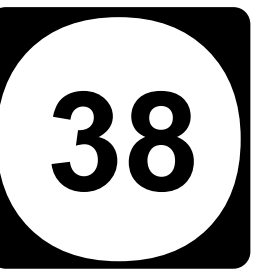
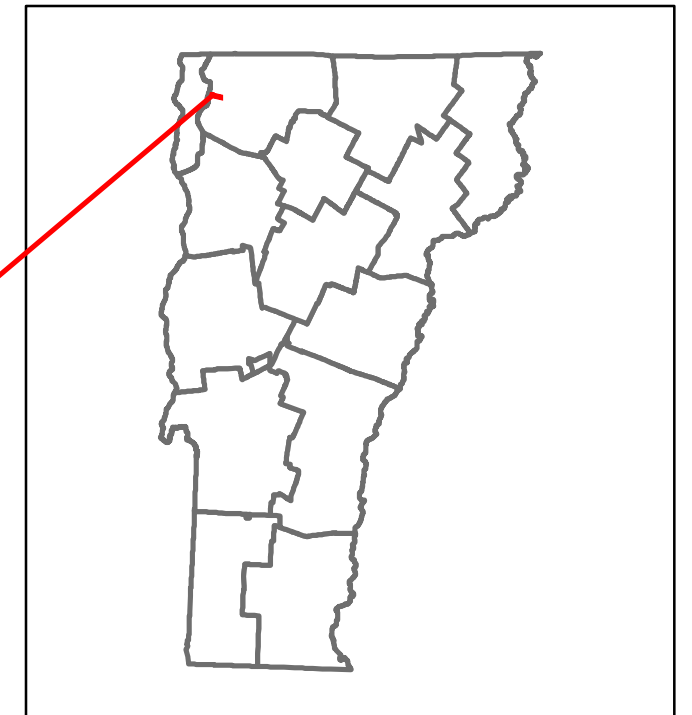

<b>Road Widths</b>	Travellane	22	24	
Roadway	22	24		
Lane Count		2		
Base				
Subbase				
<b>Curves</b>				
<b>Grades</b>				
<b>Guardrails</b>				
<b>Rumblestrips</b>				
<b>Historic Projects</b>				
<b>Maintenance Garage</b>				
<b>Speed Zone</b>				
<b>Functional Class</b>	6			
<b>National Highway System</b>				
<b>Limited Access Highway</b>				
<b>Customer Service Level</b>				
<b>Traffic Counters</b>				
<b>AADT</b>	2021			
	2020			
	2019			
	2018			
	2017			
<b>Crash Locations</b>	(Incomplete) 2022			
	2021			
	2020			
	2019			
	2018			

STRUCTURE DESCRIPTIONS	

<b>Historic Projects</b> Unknown, Retreatment, Resurface, Bituminous Mix, Skiny Mix, Bituminous Seal Bituminous Concrete, Cold Plane and Bituminous Concrete, Concrete, Gravel, Plant Mix, Reclaimed Base and Bituminous Concrete, Surface Treated Gravel	<b>Functional Class</b> 1- Interstate System, 2- Other Freeways and Expressways, 3- Principal Arterial, 4- Minor Arterial, 5- Major Collector, 6- Minor Collector	<b>Curves</b> Left (degrees), Right (degrees) <b>Grades</b> (percent) grade up, (percent) grade down <b>Road Widths</b> (ft)	<b>Traffic Counters</b> Continuous (CTC), Weigh-In-Motion (WIM), Short-Term, Scheduled, Short-Term, Unscheduled (counter ID) <b>Crash Locations</b> Fatal, Injury, Property Damage Only, Unknown Crash Type <b>High Crash Locations (HCL's)</b> Sections (& Intersections) HCL No. 201 - 300 (21 - 30), 301 - 400 (31 - 40), 401 - 800 (41 - 113)	<b>Mileage by Functional Class By Sheet</b> 0787 6 - minor collector 2.360	<b>Mileage by Town By Sheet</b> SAINT ALBANS TOWN - S07870613 2.36 of 2.36	<b>DISTRICT</b> 8	<b>TOWN</b> SAINT ALBANS TOWN	<b>Date:</b> 10/03/22	<b>ROUTE</b> Min-0787 ETE mileage: 0.0 to 2.36
				<b>Page Total Mileage: 2.360 mi</b>		<b>Page Total Mileage: 2.36 mi</b>		<b>1 of 1</b> TWN mileage: 0.0 to 2.36	

For More Information Contact - Vermont Agency of Transportation, Policy, Planning and Intermodal Development Division - Mapping Section, 219 North Main Street, Barre, VT 05641 Telephone: 802-828-2600.