



Route Log and Progress Chart

DRAFT

Please Note: Errors and Omissions May Exist.
Contact the VTrans Mapping Section with questions or concerns.

DISTRICT	TOWN	ROUTE
7	STANNARD	Min-0750

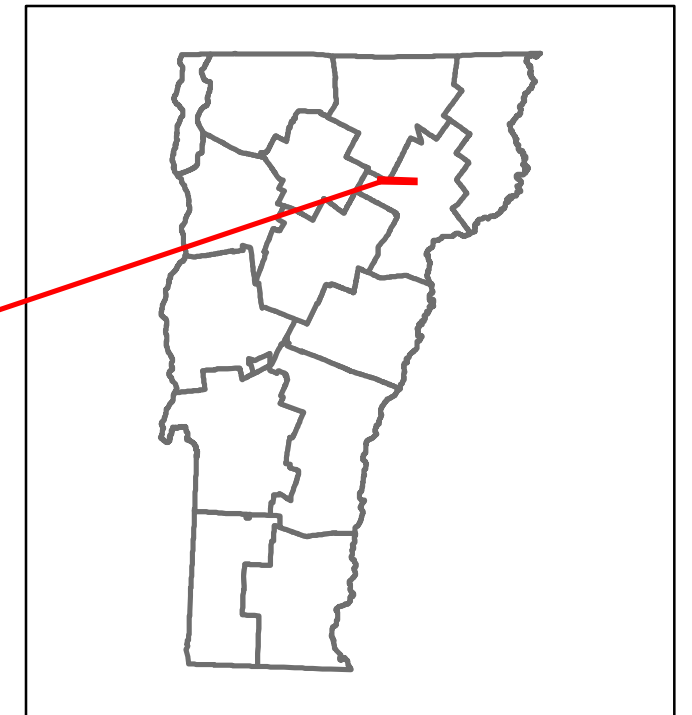

Min-0750

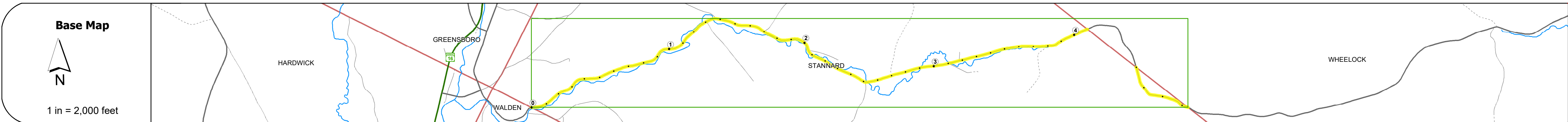

Stick Diagram

- Town Center
- Intersecting State Routes (excl. ramps/approaches)
- Other Intersecting Highways, Ramps, Approaches
- Railroad Crossings
- Primary Structures
- Secondary Structures
- Divided State Highway
- State Highway
- Divided Town Highway
- Town Highway
- Streams (Hydraulic Structure)
- Town Boundary
- Village/IC Boundaries
- District Boundaries
- State/Town Highway Change
- Divided Highway Limits
- Ghost Section Boundary
- Federal Urban Area Limits

Scale: **1 INCH = 2,000 FEET**

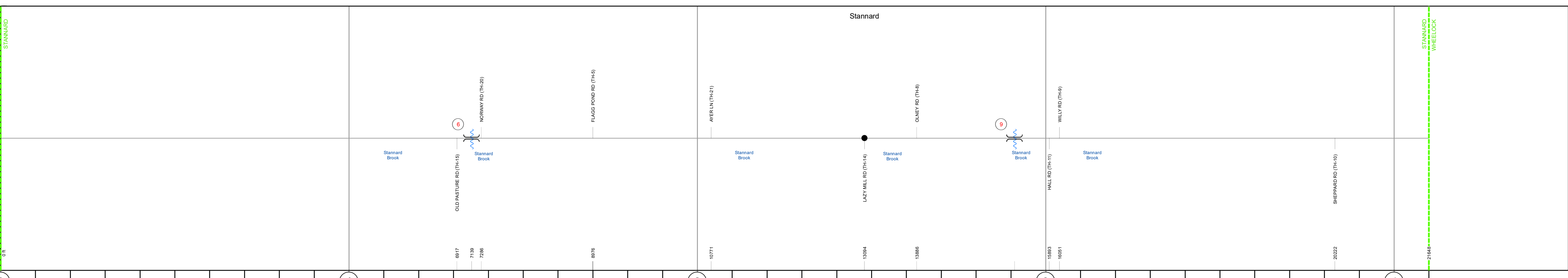

STRUCTURE DESCRIPTIONS

Bridge 6:
Slab - 2001
Structure No. 100313000603131
Length: 23'
Height: 5.33'
Width: 2.4'
Facility Carried: C2001
Structure Type: CONCRETE SLAB
Features Intersected: STANNARD BROOK
Maintenance/Ownership: Town

Bridge 9:
Culvert - 2012
Structure No. 100313000903131
Length: 24'
Height: 5.33'
Width: 1.8'
Facility Carried: C2001
Structure Type: PC SEG FRAME CULVERT
Features Intersected: STANNARD BROOK
Maintenance/Ownership: Town

Road Widths	Travellane	20
	Roadway	22
	Lane Count	2
	Base	
	Subbase	
Curves		12
Grades		
Guardrails		
Rumblestrips		
Historic Projects		2002 THZ 8919
Maintenance Garage		
Speed Zone		
Functional Class		6
National Highway System		
Limited Access Highway		
Customer Service Level		
Traffic Counters		
AADT	2021	
	2020	
	2019	
	2018	
	2017	
Crash Locations	(Incomplete) 2022	
	2021	
	2020	
	2019	
	2018	

<p>Historic Projects</p> <ul style="list-style-type: none"> Unknown Retreatment Resurface Bituminous Mix Skippy Mix Bituminous Seal 	<p>Functional Class</p> <ul style="list-style-type: none"> 1 - Interstate System 2 - Other Freeways and Expressways 3 - Principal Arterial 4 - Minor Arterial 5 - Major Collector 6 - Minor Collector 	<p>Crash Locations</p> <ul style="list-style-type: none"> Fatal Injury Property Damage Only Unknown Crash Type <p>High Crash Locations (HCL's)</p> <p>HCL No. 201 - 300 (21 - 30)</p> <p>1 - 100 (1 - 10) 301 - 400 (31 - 40)</p> <p>101 - 200 (11 - 20) 401 - 800 (41 - 113)</p>	<p>Mileage by Functional Class By Sheet</p> <p>0750 6 - minor collector 4.430</p>	<p>Mileage by Town By Sheet</p> <p>STANNARD - S07500313 4.43 of 4.43</p>	<p>DISTRICT</p> <p>7</p>	<p>TOWN</p> <p>STANNARD</p>	<p>Date: 10/03/22</p>	<p>ROUTE</p> <p>Min-0750</p> <p>ETE mileage: 0.77 to 4.87 5.39 to 5.72</p>
--	--	---	--	---	---------------------------------	------------------------------------	------------------------------	---

For More Information Contact - Vermont Agency of Transportation, Policy, Planning and Intermodal Development Division - Mapping Section, 219 North Main Street, Barre, VT 05641 Telephone: 802-828-2600.