



# Route Log and Progress Chart

**DRAFT**

Please Note: Errors and Omissions May Exist.  
Contact the VTrans Mapping Section with questions or concerns.

DISTRICT	TOWN	ROUTE
6	MIDDLESEX	Min-0716

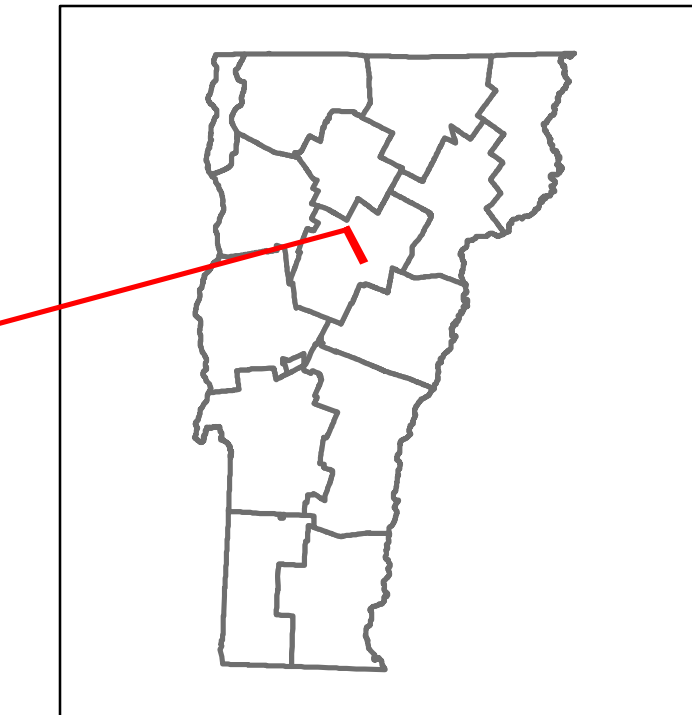

Min-0716

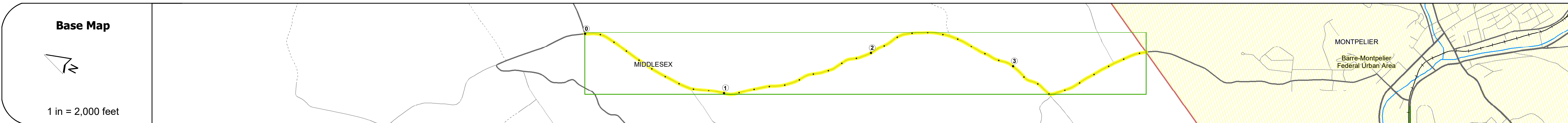

**Stick Diagram**

- Town Center
- Intersecting State Routes (excl. ramps/approaches)
- Other Intersecting Highways, Ramps, Approaches
- Railroad Crossings
- Primary Structures
- Secondary Structures
- Divided State Highway
- State Highway
- Divided Town Highway
- Town Highway
- Streams (Hydraulic Structure)
- Town Boundary
- Village/IC Boundaries
- District Boundaries
- State/Town Highway Change
- Divided Highway Limits
- Ghost Section Boundary
- Federal Urban Area Limits

Scale: 1 INCH = 2,000 FEET

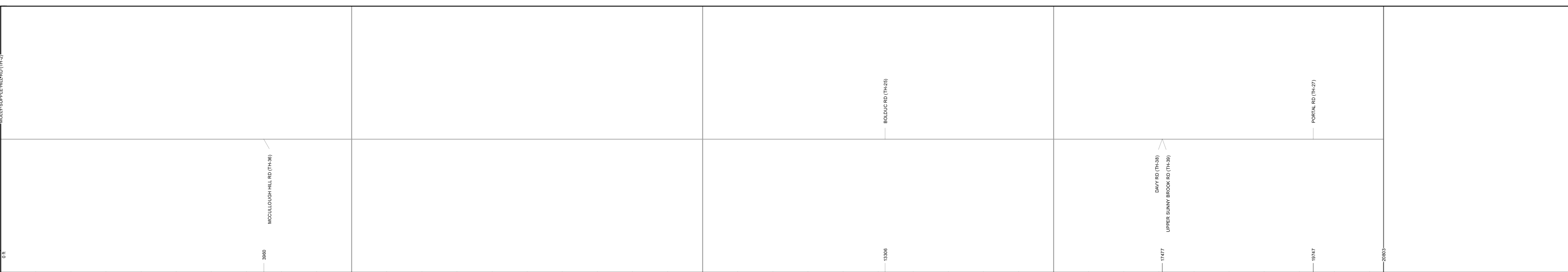

**STRUCTURE DESCRIPTIONS**

<b>Road Widths</b>	Travellane	22							
	Roadway	24							
	Lane Count	2							
	Base								
	Subbase								
<b>Curves</b>									
<b>Grades</b>									
<b>Guardrails</b>									
<b>Rumblestrips</b>									
<b>Historic Projects</b>									
<b>Maintenance Garage</b>									
<b>Speed Zone</b>									
<b>Functional Class</b>			6						
<b>National Highway System</b>									
<b>Limited Access Highway</b>									
<b>Customer Service Level</b>									
<b>Traffic Counters</b>									
<b>AAADT</b>	2021								
	2020								
	2019								
	2018								
	2017								
<b>Crash Locations</b>	(Incomplete) 2022								
	2021								
	2020								
	2019								
	2018								

<b>Historic Projects</b> Unknown, Retreatment, Resurface, Bituminous Mix, Skiny Mix, Bituminous Seal Bituminous Concrete, Gravel, Cold Plane and Bituminous Concrete, Reclaimed Base and Bituminous Concrete, Concrete, Gravel	<b>Functional Class</b> 1- Interstate System, 2- Other Freeways and Expressways, 3- Principal Arterial, 4- Minor Arterial, 5- Major Collector, 6- Minor Collector	<b>Curves</b> Left (degrees), Right (degrees) <b>Grades</b> (percent) grade up, (percent) grade down <b>Road Widths</b> (ft)	<b>Traffic Counters</b> Continuous (CTC), Weigh-In-Motion (WIM), Short-Term, Scheduled, Short-Term, Unscheduled (counter ID) <b>AAADT</b> (AADT)	<b>Crash Locations</b> Fatal, Injury, Property Damage Only, Unknown Crash Type <b>High Crash Locations (HCL's)</b> Sections (& Intersections) HCL No. 1-100 (1-10), 101-200 (11-20), 201-300 (21-30), 301-400 (31-40), 401-800 (41-113)	<b>Mileage by Functional Class By Sheet</b> 0716 6 - minor collector 3.940	<b>Mileage by Town By Sheet</b> MIDDLESEX - S07161210 3.94 of 3.94	<b>DISTRICT</b> 6	<b>TOWN</b> MIDDLESEX	Date: 10/03/22	<b>ROUTE</b> Min-0716 ETE mileage: 0.0 to 3.94
					<b>Page Total Mileage: 3.940 mi</b>	<b>Page Total Mileage: 3.94 mi</b>	<b>1 of 1</b> TWN mileage: 0.0 to 3.94			

For More Information Contact - Vermont Agency of Transportation, Policy, Planning and Intermodal Development Division - Mapping Section, 219 North Main Street, Barre, VT 05641 Telephone: 802-828-2600.