



Route Log and Progress Chart

DRAFT

Please Note: Errors and Omissions May Exist.
Contact the VTrans Mapping Section with questions or concerns.

DISTRICT	TOWN	ROUTE
2	LONDONDERRY	Min-0556

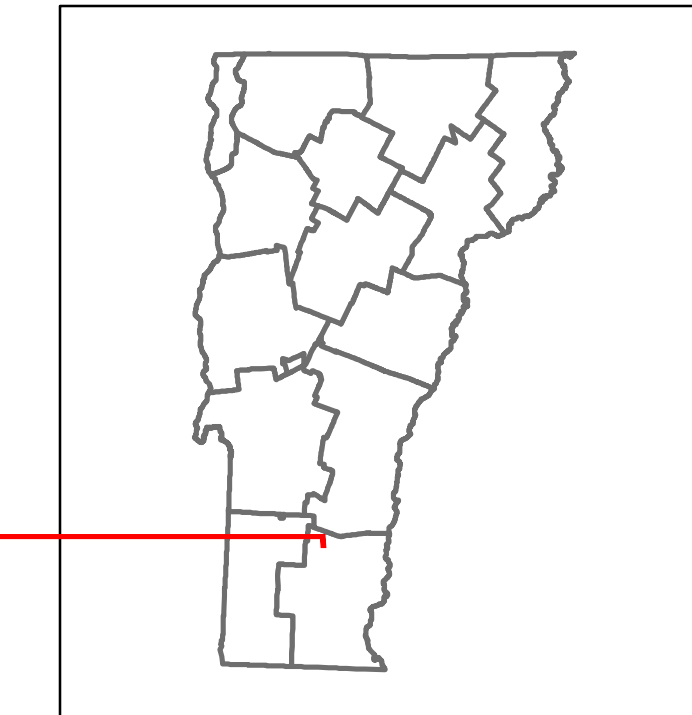

Min-0556

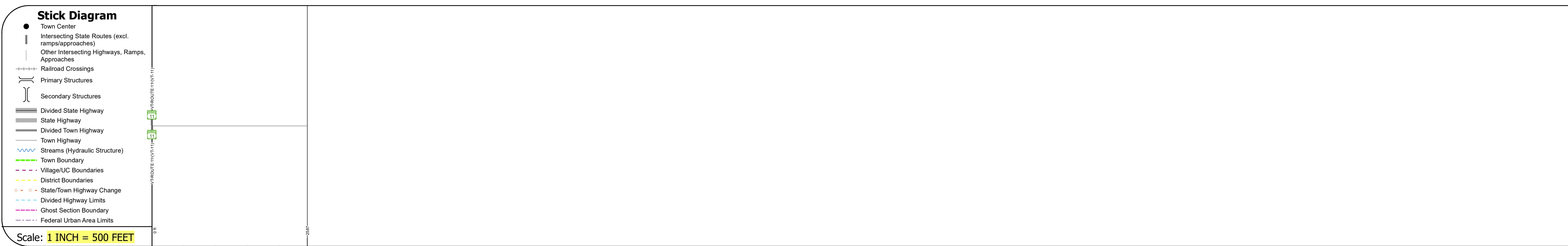
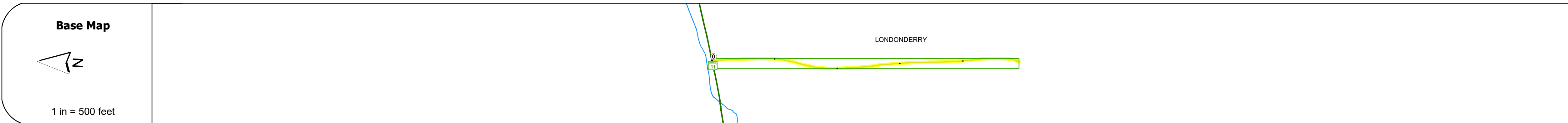

Road Widths	Travellane: 22
Roadway	22
Lane Count	2
Base	
Subbase	

Curves	
---------------	--

Grades	
---------------	--

Guardrails	
-------------------	--

Rumblestrips	
---------------------	--

Historic Projects	
--------------------------	--

Maintenance Garage	
---------------------------	--

Speed Zone	
-------------------	--

Functional Class	6
-------------------------	---

National Highway System	
--------------------------------	--

Limited Access Highway	
-------------------------------	--

Customer Service Level	
-------------------------------	--

Traffic Counters	
-------------------------	--

AADT	2021	
	2020	
	2019	
	2018	
	2017	

Crash Locations	(Incomplete) 2022	
	2021	
	2020	
	2019	
	2018	

STRUCTURE DESCRIPTIONS	

Historic Projects Unknown, Retreatment, Resurface, Bituminous Mix, Skiny Mix, Bituminous Seal, Bituminous Concrete, Cold Plane and Bituminous Concrete, Concrete, Gravel, Plant Mix, Reclaimed Base and Bituminous Concrete, Surface Treated Gravel	Functional Class 1- Interstate System, 2- Other Freeways and Expressways, 3- Principal Arterial, 4- Minor Arterial, 5- Major Collector, 6- Minor Collector	Curves Left (degrees), Right (degrees), Grades (percent) grade up, (percent) grade down	Traffic Counters Continuous (CTC), Weigh-In-Motion (WIM), Short-Term, Scheduled, Short-Term, Unscheduled (counter ID)	Crash Locations Fatal, Injury, Property Damage Only, Unknown Crash Type, High Crash Locations (HCL's) Sections (& Intersections)	Mileage by Functional Class By Sheet 0556 6 - minor collector 0.490	Mileage by Town By Sheet LONDONDERRY - S05561310 0.49 of 0.49	DISTRICT 2	TOWN LONDONDERRY	Date: 10/03/22	ROUTE Min-0556
					Page Total Mileage: 0.490 mi		Page Total Mileage: 0.49 mi		1 of 1 TWN mileage: 0.0 to 0.49	ETE mileage: 0.0 to 0.49

For More Information Contact - Vermont Agency of Transportation, Policy, Planning and Intermodal Development Division - Mapping Section, 219 North Main Street, Barre, VT 05641 Telephone: 802-828-2600.