



# Route Log and Progress Chart

**DRAFT**

Please Note: Errors and Omissions May Exist.  
Contact the VTrans Mapping Section with questions or concerns.

| DISTRICT | TOWN     | ROUTE    |
|----------|----------|----------|
| 2        | GUILFORD | Min-0508 |

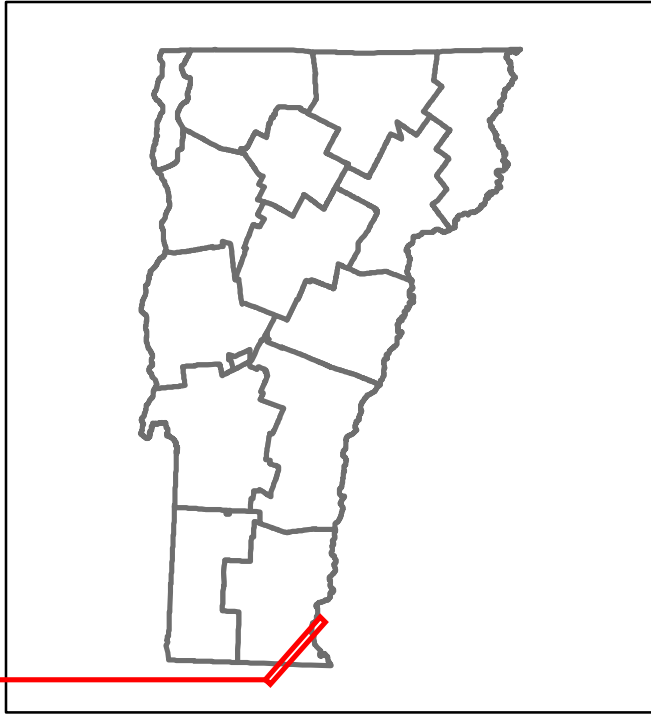

Min-0508

**Base Map**

1 in = 0.9 miles

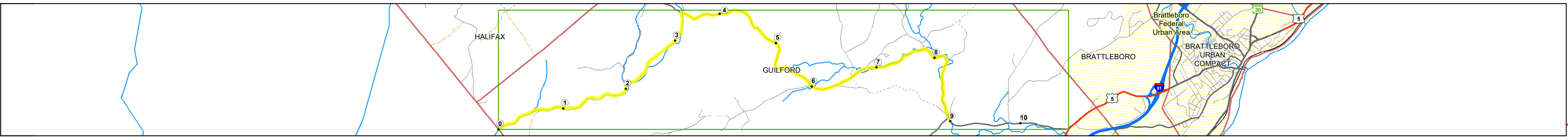

**Stick Diagram**

- Town Center
- Intersecting State Routes (excl. ramps/approaches)
- Other Intersecting Highways, Ramps, Approaches
- Railroad Crossings
- Primary Structures
- Secondary Structures
- Divided State Highway
- State Highway
- Divided Town Highway
- Town Highway
- Streams (Hydraulic Structure)
- Town Boundary
- Village/UC Boundaries
- District Boundaries
- State/Town Highway Change
- Divided Highway Limits
- Ghost Section Boundary
- Federal Urban Area Limits

Scale: 1 INCH = 2,000 FEET

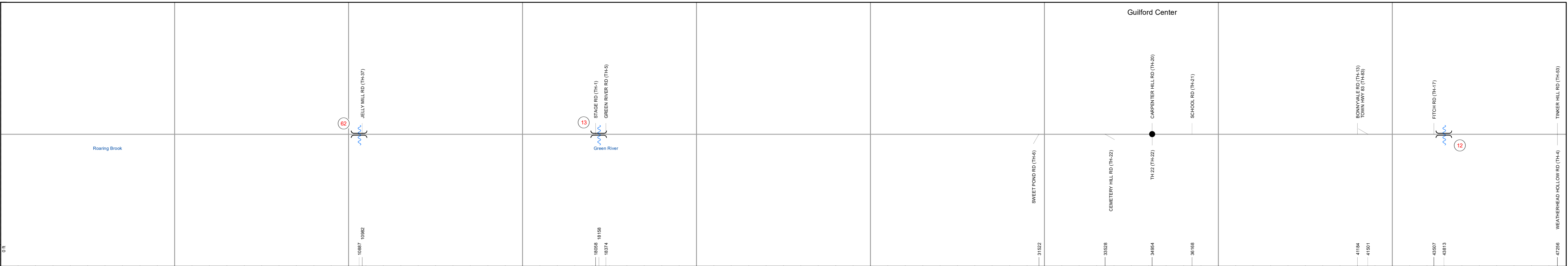

### STRUCTURE DESCRIPTIONS

- Bridge 62:**  
Stringer/multi-beam or girder - 1939  
Structure No. 101307006213071  
Length: 50'  
Height: 5.33'  
Width: 2.4'  
Facility Carried: C3007  
Structure Type: ROLLED BEAM  
Features Intersected: ROARING BROOK  
Maintenance/Ownership: Town
- Bridge 13:**  
Truss - thru - 1870  
Structure No. 101307001313071  
Length: 107'  
Width: 1.2'  
Weight Limit: 8  
Facility Carried: C2001  
Structure Type: TOWN LATTICE COV BR  
Features Intersected: GREEN RIVER  
1  
Surface: Timber  
Maintenance/Ownership: Town
- Bridge 12:**  
Stringer/multi-beam or girder - 1939  
Structure No. 101307001213071  
Length: 90'  
Height: 5.33'  
Width: 2.1'  
Facility Carried: C2001  
Structure Type: ROLLED BEAM  
Features Intersected: BROAD BROOK  
Surface: Bituminous  
Maintenance/Ownership: Town

|                                | 0 | 1 | 2 | 3 | 4 | 5 | 6 | 7 | 8 | 9 |
|--------------------------------|---|---|---|---|---|---|---|---|---|---|
| <b>Road Widths</b>             |   |   |   |   |   |   |   |   |   |   |
| Travellane                     |   |   |   |   |   |   |   |   |   |   |
| Roadway                        |   |   |   |   |   |   |   |   |   |   |
| Lane Count                     |   |   |   |   |   |   |   |   |   |   |
| Base                           |   |   |   |   |   |   |   |   |   |   |
| Subbase                        |   |   |   |   |   |   |   |   |   |   |
| <b>Curves</b>                  |   |   |   |   |   |   |   |   |   |   |
| <b>Grades</b>                  |   |   |   |   |   |   |   |   |   |   |
| <b>Guardrails</b>              |   |   |   |   |   |   |   |   |   |   |
| <b>Rumblestrips</b>            |   |   |   |   |   |   |   |   |   |   |
| <b>Historic Projects</b>       |   |   |   |   |   |   |   |   |   |   |
| <b>Maintenance Garage</b>      |   |   |   |   |   |   |   |   |   |   |
| <b>Speed Zone</b>              |   |   |   |   |   |   |   |   |   |   |
| <b>Functional Class</b>        |   |   |   |   | 6 |   |   |   |   |   |
| <b>National Highway System</b> |   |   |   |   |   |   |   |   |   |   |
| <b>Limited Access Highway</b>  |   |   |   |   |   |   |   |   |   |   |
| <b>Customer Service Level</b>  |   |   |   |   |   |   |   |   |   |   |
| <b>Traffic Counters</b>        |   |   |   |   |   |   |   |   |   |   |
| <b>AADT</b>                    |   |   |   |   |   |   |   |   |   |   |
| 2021                           |   |   |   |   |   |   |   |   |   |   |
| 2020                           |   |   |   |   |   |   |   |   |   |   |
| 2019                           |   |   |   |   |   |   |   |   |   |   |
| 2018                           |   |   |   |   |   |   |   |   |   |   |
| 2017                           |   |   |   |   |   |   |   |   |   |   |
| <b>Crash Locations</b>         |   |   |   |   |   |   |   |   |   |   |
| (Incomplete) 2022              |   |   |   |   |   |   |   |   |   |   |
| 2021                           |   |   |   |   |   |   |   |   |   |   |
| 2020                           |   |   |   |   |   |   |   |   |   |   |
| 2019                           |   |   |   |   |   |   |   |   |   |   |
| 2018                           |   |   |   |   |   |   |   |   |   |   |

|   |  |  |  |   |  |   |  |   |  |   |  |  |  |                      |                         |                       |                          |
|---|--|--|--|---|--|---|--|---|--|---|--|--|--|----------------------|-------------------------|-----------------------|--------------------------|
| <b>Historic Projects</b><br>Unknown, Bituminous Concrete, Retreatment, Resurface, Bituminous Mix, Skiny Mix, Bituminous Seal, Surface Treated Gravel, Plant Mix, Reclaimed Base and Bituminous Concrete, Concrete |  | <b>Functional Class</b><br>1 - Interstate System, 2 - Other Freeways and Expressways, 3 - Principal Arterial, 4 - Minor Arterial, 5 - Major Collector, 6 - Minor Collector |  | <b>Curves</b><br>Left (degrees), Right (degrees), Grades (percent) grade up, (percent) grade down                           |  | <b>Traffic Counters</b><br>Continuous (CTC), Weigh-In-Motion (WIM), Short-Term, Scheduled (counter ID), Short-Term, Unscheduled |  | <b>Crash Locations</b><br>Fatal, Injury, Property Damage Only, Unknown Crash Type, High Crash Locations (HCL's) |  | <b>Mileage by Functional Class By Sheet</b><br>0508 6 - minor collector 9.000 |  | <b>Mileage by Town By Sheet</b><br>GUILFORD - S05081307 9.0 of 10.69 |  | <b>DISTRICT</b><br>2 | <b>TOWN</b><br>GUILFORD | <b>Date:</b> 10/02/22 | <b>ROUTE</b><br>Min-0508 |
| <b>Speed Zones</b><br>25, 30, 35, 40, 45, 50, 55, 60, 65  |  | <b>Road Widths</b><br>(ft)   |  | <b>Crash Locations (HCL's)</b><br>HCL No. 1-100 (1-10), 101-200 (11-20), 201-300 (21-30), 301-400 (31-40), 401-800 (41-113) |  | <b>Page Total Mileage:</b> 9.000 mi   |  | <b>Page Total Mileage:</b> 9.0 mi   |  | <b>1 of 2</b><br>TWN mileage: 0.0 to 9.0                                      |  | <b>ETE mileage:</b> 0.0 to 9.0                                       |  |                      |                         |                       |                          |

For More Information Contact - Vermont Agency of Transportation, Policy, Planning and Intermodal Development Division - Mapping Section, 219 North Main Street, Barre, VT 05641 Telephone: 802-828-2600.