



Route Log and Progress Chart

DRAFT

Please Note: Errors and Omissions May Exist.
Contact the VTrans Mapping Section with questions or concerns.

DISTRICT	TOWN	ROUTE
6	EAST MONTPELIER	Maj-0243

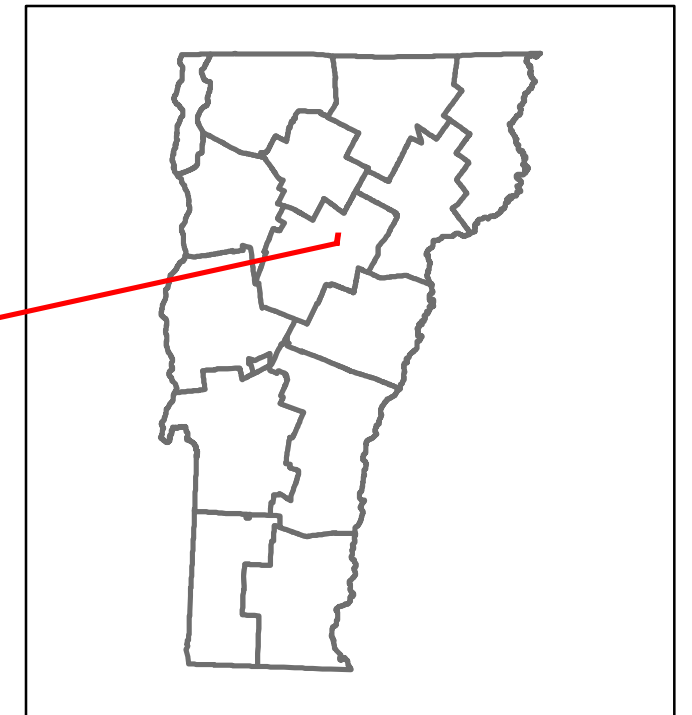

Maj-0243

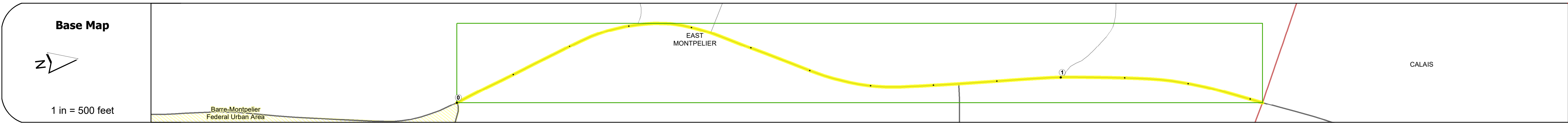

STRUCTURE DESCRIPTIONS

Road Widths	Travellane	Roadway	Lane Count	Base	Subbase
	22	28	2	27	18" - 18" Gravel

Curves	
---------------	--

Grades	
---------------	--

Guardrails	
-------------------	--

Rumblestrips	
---------------------	--

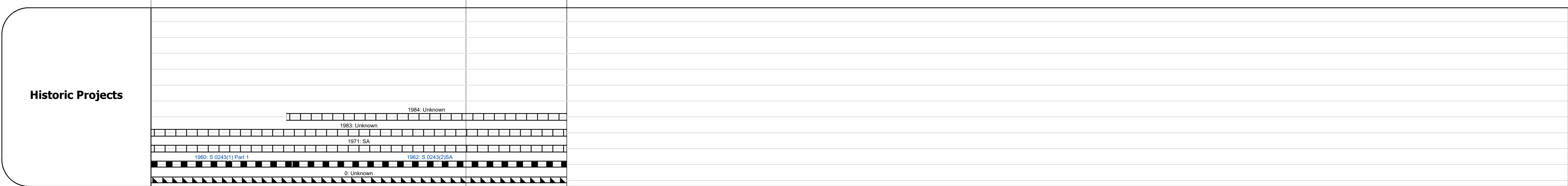

Maintenance Garage	
---------------------------	--

Speed Zone	
-------------------	--

Functional Class	5
-------------------------	---

National Highway System	
--------------------------------	--

Limited Access Highway	
-------------------------------	--

Customer Service Level	
-------------------------------	--

Traffic Counters	
-------------------------	--

Year	Left	Right
2021	1360	809
2020	1178	678
2019	1389	801
2018	1400	1200
2017	1400	1200

Year	Crash Locations
(Incomplete) 2022	
2021	
2020	
2019	
2018	

Historic Projects Legend for materials: Bituminous Concrete, Gravel, Surface Treated, etc.	Functional Class Legend for road types: 1-Interstate System, 3-Principal Arterial, 5-Major Collector, etc.	Curves Legend for curve types: Left, Right, grade up, grade down.	Grades Legend for grade types: Left, Right, grade up, grade down.	Traffic Counters Legend for counter types: Continuous (CTC), Weigh-In-Motion (WIM), etc.	Crash Locations Legend for crash types: Fatal, Injury, Property Damage Only, etc.	Mileage by Functional Class By Sheet 0243 5 - Major Collector 1.320	Mileage by Town By Sheet EAST MONTPELIER - S02431207 1.32 of 1.32	DISTRICT 6	TOWN EAST MONTPELIER	Date: 10/03/22	ROUTE Maj-0243
						Page Total Mileage: 1.320 mi	Page Total Mileage: 1.32 mi	1 of 1 TWN mileage: 0.0 to 1.32	ETE mileage: 0.0 to 1.32		

For More Information Contact - Vermont Agency of Transportation, Policy, Planning and Intermodal Development Division - Mapping Section, 219 North Main Street, Barre, VT 05641 Telephone: 802-828-2600.