



Route Log and Progress Chart

DRAFT

Please Note: Errors and Omissions May Exist.
Contact the VTrans Mapping Section with questions or concerns.

DISTRICT	TOWN	ROUTE
7	BARNET	Maj-0215

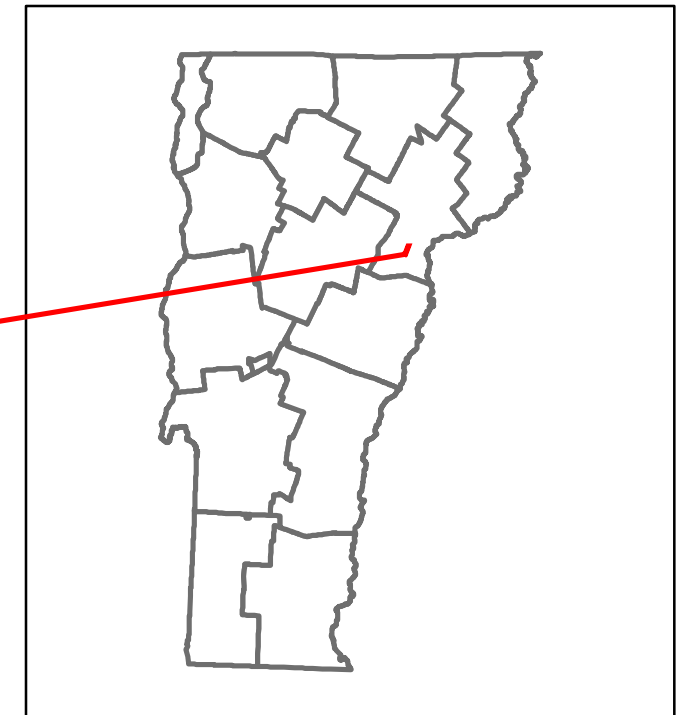

Maj-0215

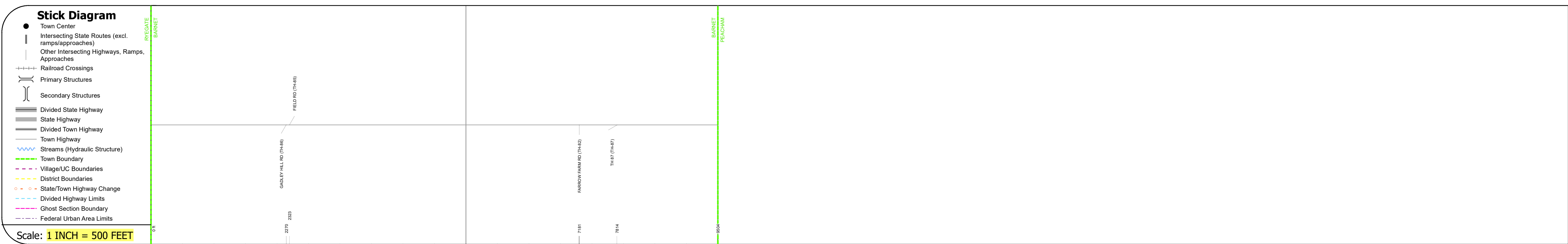
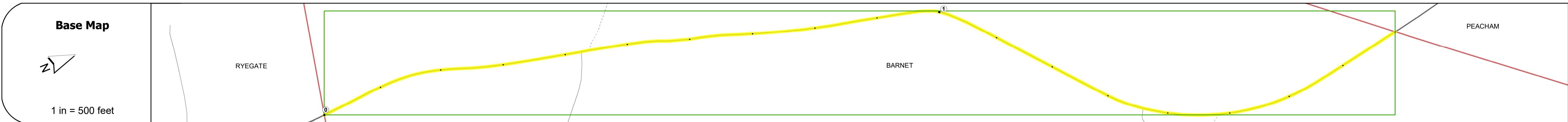

STRUCTURE DESCRIPTIONS

Road Widths	Travellane	22
	Roadway	22
	Lane Count	2
	Base	
	Subbase	18" Gravel

Curves	
---------------	--

Grades	
---------------	--

Guardrails	
-------------------	--

Rumblestrips	
---------------------	--

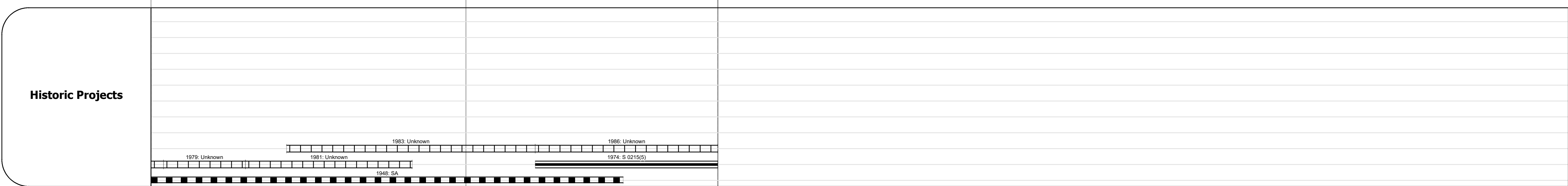

Maintenance Garage	
---------------------------	--

Speed Zone	
-------------------	--

Functional Class	5
-------------------------	---

National Highway System	
--------------------------------	--

Limited Access Highway	
-------------------------------	--

Customer Service Level	
-------------------------------	--

Traffic Counters	C188
-------------------------	------

AADT	2021	295
	2020	260
	2019	307
	2018	290
	2017	290

Crash Locations	(Incomplete) 2022	
	2021	
	2020	
	2019	
	2018	

Historic Projects Unknown, Bituminous Concrete, Retreatment, Bituminous Macadam, Resurface, Cold Plane and Bituminous Concrete, Bituminous Mix, Concrete, Skippy Mix, Bituminous Seal, Gravel, Surface Treated Gravel, Plant Mix, Reclaimed Base and Bituminous Concrete	Functional Class 1 - Interstate System, 2 - Other Freeways and Expressways, 3 - Principal Arterial, 4 - Minor Arterial, 5 - Major Collector, 6 - Minor Collector	Curves Left, Right, Grades (degrees), Left (down), Right (down), Right (up), Left (up)	Traffic Counters Continuous (CTC), Weigh-In-Motion (WIM), Short-Term, Scheduled, Short-Term, Unscheduled	Crash Locations Fatal, Injury, Property Damage Only, Unknown Crash Type, High Crash Locations (HCL's)	Mileage by Functional Class By Sheet 0215 5 - Major Collector 1.800	Mileage by Town By Sheet BARNET - S02150301 1.8 of 1.8	DISTRICT 7	TOWN BARNET	Date: 10/03/22	ROUTE Maj-0215
					Page Total Mileage: 1.800 mi	Page Total Mileage: 1.8 mi	1 of 1 TWN mileage: 0.0 to 1.8	ETE mileage: 4.86 to 6.66		

For More Information Contact - Vermont Agency of Transportation, Policy, Planning and Intermodal Development Division - Mapping Section, 219 North Main Street, Barre, VT 05641 Telephone: 802-828-2600.