



Route Log and Progress Chart

DRAFT

Please Note: Errors and Omissions May Exist.
Contact the VTrans Mapping Section with questions or concerns.

DISTRICT	TOWN	ROUTE
5	BUELS GORE	Maj-0211

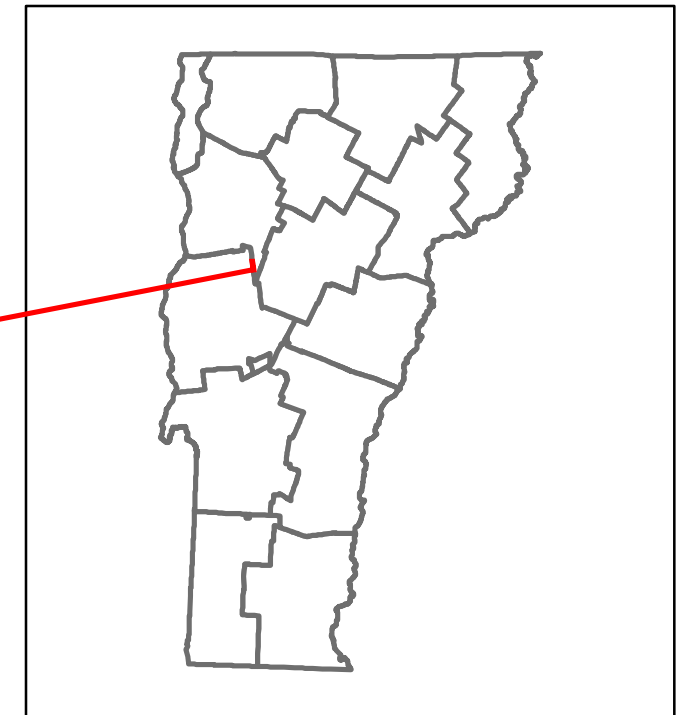

Maj-0211

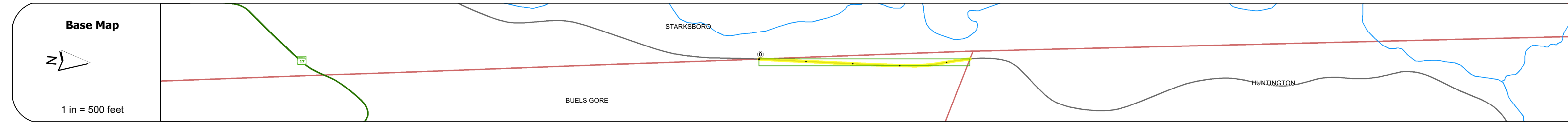

STRUCTURE DESCRIPTIONS

Road Widths	Travellane: 24 Roadway: 24 Lane Count: 2 Base: Subbase:
-------------	---

Curves	
--------	--

Grades	
--------	--

Guardrails	
------------	--

Rumblestrips	
--------------	--

Historic Projects	
-------------------	--

Maintenance Garage	
--------------------	--

Speed Zone	
------------	--

Functional Class	5
------------------	---

National Highway System	
-------------------------	--

Limited Access Highway	
------------------------	--

Customer Service Level	
------------------------	--

Traffic Counters	
------------------	--

AADT	2021: 395 2020: 349 2019: 412 2018: 410 2017: 420
------	---

Crash Locations	(Incomplete) 2022 2021 2020 2019 2018
-----------------	---

Historic Projects Unknown, Bituminous Concrete, Retreatment, Bituminous Macadam, Resurface, Cold Plane and Bituminous Concrete, Bituminous Mix, Concrete, Bituminous Seal, Gravel, Surface Treated Gravel, Plant Mix, Reclaimed Base and Bituminous Concrete	Functional Class 1- Interstate System, 2- Other Freeways and Expressways, 3- Principal Arterial, 4- Minor Arterial, 5- Major Collector, 6- Minor Collector	Curves Left, Right, Grades (degrees), Left, Right, grade up, grade down	Traffic Counters Continuous (CTC), Weigh-In-Motion (WIM), Short-Term, Scheduled, Short-Term, Unscheduled (counter ID)	Crash Locations Fatal, Injury, Property Damage Only, Unknown Crash Type, High Crash Locations (HCL's)	Mileage by Functional Class By Sheet 0211 5 - Major collector 0.450	Mileage by Town By Sheet BUELS GORE - S02110402 0.45 of 0.45	DISTRICT 5	TOWN BUELS GORE	Date: 10/03/22	ROUTE Maj-0211 ETE mileage: 0.91 to 1.36
Page Total Mileage: 0.450 mi						Page Total Mileage: 0.45 mi				

For More Information Contact - Vermont Agency of Transportation, Policy, Planning and Intermodal Development Division - Mapping Section, 219 North Main Street, Barre, VT 05641 Telephone: 802-828-2600.