



# Route Log and Progress Chart

**DRAFT**

Please Note: Errors and Omissions May Exist.  
Contact the VTrans Mapping Section with questions or concerns.

DISTRICT	TOWN	ROUTE
7	CORINTH	Maj-0193

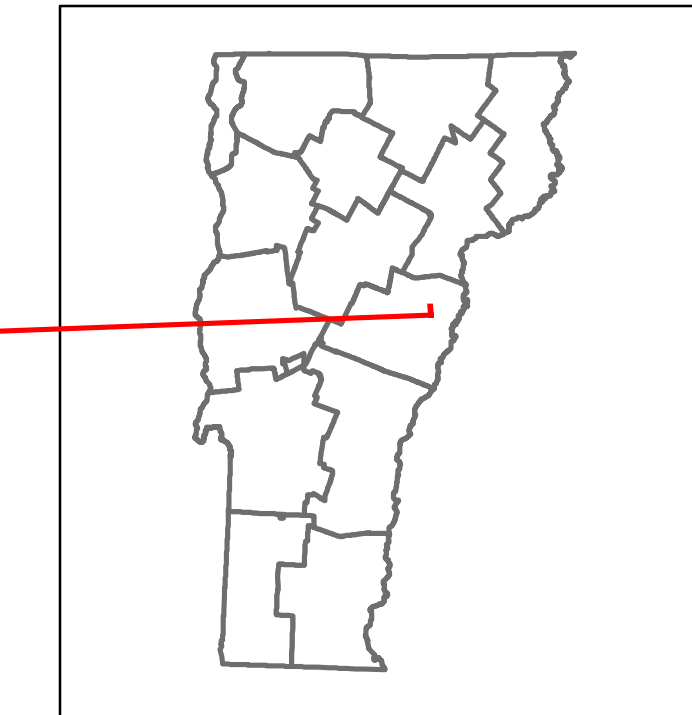

**Maj-0193**

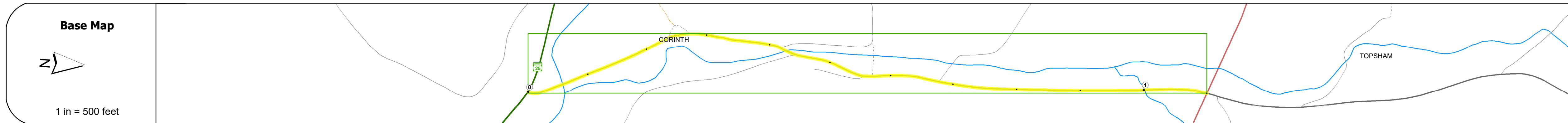

### STRUCTURE DESCRIPTIONS

**Bridge 10C:**  
Slab - 1925  
Structure No. 200193010C09052  
Length: 72'  
Height: 5.33'  
Width: 2.3'  
Facility Carried: TR 01 FAS 193  
Structure Type: 2 SP CONT CONC SLAB  
Features Intersected: WAITS RIVER  
Surface: Bituminous  
Maintenance/Ownership: Town

**Bridge 8:**  
Tee Beam - 1934  
Structure No. 200193000809052  
Length: 49'  
Height: 5.33'  
Width: 2.0'  
Facility Carried: TR 01 FAS 193  
Structure Type: CONCRETE T-BEAM  
Features Intersected: TABOR BROOK  
Surface: Bituminous  
Maintenance/Ownership: Town

<b>Road Widths</b>	Travellane: 18 Roadway: 18 Lane Count: 2 Base Subbase
<b>Curves</b>	2.9
<b>Grades</b>	
<b>Guardrails</b>	
<b>Rumblestrips</b>	
<b>Historic Projects</b>	
<b>Maintenance Garage</b>	
<b>Speed Zone</b>	
<b>Functional Class</b>	5
<b>National Highway System</b>	
<b>Limited Access Highway</b>	
<b>Customer Service Level</b>	
<b>Traffic Counters</b>	
<b>AADT</b>	2021: 1266 2020: 1162 2019: 1372 2018: 1400 2017: 1400
<b>Crash Locations</b>	(Incomplete) 2022 2021 2020 2019 2018

<b>Historic Projects</b> Unknown, Retreatment, Resurface, Bituminous Mix, Skiny Mix, Bituminous Seal Bituminous Concrete, Cold Plane and Bituminous Concrete, Concrete, Gravel, Plant Mix, Reclaimed Base and Bituminous Concrete, Surface Treated Gravel	<b>Functional Class</b> 1- Interstate System, 2- Other Freeways and Expressways, 3- Principal Arterial, 4- Minor Arterial, 5- Major Collector, 6- Minor Collector	<b>Curves</b> Left, Right, Grades (grade up, grade down)	<b>Traffic Counters</b> Continuous (CTC), Weigh-In-Motion (WIM), Short-Term, Scheduled, Short-Term, Unscheduled	<b>Crash Locations</b> Fatal, Injury, Property Damage Only, Unknown Crash Type <b>High Crash Locations (HCL's)</b> Sections (& Intersections) HCL No. 1-100 (1-10), 101-200 (11-20), 201-300 (21-30), 301-400 (31-40), 401-800 (41-113)	<b>Mileage by Functional Class By Sheet</b> 0193 5 - Major Collector 1.100 <b>Page Total Mileage: 1.100 mi</b>	<b>Mileage by Town By Sheet</b> CORINTH - S01930905 1.1 of 1.1 <b>Page Total Mileage: 1.1 mi</b>	<b>DISTRICT</b> 7	<b>TOWN</b> CORINTH	<b>Date:</b> 10/03/22	<b>ROUTE</b> Maj-0193 ETE mileage: 0.0 to 1.1
---	--	---	--	---	--	--	----------------------	------------------------	-----------------------	---