



Route Log and Progress Chart

DRAFT

Please Note: Errors and Omissions May Exist.
Contact the VTrans Mapping Section with questions or concerns.

DISTRICT	TOWN	ROUTE
6	ORANGE	VT-110

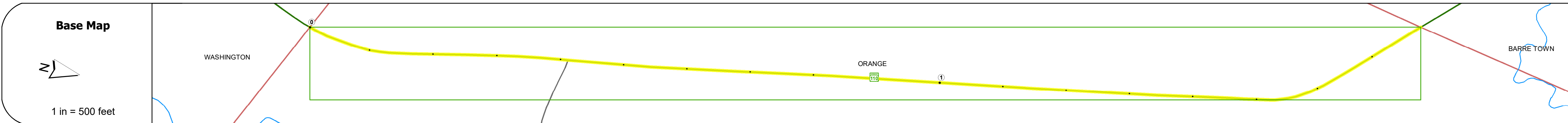
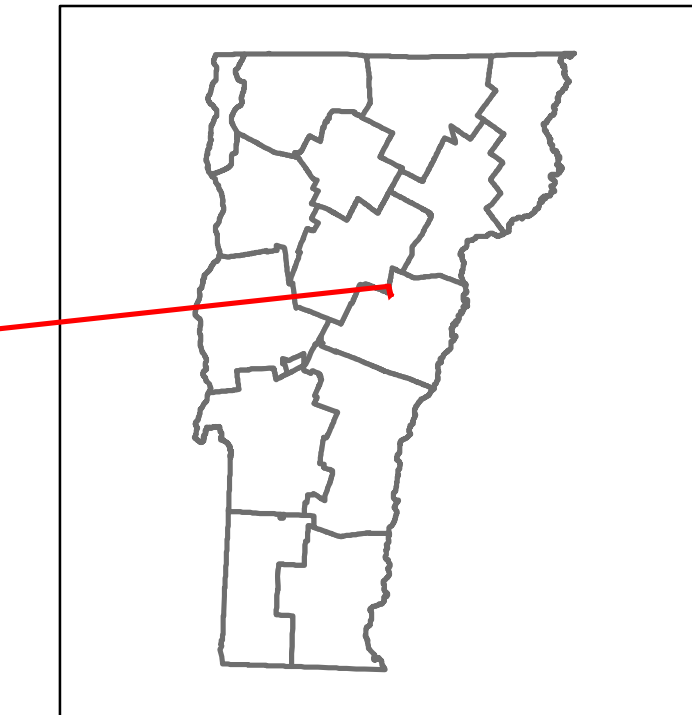

STRUCTURE DESCRIPTIONS

Road Widths	Travellane: 27, 26, 28 Roadway: 2 Lane Count: 2 Base: 12" S.B. Subbase: 12" S.B.
-------------	--

Curves	3, 5, 6
--------	---------

Grades	-0.3
--------	------

Guardrails	
------------	--

Rumblestrips	
--------------	--

Historic Projects	<ul style="list-style-type: none"> 2020: STP FPAV(37) 1999: STP 8744(1)S 1989: HMA 2022 1983: RS 0109(A) 1977: Unknown 1934: NRS 141
-------------------	--

Maintenance Garage	District 7 - DMF Maintenance No Montpelier Garage
--------------------	---

Speed Zone	
------------	--

Functional Class	5
------------------	---

National Highway System	
-------------------------	--

Limited Access Highway	
------------------------	--

Customer Service Level	Local Connector
------------------------	-----------------

Traffic Counters	N126
------------------	------

AADT	<table border="1"> <tr> <td>2020</td> <td>1757</td> <td>1776</td> </tr> <tr> <td>2019</td> <td>2074</td> <td>2097</td> </tr> <tr> <td>2018</td> <td>2100</td> <td>2100</td> </tr> <tr> <td>2017</td> <td>2100</td> <td>2400</td> </tr> <tr> <td>2016</td> <td>2000</td> <td>2700</td> </tr> </table>	2020	1757	1776	2019	2074	2097	2018	2100	2100	2017	2100	2400	2016	2000	2700
2020	1757	1776														
2019	2074	2097														
2018	2100	2100														
2017	2100	2400														
2016	2000	2700														

Crash Locations	<table border="1"> <tr> <td>(Incomplete) 2021</td> <td></td> <td></td> </tr> <tr> <td>2020</td> <td></td> <td></td> </tr> <tr> <td>2019</td> <td></td> <td></td> </tr> <tr> <td>2018</td> <td></td> <td></td> </tr> <tr> <td>2017</td> <td></td> <td></td> </tr> </table>	(Incomplete) 2021			2020			2019			2018			2017		
(Incomplete) 2021																
2020																
2019																
2018																
2017																

Historic Projects <ul style="list-style-type: none"> Unknown Bituminous Concrete Retreatment Resurface Bituminous Mix Skinny Mix Bituminous Seal 	Functional Class <ul style="list-style-type: none"> 1 - Interstate System 2 - Other Freeways and Expressways 3 - Principal Arterial 4 - Minor Arterial 5 - Major Collector 6 - Minor Collector 	Curves <ul style="list-style-type: none"> Left (degree) Right (degree) 	Grades <ul style="list-style-type: none"> grade up (percent) grade down (percent) 	Traffic Counters <ul style="list-style-type: none"> Continuous (CTC) Weight-In-Motion (WIM) Short-Term, Scheduled (counter ID) Short-Term, Unscheduled (counter ID) 	Crash Locations High Crash Locations (HCL's) <ul style="list-style-type: none"> Sections (& Intersections) HCL No. 1-100 (1-10) HCL No. 101-200 (11-20) HCL No. 201-300 (21-30) HCL No. 301-400 (31-40) HCL No. 401-800 (41-113) 	Mileage by Functional Class By Sheet 0169 5 - Major collector 1.790	Mileage by Town By Sheet ORANGE - V110-0908 1.79 of 1.79	DISTRICT 6	TOWN ORANGE	Date: 11/18/21	ROUTE VT-110 ETE mileage: 24.239 to 26.029
Legend Speed Zones 25 30 35 40 45 50 55 60 65						Page Total Mileage: 1.790 mi	Page Total Mileage: 1.79 mi	DISTRICT 6	TOWN ORANGE	1 of 1 TWN mileage: 0.0 to 1.79	ROUTE VT-110 ETE mileage: 24.239 to 26.029

For More Information Contact - Vermont Agency of Transportation, Policy, Planning and Intermodal Development Division - Mapping Section, 1 National Life Drive, Montpelier, VT 05633-5001 Telephone: 802-828-2600.