



Route Log and Progress Chart

DRAFT

Please Note: Errors and Omissions May Exist.
Contact the VTrans Mapping Section with questions or concerns.

DISTRICT	TOWN	ROUTE
6	WARREN	Min-0680

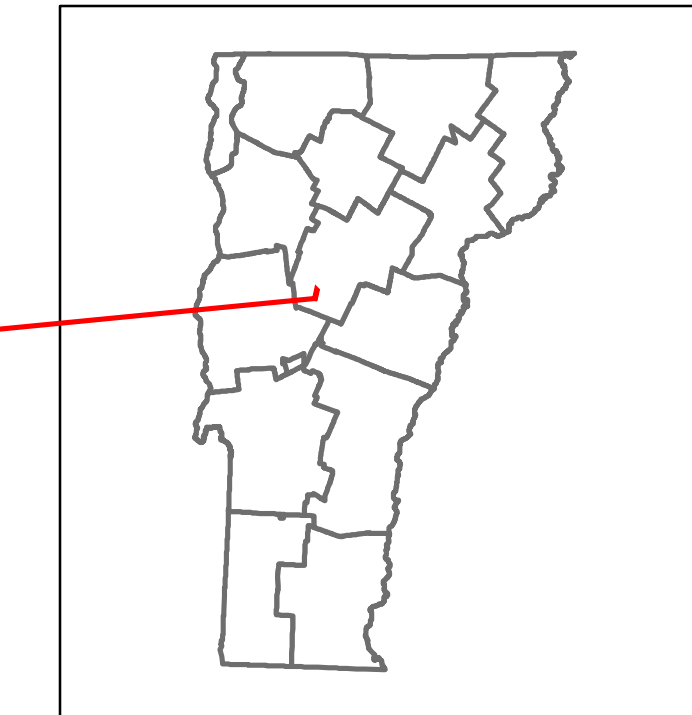

Min-0680

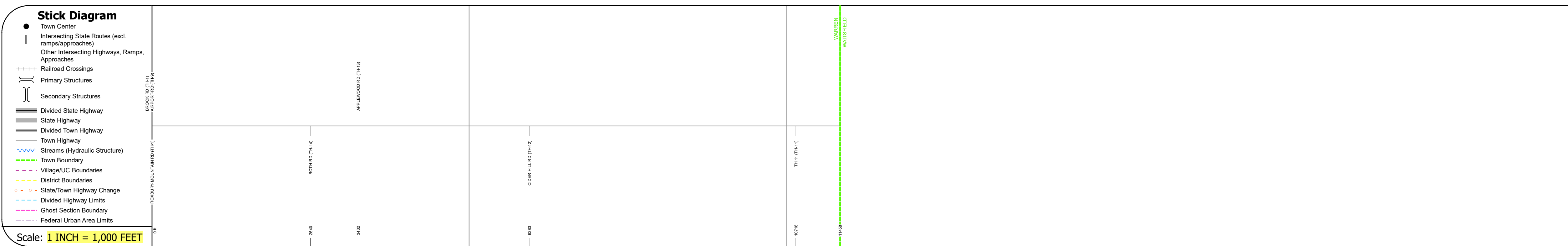
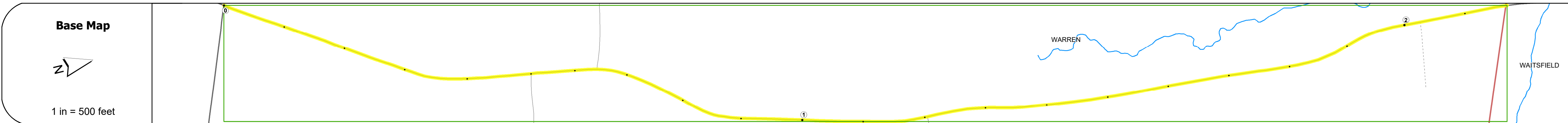

STRUCTURE DESCRIPTIONS

Road Widths	Travellane	24
	Roadway	24
	Lane Count	2
	Base	
	Subbase	
Curves		
Grades		
Guardrails		
Rumblestrips		
Historic Projects		
Maintenance Garage		
Speed Zone		
Functional Class	6	
National Highway System		
Limited Access Highway		
Customer Service Level		
Traffic Counters		
AADT	2020	
	2019	
	2018	
	2017	
	2016	
Crash Locations	(Incomplete) 2021	
	2020	
	2019	
	2018	
	2017	

Historic Projects Unknown, Retreatment, Resurface, Bituminous Mix, Skiny Mix, Bituminous Concrete, Concrete, Gravel, Plant Mix, Reclaimed Base and Bituminous Concrete, Surface Treated Gravel	Functional Class 1 - Interstate System, 2 - Other Freeways and Expressways, 3 - Principal Arterial, 4 - Minor Arterial, 5 - Major Collector, 6 - Minor Collector	Curves Left (degrees), Right (degrees) Grades (degrees) grade up, (degrees) grade down Road Widths (ft)	Traffic Counters Continuous (CTC), Weigh-In-Motion (WIM), Short-Term, Scheduled, Short-Term, Unscheduled (counter ID) Crash Locations High Crash Locations (HCL's) Sections (& Intersections) HCL No. 1-100 (1-10), 101-200 (11-20), 201-300 (21-30), 301-400 (31-40), 401-800 (41-113)	Mileage by Functional Class By Sheet 0680 6 - minor collector 2.170 Page Total Mileage: 2.170 mi	Mileage by Town By Sheet WARREN - S06801217 2.17 of 2.17 Page Total Mileage: 2.17 mi	DISTRICT 6	TOWN WARREN	Date: 11/19/21 1 of 1 TWN mileage: 0.0 to 2.17 ETE mileage: 0.0 to 2.17	ROUTE Min-0680
--	--	---	---	--	--	----------------------	-----------------------	--	--------------------------

For More Information Contact - Vermont Agency of Transportation, Policy, Planning and Intermodal Development Division - Mapping Section, 1 National Life Drive, Montpelier, VT 05633-5001 Telephone: 802-828-2600.