



# Route Log and Progress Chart

**DRAFT**

Please Note: Errors and Omissions May Exist.  
Contact the VTrans Mapping Section with questions or concerns.

DISTRICT	TOWN	ROUTE
1	PAWLET	Min-0564

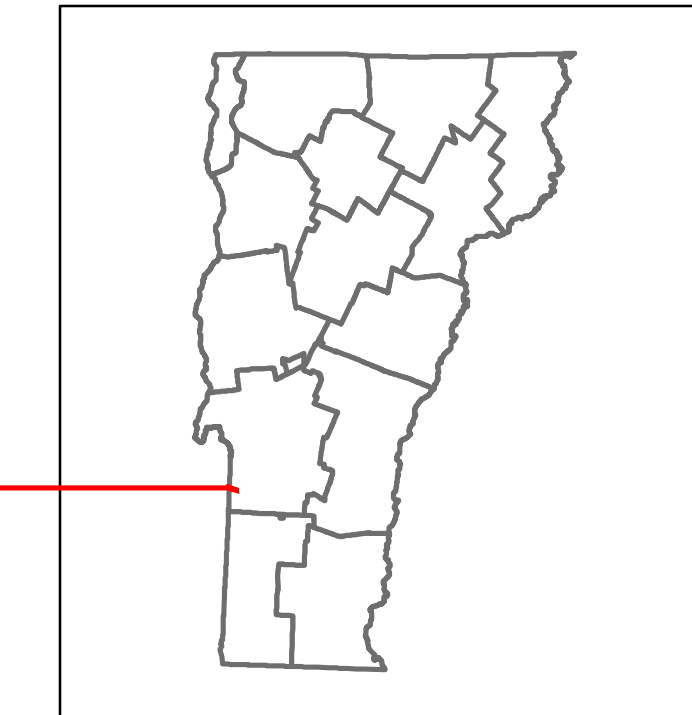

**Min-0564**

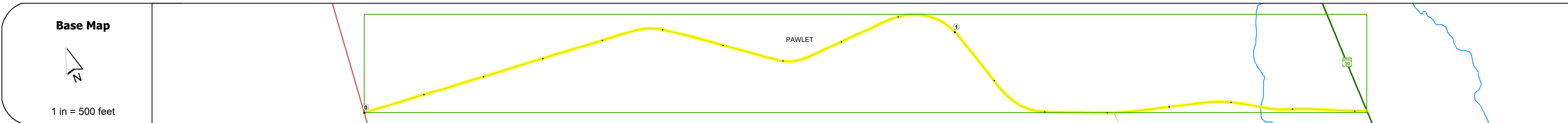

STRUCTURE DESCRIPTIONS	
Bridge 25:	Stringer/multi-beam or girder - 1933 Structure No: 101114002511141 Length: 64' Width: 26.8' Facility Carried: C2002 Structure Type: ROLLED BEAM Features Intersected: METTAWEE RIVER Surface: Bituminous Maintenance/Ownership: Town

<b>Road Widths</b>	Travellane: 22 Roadway: 22 Lane Count: 2 Base: Subbase:
<b>Curves</b>	
<b>Grades</b>	
<b>Guardrails</b>	
<b>Rumblestrips</b>	
<b>Historic Projects</b>	
<b>Maintenance Garage</b>	
<b>Speed Zone</b>	
<b>Functional Class</b>	6
<b>National Highway System</b>	
<b>Limited Access Highway</b>	
<b>Customer Service Level</b>	
<b>Traffic Counters</b>	
<b>AADT</b>	2020 2019 2018 2017 2016
<b>Crash Locations</b>	(Incomplete) 2021 2020 2019 2018 2017

<b>Historic Projects</b> Unknown, Bituminous Concrete, Retreatment, Bituminous Macadam, Resurface, Cold Plane and Bituminous Concrete, Bituminous Mix, Concrete, Skippy Mix, Gravel, Surface Treated Gravel, Plant Mix, Reclaimed Base and Bituminous Concrete	<b>Functional Class</b> 1 - Interstate System, 2 - Other Freeways and Expressways, 3 - Principal Arterial, 4 - Minor Arterial, 5 - Major Collector, 6 - Minor Collector	<b>Curves</b> Left (degrees), Right (degrees), Grades (percent) grade up, (percent) grade down	<b>Traffic Counters</b> Continuous (CTC), Weigh-In-Motion (WIM), Short-Term, Scheduled, Short-Term, Unscheduled (counter ID)	<b>Crash Locations</b> High Crash Locations (HCL's)	<b>Mileage by Functional Class By Sheet</b> 0564 6 - minor collector 1.720	<b>Mileage by Town By Sheet</b> PAWLET - S05641114 1.72 of 1.72	<b>DISTRICT</b> 1	<b>TOWN</b> PAWLET	Date: 11/19/21	<b>ROUTE</b> Min-0564
					Page Total Mileage: 1.720 mi	Page Total Mileage: 1.72 mi	<b>1 of 1</b> TWN mileage: 0.0 to 1.72	ETE mileage: 0.0 to 1.72		

For More Information Contact - Vermont Agency of Transportation, Policy, Planning and Intermodal Development Division - Mapping Section, 1 National Life Drive, Montpelier, VT 05633-5001 Telephone: 802-828-2600.