



Route Log and Progress Chart

DRAFT

Please Note: Errors and Omissions May Exist.
Contact the VTrans Mapping Section with questions or concerns.

DISTRICT	TOWN	ROUTE
5	WILLISTON	Maj-0332

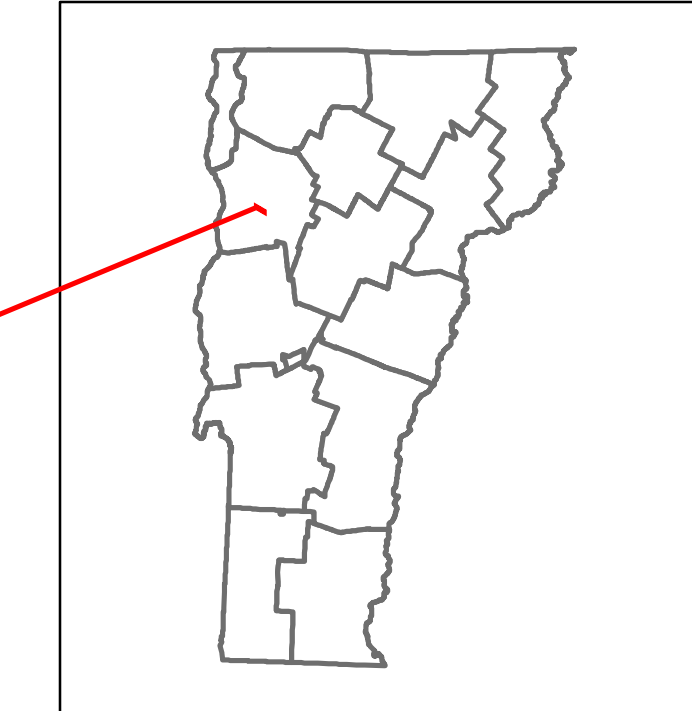

Maj-0332

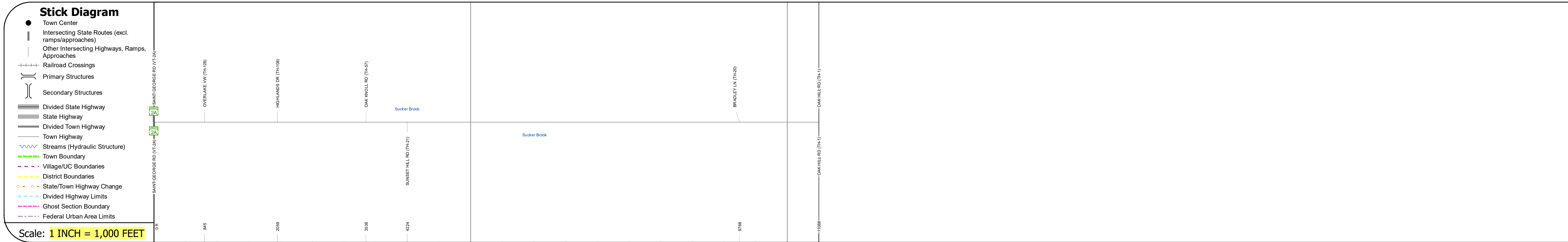
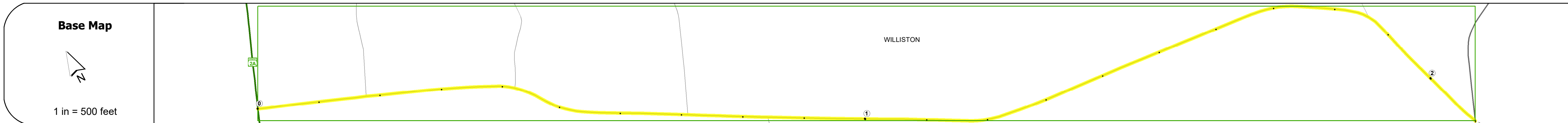

STRUCTURE DESCRIPTIONS

Road Widths	Travellane: 24 Roadway: 24 Lane Count: 2 Base: Subbase:
Curves	
Grades	
Guardrails	
Rumblestrips	
Historic Projects	
Maintenance Garage	
Speed Zone	
Functional Class	5
National Highway System	
Limited Access Highway	
Customer Service Level	
Traffic Counters	
AADT	2020: 2991 2019: 3531 2018: 3600 2017: 3600 2016:
Crash Locations	(Incomplete) 2021: <input type="checkbox"/> 2020: 2019: <input type="checkbox"/> 2018: 2017:

Historic Projects Unknown, Retreatment, Resurface, Bituminous Mix, Skiny Mix, Bituminous Seal, Surface Treated Gravel, Plant Mix, Reclaimed Base and Bituminous Concrete	Functional Class 1- Interstate System, 2- Other, 3- Principal Arterial, 4- Minor Arterial, 5- Major Collector, 6- Minor Collector	Curves Left (degrees), Right (degrees)	Grades (degrees) Left, (degrees) Right, grade up, grade down	Traffic Counters Continuous (CTC), Weigh-In-Motion (WIM), Short-Term, Scheduled, Short-Term, Unscheduled (counter ID)	Crash Locations High Crash Locations (HCL's) Sections (& Intersections) HCL No. 1-100 (1-10), 101-200 (11-20), 201-300 (21-30), 301-400 (31-40), 401-800 (41-113)	Mileage by Functional Class By Sheet 0332 5 - Major Collector 2.100	Mileage by Town By Sheet WILLISTON - S03320417 2.1 of 2.1	DISTRICT 5	TOWN WILLISTON	Date: 11/19/21 1 of 1 TWN mileage: 0.0 to 2.1 ETE mileage: 0.0 to 2.1	ROUTE Maj-0332
Indicated plans available - http://vtransmap01.ad.state.vt.us/tpdpr/DWebstore/						Page Total Mileage: 2.100 mi		Page Total Mileage: 2.1 mi			

For More Information Contact - Vermont Agency of Transportation, Policy, Planning and Intermodal Development Division - Mapping Section, 1 National Life Drive, Montpelier, VT 05633-5001 Telephone: 802-828-2600.