



Route Log and Progress Chart

DRAFT

Please Note: Errors and Omissions May Exist.
Contact the VTrans Mapping Section with questions or concerns.

DISTRICT	TOWN	ROUTE
1	SANDGATE	Maj-0121

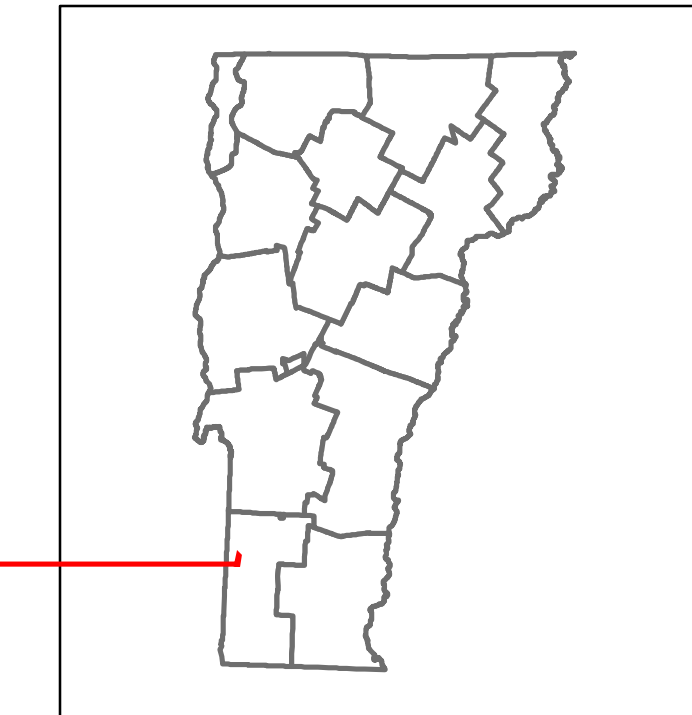

Maj-0121

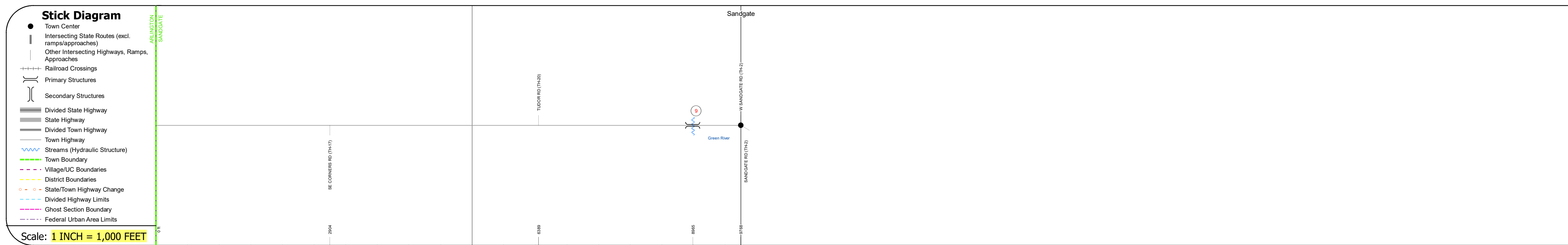
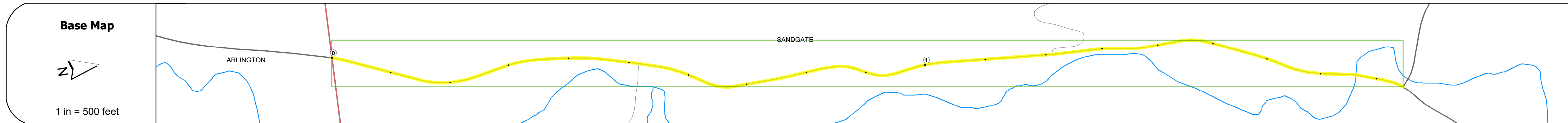

STRUCTURE DESCRIPTIONS

Bridge 9:
Stringer/multi-beam or girder - 1936
Structure No: 200121000902112
Length: 26'
Width: 20.5'
Facility Carried: TR 01 FAS 121
Structure Type: ROLLED BEAM
Features Intersected: GREEN RIVER
Surface: Bituminous
Maintenance/Ownership: Town

Road Widths	Travellane: 22 Roadway: 22 Lane Count: 2 Base: Subbase:
Curves	
Grades	
Guardrails	
Rumblestrips	
Historic Projects	
Maintenance Garage	
Speed Zone	
Functional Class	5
National Highway System	
Limited Access Highway	
Customer Service Level	
Traffic Counters	BT13
AADT	2020: 693 2019: 689 2018: 690 2017: 700 2016: 700
Crash Locations	(Incomplete) 2021 2020 2019 2018 2017

Historic Projects Unknown, Bituminous Concrete, Retreatment, Bituminous Macadam, Resurface, Cold Plane and Bituminous Concrete, Bituminous Mix, Concrete, Skiny Mix, Bituminous Seal, Gravel, Surface Treated Gravel, Plant Mix, Reclaimed Base and Bituminous Concrete	Functional Class 1- Interstate System, 2- Other Freeways and Expressways, 3- Principal Arterial, 4- Minor Arterial, 5- Major Collector, 6- Minor Collector	Curves Left (degrees), Right (degrees) Grades (degrees) Left, (degrees) Right, grade up, grade down	Traffic Counters Continuous (CTC), Weigh-In-Motion (WIM), Short-Term, Scheduled, Short-Term, Unscheduled (counter ID)	Crash Locations High Crash Locations (HCL's) Sections (& Intersections) HCL No. 1-100 (1-10), 101-200 (11-20), 201-300 (21-30), 301-400 (31-40), 401-800 (41-113)	Mileage by Functional Class By Sheet 0121 5 - Major Collector 1.850	Mileage by Town By Sheet SANDGATE - S01210211 1.85 of 1.85	DISTRICT 1	TOWN SANDGATE	Date: 11/19/21	ROUTE Maj-0121 ETE mileage: 1.25 to 3.1
Speed Zones 25 30 35 40 45 50 55 60 65						Page Total Mileage: 1.850 mi	Page Total Mileage: 1.85 mi	1	1 of 1 TWN mileage: 0.0 to 1.85	ETE mileage: 1.25 to 3.1