

DISTRICT	TOWN	ROUTE
7	ST. JOHNSBURY, WATERFORD	I-93

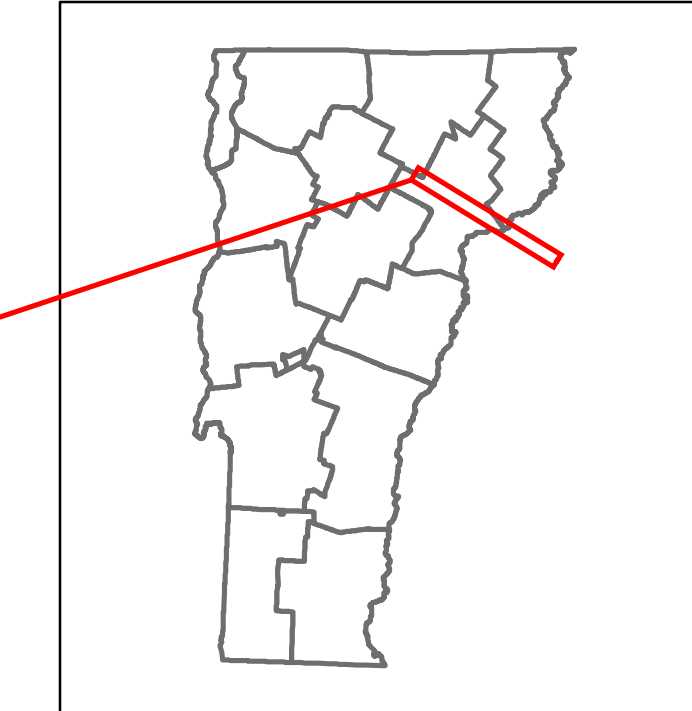

**Base Map**

1 in = 1.8 miles

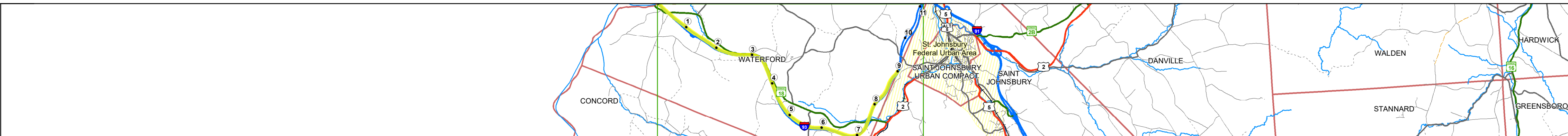

**Stick Diagram**

- Town Center
- Intersecting State Routes (excl. ramps/approaches)
- Other Intersecting Highways, Ramps, Approaches
- Railroad Crossings
- Primary Structures
- Secondary Structures
- Divided State Highway
- State Highway
- Divided Town Highway
- Town Highway
- Streams (Hydraulic Structure)
- Town Boundary
- Village/IC Boundaries
- District Boundaries
- State/Town Highway Change
- Divided Highway Limits
- Ghost Section Boundary
- Federal Urban Area Limits

Scale: 1 INCH = 2,000 FEET

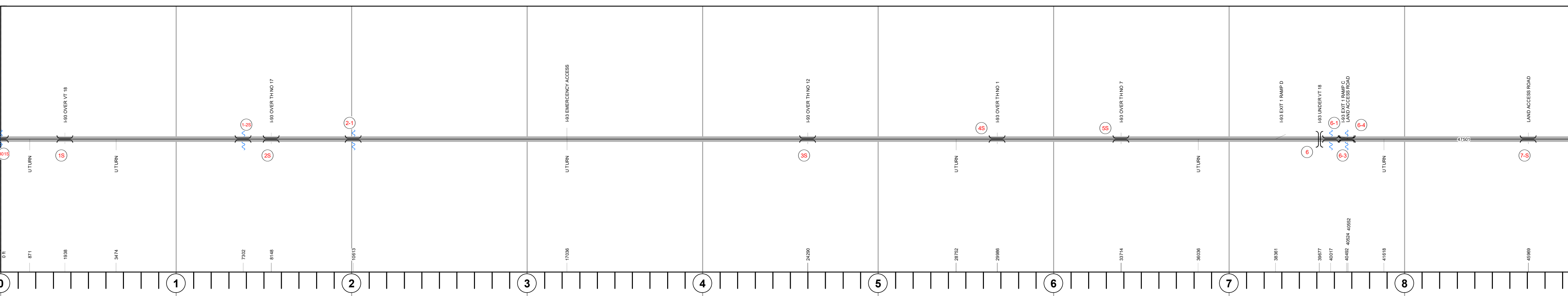

**STRUCTURE DESCRIPTIONS**

**Bridge 801S:** Stringer/multi-beam or girder - 1981  
Structure No. 200093801S03162  
Length: 672'  
Width: 41.0'  
Facility Carried: I-93 SB  
Structure Type: Unknown  
Features Intersected: CONNECTICUT RIVER  
Surface: Bituminous  
Maintenance/Ownership: State

**Bridge 1S:** Frame - 1982  
Structure No. 200093001S03162  
Length: 171'  
Width: 36.5'  
Under Clearance: 14.33'  
Facility Carried: I-93 ML  
Structure Type: STEEL RIGID FRAME  
Features Intersected: I-93 OVER VT 18  
Surface: Bituminous  
Maintenance/Ownership: State

**Bridge 1-2S:** Culvert - 1982  
Structure No. 3000931-2S03161  
Length: 6'  
Under Clearance: 6.0'  
Facility Carried: I-93  
Structure Type: ACGMPP  
Features Intersected: Brook  
Maintenance: State

**Bridge 2S:** Frame - 1982  
Structure No. 200093002S03162  
Length: 28'  
Width: 37.5'  
Under Clearance: 13.92'  
Facility Carried: I-93 ML  
Structure Type: RC BOX  
Features Intersected: I-93 OVER TH NO 17  
Maintenance/Ownership: State

**Bridge 2-1:** Culvert - 1982  
Structure No. 30009302-103161  
Length: 7'  
Under Clearance: 7.0'  
Facility Carried: I-93  
Structure Type: CGMPP  
Features Intersected: BROOK  
Maintenance: State

**Bridge 3S:** Stringer/multi-beam or girder - 1982  
Structure No. 200093003S03162  
Length: 113'  
Width: 36.7'  
Under Clearance: 14.92'  
Facility Carried: I-93 ML  
Structure Type: WELDED PLATE GIRDER  
Features Intersected: I-93 OVER TH NO 12  
Surface: Bituminous  
Maintenance/Ownership: State

**Bridge 4S:** Frame - 1982  
Structure No. 200093004S03162  
Length: 28'  
Width: 37.4'  
Under Clearance: 14.42'  
Facility Carried: I-93 ML  
Structure Type: RC BOX  
Features Intersected: I-93 OVER TH NO 1  
Maintenance/Ownership: State

**Bridge 5S:** Stringer/multi-beam or girder - 1982  
Structure No. 200093005S03162  
Length: 109'  
Width: 36.7'  
Under Clearance: 15.0'  
Facility Carried: I-93 ML  
Structure Type: WELDED PLATE GIRDER  
Features Intersected: I-93 OVER TH NO 7  
Surface: Bituminous  
Maintenance/Ownership: State

**Bridge 6:** Stringer/multi-beam or girder - 1982  
Structure No. 20022500903162  
Length: 214'  
Facility Carried: VT 18 ML  
Structure Type: 2 SP CONT WLD PL GIR  
Features Intersected: I-93 UNDER VT 18

**Bridge 6-1:** Culvert - 1982  
Structure No. 30009306-103161  
Length: 14'  
Under Clearance: 7.0'  
Facility Carried: I-93  
Structure Type: RC BOX  
Features Intersected: STILES BROOK  
Maintenance: State

**Bridge 6-3:** Culvert - 1982  
Structure No. 30009306-303161  
Length: 9'  
Under Clearance: 7.0'  
Facility Carried: I-93  
Structure Type: RC BOX  
Features Intersected: WATER MAIN SLEEVE  
Maintenance: State

**Bridge 6-4:** Culvert - 1982  
Structure No. 30009306-403161  
Length: 14'  
Under Clearance: 12.0'  
Facility Carried: I-93  
Structure Type: RC BOX  
Features Intersected: LAND ACCESS ROAD  
Maintenance: State

**Bridge 7-S:** Culvert - 1982  
Structure No. 300093007S03161  
Length: 14'  
Under Clearance: 12.0'  
Facility Carried: I-93  
Structure Type: RC BOX  
Features Intersected: LAND ACCESS ROAD  
Maintenance: State

<b>Road Widths</b>	Travellane	24
	Roadway	40
	Lane Count	2
	Base	Two 7 1/2" Plant Mix Base Courses
	Subbase	24" Crushed Stone
<b>Curves</b>		
<b>Grades</b>		
<b>Guardrails</b>		
<b>Rumblestrips</b>		
<b>Historic Projects</b>	2015: M MEMB(31)	2008: HES 003-1100
	1999: M 093-193	2015: M MEMB(31)
	1982: I-93-103 C1	1989: I-93-141 C1 STAGE 3
		1982: I-93-103 C2
		1982: I-93-103 C3
<b>Maintenance Garage</b>		District 7 - DMF Maintenance St. Johnsbury Garage
<b>Speed Zone</b>		
<b>Functional Class</b>		1 - Interstate
<b>National Highway System</b>		NHS - Interstate
<b>Limited Access Highway</b>		Full
<b>Customer Service Level</b>		Interstate Or Divided Highway
<b>Traffic Counters</b>		
<b>AADT</b>	2020	2679
	2019	3738
	2018	2216
	2017	2954
	2016	2852
	2015	3356
<b>Crash Locations</b>	(Incomplete) 2021	
	2020	
	2019	
	2018	
	2017	

<p><b>Historic Projects</b></p> <ul style="list-style-type: none"> <li>Unknown</li> <li>Retreatment</li> <li>Resurface</li> <li>Bituminous Mix</li> <li>Skinny Mix</li> <li>Bituminous Seal</li> </ul> <p>Indicated plans available - <a href="http://vtransmap01.ad.state.vt.us/tpdgr/DWebstore/">http://vtransmap01.ad.state.vt.us/tpdgr/DWebstore/</a></p>	<p><b>Functional Class</b></p> <ul style="list-style-type: none"> <li>1 - Interstate System</li> <li>2 - Other Freeways and Expressways</li> <li>3 - Principal Arterial</li> <li>4 - Minor Arterial</li> <li>5 - Major Collector</li> <li>6 - Minor Collector</li> </ul>	<p><b>Curves</b></p> <ul style="list-style-type: none"> <li>Left (degrees)</li> <li>Right (degrees)</li> </ul> <p><b>Grades</b></p> <ul style="list-style-type: none"> <li>Special</li> <li>grade up</li> <li>grade down</li> </ul>	<p><b>Traffic Counters</b></p> <ul style="list-style-type: none"> <li>Continuous (CTC)</li> <li>Weight-In-Motion (WIM)</li> <li>Short-Term, Scheduled</li> <li>Short-Term, Unscheduled</li> </ul> <p><b>Crash Locations</b></p> <p>High Crash Locations (HCL's) Sections (&amp; Intersections)</p> <ul style="list-style-type: none"> <li>1 - 100 (1 - 10)</li> <li>101 - 200 (11 - 20)</li> <li>201 - 300 (21 - 30)</li> <li>301 - 400 (31 - 40)</li> <li>401 - 800 (41 - 113)</li> </ul>	<p><b>Mileage by Functional Class By Sheet</b></p> <p>93-1 1 - Interstate 9.000</p>	<p><b>Mileage by Town By Sheet</b></p> <p>ETE - I093-00005 9.0 of 11.075</p>	<p><b>DISTRICT</b></p> <p>7</p>	<p><b>TOWN</b></p> <p>ST. JOHNSBURY, WATERFORD</p>	<p><b>Date:</b> 11/22/21</p>	<p><b>ROUTE</b></p> <p>I-93</p> <p>ETE mileage: 0.0 to 9.0</p>
---	--	---	--	---	--	---------------------------------	--	------------------------------	--