

DISTRICT	TOWN	ROUTE
4	RANDOLPH	VT-12A

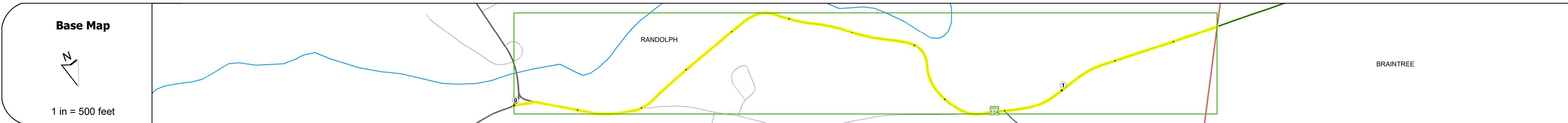
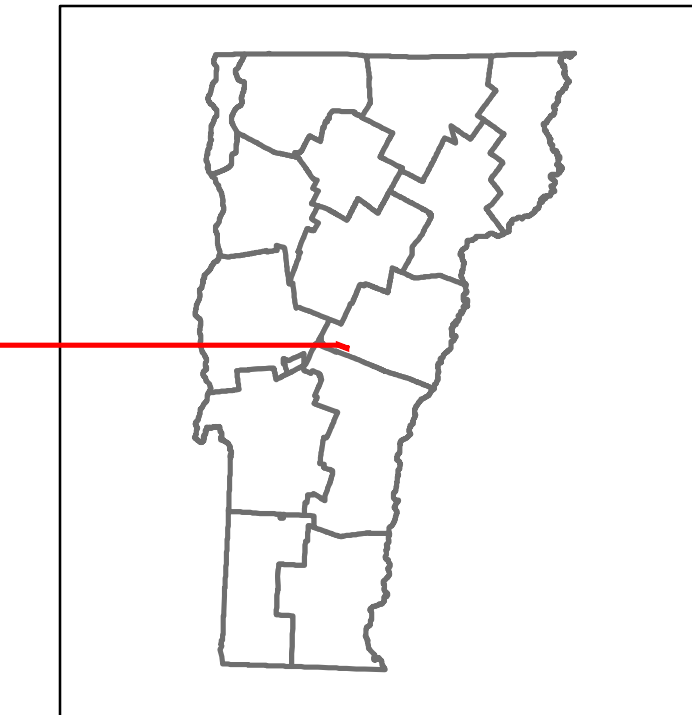

STRUCTURE DESCRIPTIONS

Culvert 1:
Culvert - 1952
Structure No. 300187000109091
Length: 6'
Under Clearance: 5.5'
Facility Carried: VT12A
Structure Type: ACCMPP
Features Intersected: BROOK
Maintenance: State

Road Widths

Travellane	23	20
Roadway	25	22
Lane Count	2	
Base		
Subbase		

Curves

6	20	24	5	5	30	16	20	10	9
---	----	----	---	---	----	----	----	----	---

Grades

Guardrails

Rumblestrips

Historic Projects

Maintenance Garage

District 4 - HWY Maintenance Randolph Garage

Speed Zone

20

Functional Class

5

National Highway System

Limited Access Highway

Customer Service Level

Class 1 Town Highway Local Connector

Traffic Counters

AADT Counts

2018	2700	2300	2100
2017	2900	2300	2100
2016	3000	2300	2100
2015	3200	2300	2100
2014	3200	2300	2100

Crash Locations

2018	
2017	
2016	
2015	
2014	

<p>Historic Projects</p> <ul style="list-style-type: none"> Unknown Retreatment Resurface Bituminous Mix Skinny Mix Bituminous Seal 	<p>Functional Class</p> <ul style="list-style-type: none"> 1 - Interstate System 2 - Other Freeways and Expressways 3 - Principal Arterial 4 - Minor Arterial 5 - Major Collector 6 - Minor Collector 	<p>Curves</p> <ul style="list-style-type: none"> Left (degrees) Right (degrees) 	<p>Grades</p> <ul style="list-style-type: none"> grade up (degrees) grade down (degrees) 	<p>Traffic Counters</p> <ul style="list-style-type: none"> Continuous (CTC) Weight-In-Motion (WIM) Short-Term, Scheduled Short-Term, Unscheduled 	<p>Crash Locations</p> <ul style="list-style-type: none"> Fatal Injury Property Damage Only Unknown Crash Type 	<p>Mileage by Functional Class By Sheet</p> <p>0187 5 - Major Collector 1.275</p>	<p>Mileage by Town By Sheet</p> <p>RANDOLPH - V012A0909 1.275 of 1.275</p>	<p>DISTRICT</p> <p>4</p>	<p>TOWN</p> <p>RANDOLPH</p>	<p>Date: 12/01/19</p>	<p>ROUTE</p> <p>VT-12A</p>
						<p>Page Total Mileage: 1.275 mi</p>		<p>Page Total Mileage: 1.275 mi</p>		<p>1 of 1</p> <p>ETE mileage: 0.0 to 1.275</p>	<p>ETE mileage: 0.0 to 1.275</p>