



Route Log and Progress Chart

DRAFT

Please Note: Errors and Omissions May Exist.
Contact the VTrans Mapping Section with questions or concerns.

DISTRICT	TOWN	ROUTE
4	RANDOLPH	Min-0644

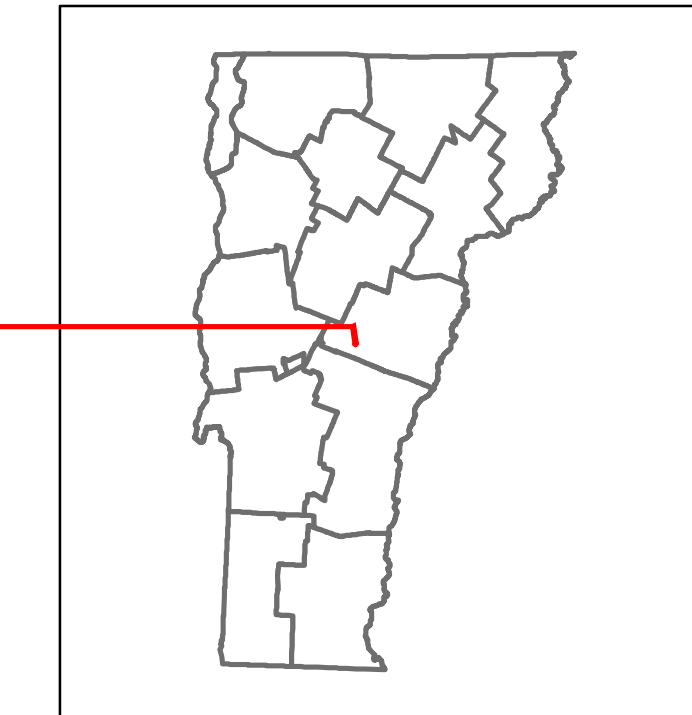

Min-0644

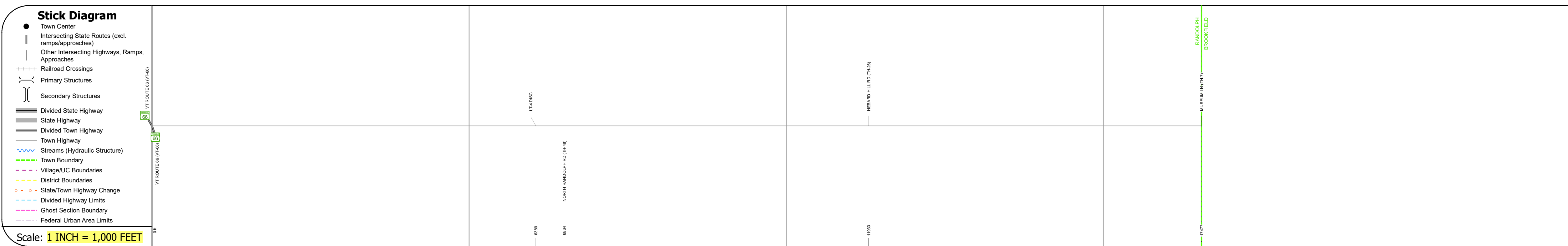
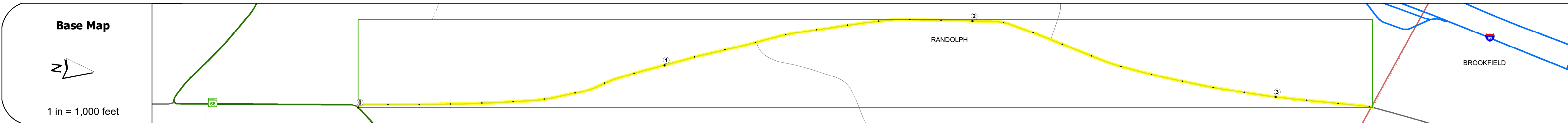

STRUCTURE DESCRIPTIONS

Road Widths	Travellane	22			
	Roadway	22			
	Lane Count	2			
	Base				
	Subbase				
Curves					
Grades					
Guardrails					
Rumblestrips					
Historic Projects					
Maintenance Garage					
Speed Zone					
Functional Class		6			
National Highway System					
Limited Access Highway					
Customer Service Level					
Traffic Counters					
AAADT	2018				
	2017				
	2016				
	2015				
	2014				
Crash Locations	2018				
	2017				
	2016				
	2015				
	2014				

Historic Projects Unknown, Retreatment, Resurface, Bituminous Mix, Skippy Mix, Bituminous Seal Bituminous Concrete, Cold Plane and Bituminous Concrete, Concrete, Gravel, Plant Mix, Reclaimed Base and Bituminous Concrete	Functional Class 1- Interstate System, 2- Other Freeways and Expressways, 3- Principal Arterial, 4- Minor Arterial, 5- Major Collector, 6- Minor Collector	Curves Left, Right, Grades (degrees), Left grade up, Right grade down	Traffic Counters Continuous (CTC), Weigh-In-Motion (WIM), Short-Term, Scheduled, Short-Term, Unscheduled	Crash Locations Fatal, Injury, Property Damage Only, Unknown Crash Type, High Crash Locations (HCL's)	Mileage by Functional Class By Sheet 0644 6 - minor collector 3.310	Mileage by Town By Sheet RANDOLPH - S06440909 3.31 of 3.31	DISTRICT 4	TOWN RANDOLPH	Date: 12/05/19	ROUTE Min-0644 ETE mileage: 0.0 to 3.31
					Page Total Mileage: 3.310 mi	Page Total Mileage: 3.31 mi	1 of 1 TWN mileage: 0.0 to 3.31			

For More Information Contact - Vermont Agency of Transportation, Policy, Planning and Intermodal Development Division - Mapping Section, 1 National Life Drive, Montpelier, VT 05633-5001 Telephone: 802-828-2600.