

DISTRICT	TOWN	ROUTE
9	WESTMORE	Maj-0286

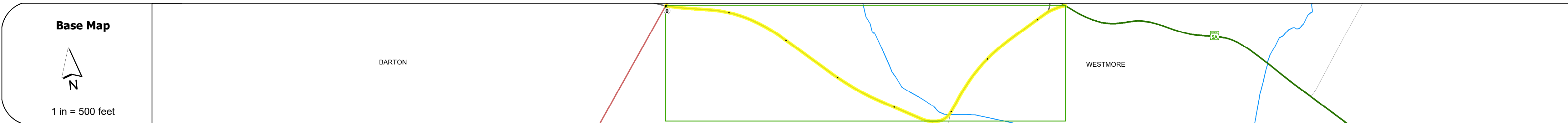
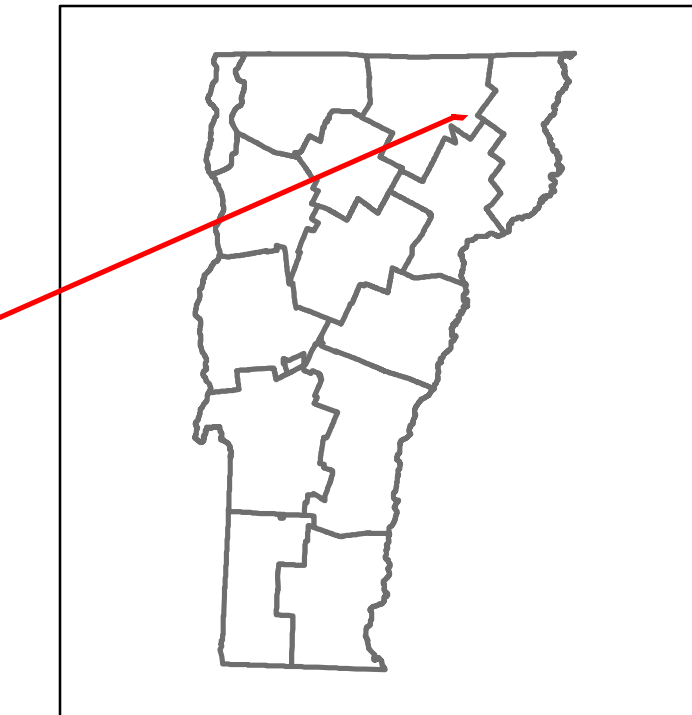

STRUCTURE DESCRIPTIONS

Road Widths	Travellane: 20, 24 Roadway: 20, 24 Lane Count: 2 Base Subbase
-------------	---

Curves	
--------	--

Grades	
--------	--

Guardrails	
------------	--

Rumblestrips	
--------------	--

Historic Projects	
-------------------	--

Maintenance Garage	
--------------------	--

Speed Zone	
------------	--

Functional Class	5
------------------	---

National Highway System	
-------------------------	--

Limited Access Highway	
------------------------	--

Customer Service Level	
------------------------	--

Traffic Counters	PKAP
------------------	------

AAADT	2018: 560 2017: 570 2016: 550 2015: 530 2014: 510
-------	---

Crash Locations	2018 2017 2016: 1 2015 2014
-----------------	---

Historic Projects <ul style="list-style-type: none"> Unknown Retreatment Resurface Bituminous Mix Skinny Mix Bituminous Seal Surface Treated Gravel Cold Plane and Plant Mix Reclaimed Base and Bituminous Concrete Concrete Gravel 	Functional Class <ul style="list-style-type: none"> 1 - Interstate System 2 - Other Freeways and Expressways 3 - Principal Arterial 4 - Minor Arterial 5 - Major Collector 6 - Minor Collector 	Curves <ul style="list-style-type: none"> Left (degrees) Right (degrees) Grades (percent) grade up grade down 	Traffic Counters <ul style="list-style-type: none"> Continuous (CTC) Weight-In-Motion (WIM) Short-Term, Scheduled (counter ID) Short-Term, Unscheduled 	Crash Locations <ul style="list-style-type: none"> Fatal Injury Property Damage Only Unknown Crash Type 	Mileage by Functional Class By Sheet 0286 5 - Major collector 0.750 Page Total Mileage: 0.750 mi	Mileage by Town By Sheet WESTMORE - S02861019 0.75 of 0.75 Page Total Mileage: 0.75 mi	DISTRICT 9	TOWN WESTMORE	Date: 12/05/19 1 of 1 TWN mileage: 0.0 to 0.75	ROUTE Maj-0286 ETE mileage: 6.31 to 7.06
--	--	--	--	---	---	---	----------------------	-------------------------	--	---