



Route Log and Progress Chart

DRAFT

Please Note: Errors and Omissions May Exist.
Contact the VTrans Mapping Section with questions or concerns.

DISTRICT	TOWN	ROUTE
1	SANDGATE	Maj-0121

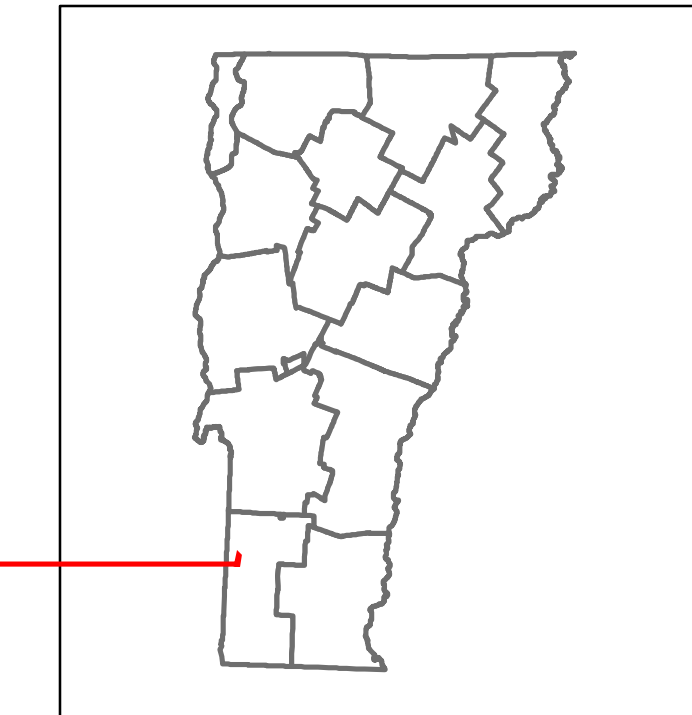

Maj-0121

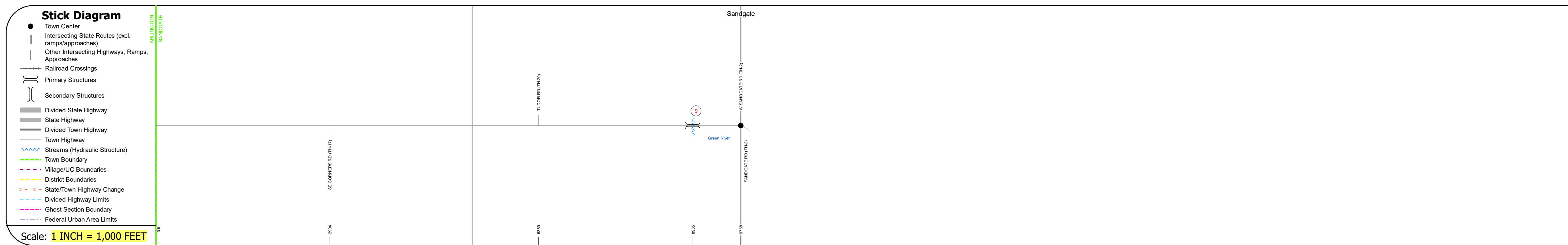
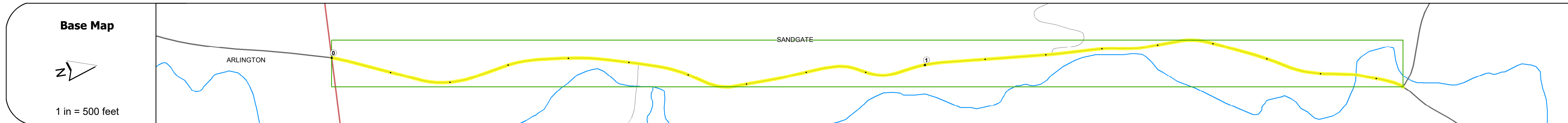

STRUCTURE DESCRIPTIONS	
Bridge 9:	Stringer/multi-beam or girder - 1936
	Structure No: 200121000902112
	Length: 26'
	Width: 20.5'
	Facility Carried: TR 01 FAS 121
	Structure Type: ROLLED BEAM
	Features Intersected: GREEN RIVER
	Surface: Bituminous
	Maintenance/Ownership: Town

Category	0	1
Road Widths	Travellane: 22 Roadway: 22 Lane Count: 2 Base Subbase	
Curves		
Grades		
Guardrails		
Rumblestrips		
Historic Projects		
Maintenance Garage		
Speed Zone		
Functional Class	5 - Major Collector	
National Highway System		
Limited Access Highway		
Customer Service Level		
Traffic Counters		
AAADT	2018: 690 2017: 700 2016: 700 2015: 700 2014: 700	
Crash Locations	2018: 1 2017: 0 2016: 0 2015: 0 2014: 0	

Historic Projects Unknown, Bituminous Concrete, Retreatment, Cold Plane and Resurface, Bituminous Mix, Skiny Mix, Bituminous Seal, Surface Treated Gravel, Plant Mix, Reclaimed Base and Bituminous Concrete	Functional Class 1- Interstate System, 2- Other Freeways and Expressways, 3- Principal Arterial, 4- Minor Arterial, 5- Major Collector, 6- Minor Collector	Curves Left, Right, Grades (up/down)	Traffic Counters Continuous (CTC), Weigh-In-Motion (WIM), Short-Term, Scheduled, Short-Term, Unscheduled	Crash Locations Fatal, Injury, Property Damage Only, Unknown Crash Type	Mileage by Functional Class By Sheet 0121 5 - Major Collector 1.850	Mileage by Town By Sheet SANDGATE - S01210211 1.85 of 1.85	DISTRICT 1	TOWN SANDGATE	Date: 12/04/19	ROUTE Maj-0121 ETE mileage: 1.25 to 3.1
Speed Zones 25, 30, 35, 40, 45, 50, 55, 60, 65						Page Total Mileage: 1.850 mi		Page Total Mileage: 1.85 mi		

For More Information Contact - Vermont Agency of Transportation, Policy, Planning and Intermodal Development Division - Mapping Section, 1 National Life Drive, Montpelier, VT 05633-5001 Telephone: 802-828-2600.