



Route Log and Progress Chart

DRAFT

Please Note: Errors and Omissions May Exist.
Contact the VTrans Mapping Section with questions or concerns.

DISTRICT	TOWN	ROUTE
1	ARLINGTON	Maj-0121

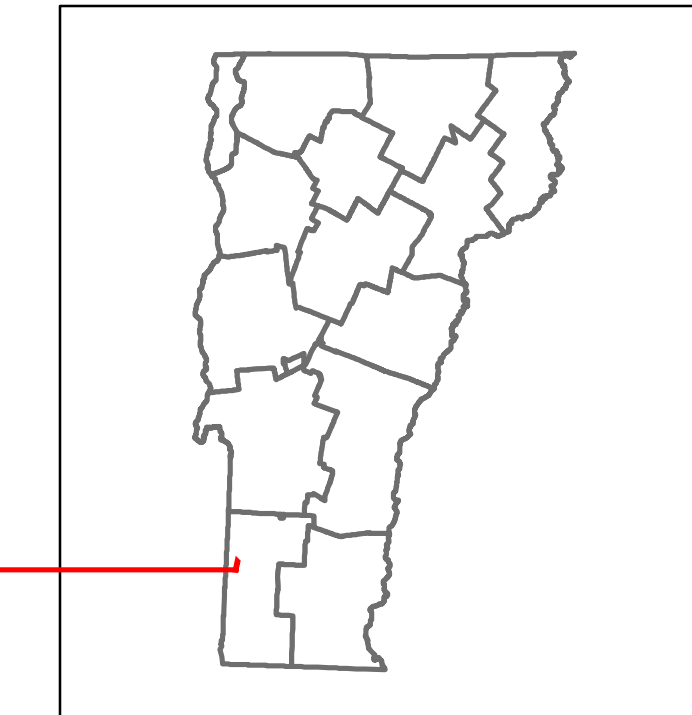

Maj-0121

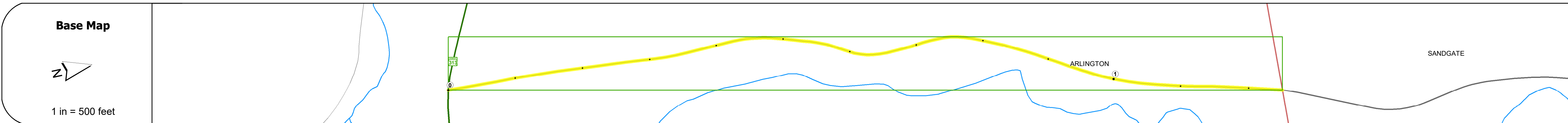

STRUCTURE DESCRIPTIONS

Road Widths	Travellane: 24 Roadway: 24 Lane Count: 2 Base: Subbase:
-------------	---

Curves	
--------	--

Grades	
--------	--

Guardrails	
------------	--

Rumblestrips	
--------------	--

Historic Projects	
-------------------	--

Maintenance Garage	
--------------------	--

Speed Zone	
------------	--

Functional Class	5
------------------	---

National Highway System	
-------------------------	--

Limited Access Highway	
------------------------	--

Customer Service Level	
------------------------	--

Traffic Counters	▲ B326
------------------	--------

ADT	2018: 690 2017: 700 2016: 700 2015: 700 2014: 700
-----	---

Crash Locations	2018: 2017: 2016: 2015: 2014: ■
-----------------	---

Historic Projects ■ Unknown ■ Bituminous Concrete ■ Retreatment ■ Resurface ■ Bituminous Mix ■ Skiny Mix ■ Bituminous Seal ■ Surface Treated Gravel ■ Plant Mix ■ Reclaimed Base and Bituminous Concrete ■ Concrete ■ Gravel	Functional Class 1 - Interstate System 2 - Other Freeways and Expressways 3 - Principal Arterial 4 - Minor Arterial 5 - Major Collector 6 - Minor Collector	Curves (degrees) Left Right Grades (percent) grade up grade down Road Widths (ft)	Traffic Counters ♀ Continuous (CTC) ♀ Weigh-In-Motion (WIM) ▲ Short-Term, Scheduled ▲ Short-Term, Unscheduled (counter ID)	Crash Locations ■ Fatal ■ Injury ■ Property Damage Only ■ Unknown Crash Type High Crash Locations (HCL's) Sections (& Intersections) HCL No. 1-100 (1-10) 201-300 (21-30) 101-200 (11-20) 401-800 (41-113)	Mileage by Functional Class By Sheet 0121 5 - Major Collector 1.250 Page Total Mileage: 1.250 mi	Mileage by Town By Sheet ARLINGTON - S01210201 1.25 of 1.25 Page Total Mileage: 1.25 mi	DISTRICT 1	TOWN ARLINGTON	Date: 12/04/19 1 of 1 TWN mileage: 0.0 to 1.25 ETE mileage: 0.0 to 1.25	ROUTE Maj-0121 ETE mileage: 0.0 to 1.25
---	--	---	---	--	--	---	----------------------	--------------------------	--	--

For More Information Contact - Vermont Agency of Transportation, Policy, Planning and Intermodal Development Division - Mapping Section, 1 National Life Drive, Montpelier, VT 05633-5001 Telephone: 802-828-2600.