

DISTRICT	TOWN	ROUTE
1	PAWLET	Maj-0130

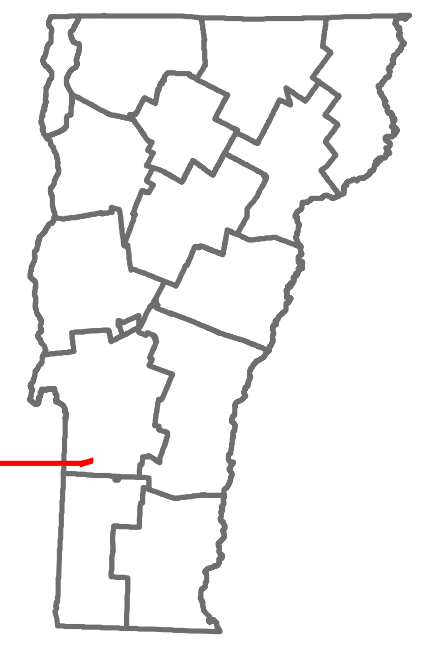

**Maj-0130**

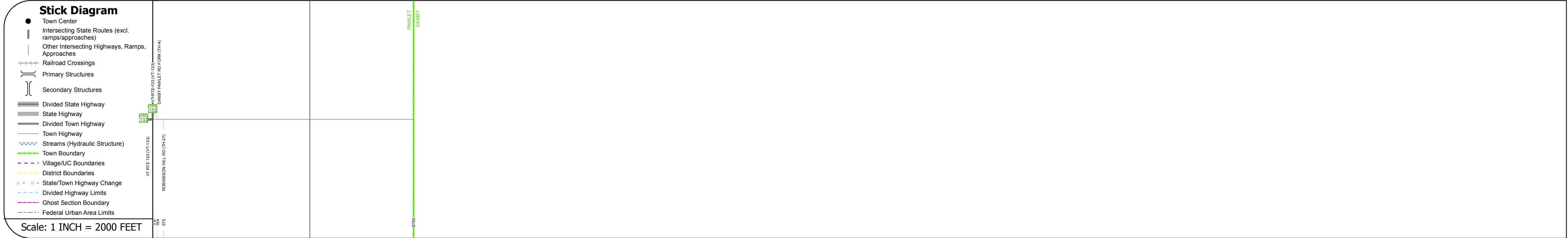
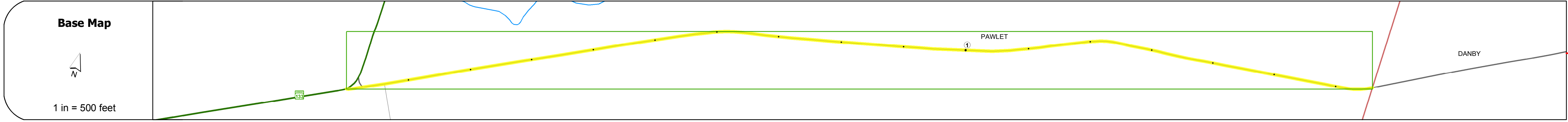

<b>Road Widths</b>	Travellane	20
	Roadway	22
	Lane Count	2
	Base	15' - 18" Gravel
	Subbase	

<b>Curves</b>	
---------------	--

<b>Grades</b>	
---------------	--

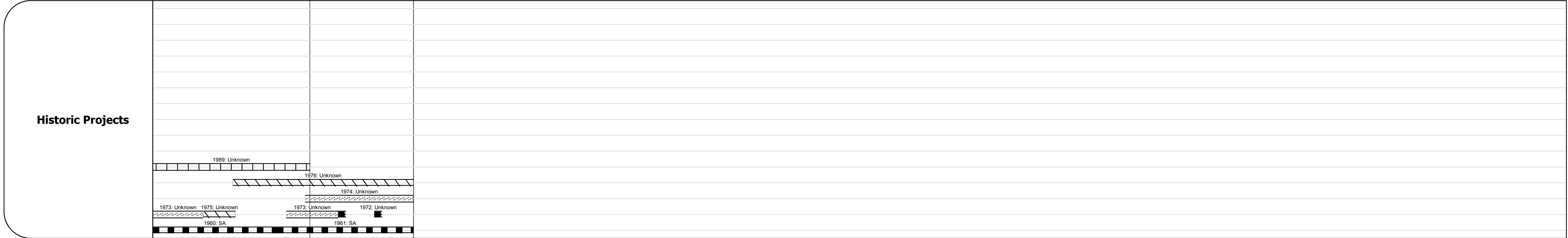

<b>Maintenance Garage</b>	
---------------------------	--

<b>Speed Zone</b>	
-------------------	--

<b>Functional Class</b>	5
-------------------------	---

<b>National Highway System</b>	
--------------------------------	--

<b>Limited Access Highway</b>	
-------------------------------	--

<b>Traffic Counters</b>	
-------------------------	--

<b>Customer Service Level</b>	
-------------------------------	--

<b>AADT Counts</b>	2016	810
	2015	790
	2014	750
	2013	770
	2012	790

<b>Crash Locations</b>	2016	
	2015	
	2014	
	2013	
	2012	

**STRUCTURE DESCRIPTIONS**

--

<b>Historic Projects</b> Unknown, Bituminous Concrete, Retreatment, Resurface, Bituminous Mix, Skippy Mix, Bituminous Seal, Surface Treated Gravel, Plant Mix, Reclaimed Base and Bituminous Concrete	<b>Functional Class</b> 1 - Interstate System, 2 - Other Freeways and Expressways, 3 - Principal Arterial, 4 - Minor Arterial, 5 - Major Collector, 6 - Minor Collector	<b>Curves</b> Left (segress), Right, Grades grade up, grade down	<b>Road Widths</b> (ft), Traffic Counters (counter ID), AADT (count)	<b>Crash Locations</b> Fatal, Injury, Property Damage Only, Unknown Crash Type, High Crash Locations (HCL's) HCL No. 1-100, 101-200, 201-300, 301-400, 401-800	<b>Mileage by Functional Class By Sheet</b> 0130 5 - Major collector 1.660	<b>Mileage by Town By Sheet</b> PAWLET - S01301114 1.66 of 1.66	<b>DISTRICT</b> 1	<b>TOWN</b> PAWLET	Date: 10/16/17	<b>ROUTE</b> Maj-0130 ETE mileage: 0.0 to 1.66
					<b>Page Total Mileage: 1.660 mi</b>	<b>Page Total Mileage: 1.66 mi</b>	<b>1 of 1</b> TWN mileage: 0.0 to 1.66			