



Route Log and Progress Chart

DRAFT

Please Note: Errors and Omissions May Exist.
Contact the VTrans Mapping Section with questions or concerns.

DISTRICT	TOWN	ROUTE
1	ARLINGTON	Maj-0121

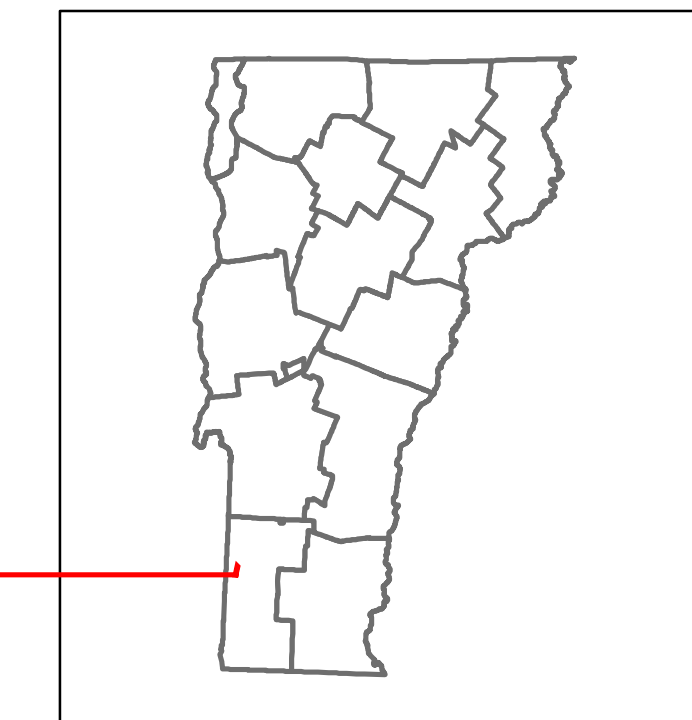

Maj-0121

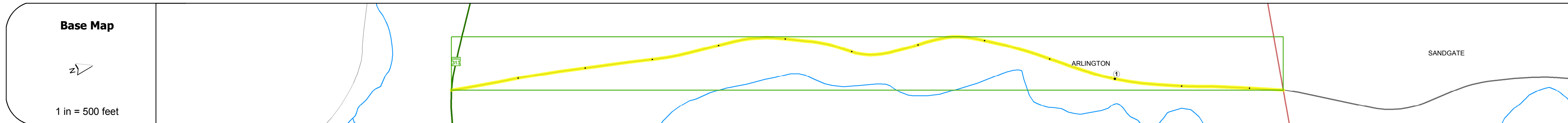

Road Widths	Travellane	Roadway	Lane Count	Base	Subbase
	24	24	2		

Curves	
--------	--

Grades	
--------	--

Historic Projects	
-------------------	--

Maintenance Garage	
--------------------	--

Speed Zone	
------------	--

Functional Class	5
------------------	---

National Highway System	
-------------------------	--

Limited Access Highway	
------------------------	--

Traffic Counters	8326
------------------	------

Customer Service Level	
AADT Counts	2016: 750, 2015: 740, 2014: 700, 2013: 700, 2012: 700

Crash Locations	2016, 2015, 2014, 2013, 2012
-----------------	------------------------------

STRUCTURE DESCRIPTIONS

Historic Projects Unknown, Retreatment, Resurface, Bituminous Mix, Skippy Mix, Bituminous Seal, Surface Treated Gravel, Plant Mix, Reclaimed Base and Bituminous Concrete, Concrete, Gravel	Functional Class 1 - Interstate System, 2 - Other Freeways and Expressways, 3 - Principal Arterial, 4 - Minor Arterial, 5 - Major Collector, 6 - Minor Collector	Curves Left (segreg), Right, Grades (grade up, grade down)	Road Widths (ft), Traffic Counters (counter ID), AADT (count)	Crash Locations Fatal, Injury, Property Damage Only, Unknown Crash Type, High Crash Locations (HCL's)	Mileage by Functional Class By Sheet 0121 5 - Major collector 1.250	Mileage by Town By Sheet ARLINGTON - S01210201 1.25 of 1.25	DISTRICT 1	TOWN ARLINGTON	Date: 10/15/17	ROUTE Maj-0121 ETE mileage: 0.0 to 1.25
Page Total Mileage: 1.250 mi						Page Total Mileage: 1.25 mi				

For More Information Contact - Vermont Agency of Transportation, Policy, Planning and Intermodal Development Division - Mapping Section, 1 National Life Drive, Montpelier, VT 05633-5001 Telephone: 802-828-2600.