



# Route Log and Progress Chart

**DRAFT**

Please Note: Errors and Omissions May Exist.  
Contact the VTrans Mapping Section with questions or concerns.

DISTRICT	TOWN	ROUTE
8	NORTH HERO	US-2

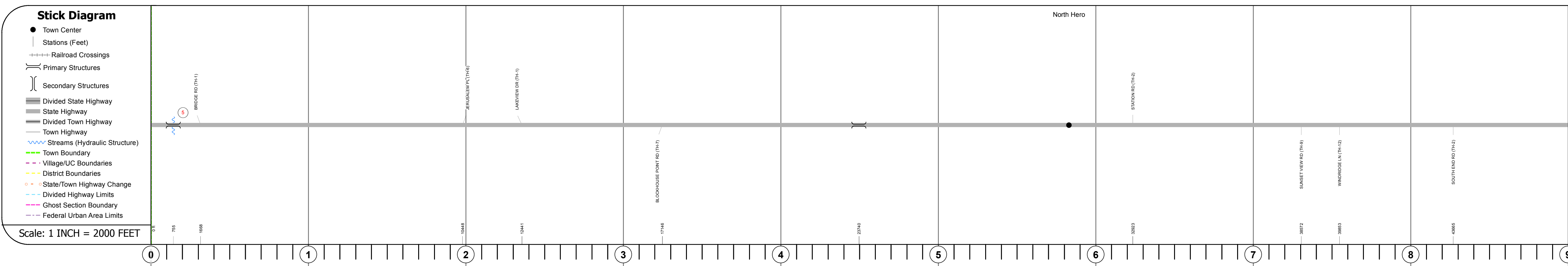
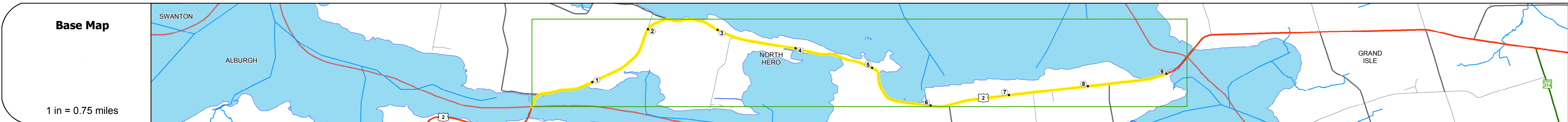
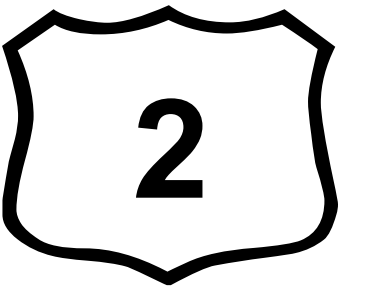
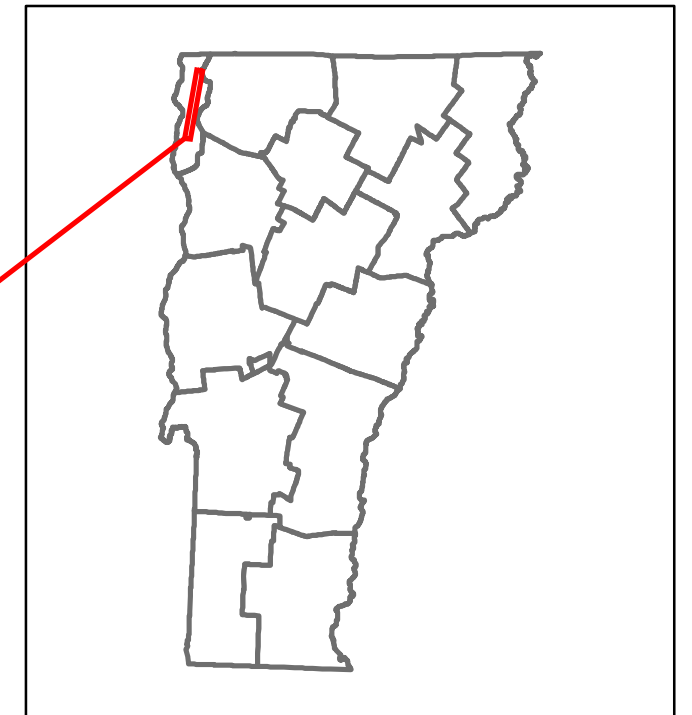

## STRUCTURE DESCRIPTIONS

Bridge 5:  
Girder and floorbeam system - 1954  
Structure No: 200028000507042  
Length: 826'  
Width: 30.0'  
Facility Carried: US 00002 ML  
Bridge Type: 7SPN 2 GIR W RB/FB  
Features Intersected: ALBURGH PASSAGE  
Surface: Bituminous  
Maintenance/Ownership: State

Road Widths	Travellane	Roadway	Lane Count	Base	Subbase

Curves	35'	3'	4.3'	5'	3'	3'	5'	6'	6'	3.3'	14'	4'	8'	6'
--------	-----	----	------	----	----	----	----	----	----	------	-----	----	----	----

Grades															
--------	--	--	--	--	--	--	--	--	--	--	--	--	--	--	--



Maintenance Garage	District 8 - Highgate Garage														
--------------------	------------------------------	--	--	--	--	--	--	--	--	--	--	--	--	--	--

Speed Zone	20	40	45	55
------------	----	----	----	----

Functional Class	4														
------------------	---	--	--	--	--	--	--	--	--	--	--	--	--	--	--

National Highway System															
-------------------------	--	--	--	--	--	--	--	--	--	--	--	--	--	--	--

Limited Access Highway															
------------------------	--	--	--	--	--	--	--	--	--	--	--	--	--	--	--

Traffic Counters	G101														G004
------------------	------	--	--	--	--	--	--	--	--	--	--	--	--	--	------

Year	2014	2013	2012	2011	2010	2014	2013	2012	2011	2010	2014	2013	2012	2011	2010
2014	2000	1900	1900	2100	2200	2700	2700	2600	2700	2800	2600	2600	2500	2600	2700

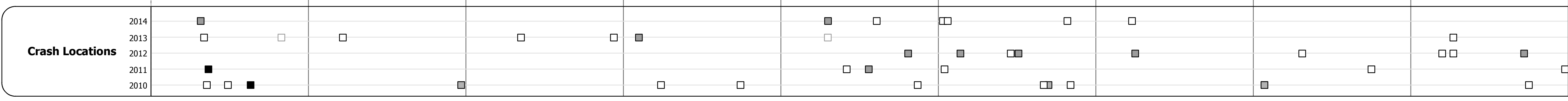

<b>Historic Projects</b> Unknown, Retreatment, Resurface, Bituminous Mix, Skinny Mix, Bituminous Seal Bituminous Concrete, Surface Treated Gravel, Cold Plane and Bituminous Concrete, Reclaimed Base and Bituminous Concrete, Concrete	<b>Functional Class</b> 1- Interstate System, 2- Other Freeways and Expressways, 3- Principal Arterial, 4- Minor Arterial, 5- Major Collector, 6- Minor Collector	<b>Curves</b> Left (segreg), Right <b>Grades</b> grade up, grade down	<b>Road Widths</b> (ft) <b>Traffic Counters</b> (counter ID)	<b>AAADT</b> (count) <b>Crash Locations</b> Fatal, Property Damage Only, Injury, Unknown Crash Type	<b>Mileage by Functional Class By Sheet</b> 028-1 4 - Minor Arterial 9.000 <b>Page Total Mileage: 9.000 mi</b>	<b>Mileage by Town By Sheet</b> NORTH HERO - U002-0704 9.0 of 9.34 <b>Page Total Mileage: 9.0 mi</b>	<b>DISTRICT</b> 8	<b>TOWN</b> NORTH HERO	<b>Date:</b> 11/12/16 <b>1 of 2</b> <b>TWN mileage:</b> 0.0 to 9.0	<b>ROUTE</b> US-2 ETE mileage: 11.732 to 20.732
---	--	--	---	--	--	--	----------------------	---------------------------	--	---

For More Information Contact - Vermont Agency of Transportation, Policy, Planning and Intermodal Development Division - Mapping Section, 1 National Life Drive, Montpelier, VT 05633-5001 Telephone: 802-828-2600.