



Route Log and Progress Chart

DRAFT

Please Note: Errors and Omissions May Exist.
Contact the VTrans Mapping Section with questions or concerns.

DISTRICT	TOWN	ROUTE
8	WOLCOTT	Maj-0324

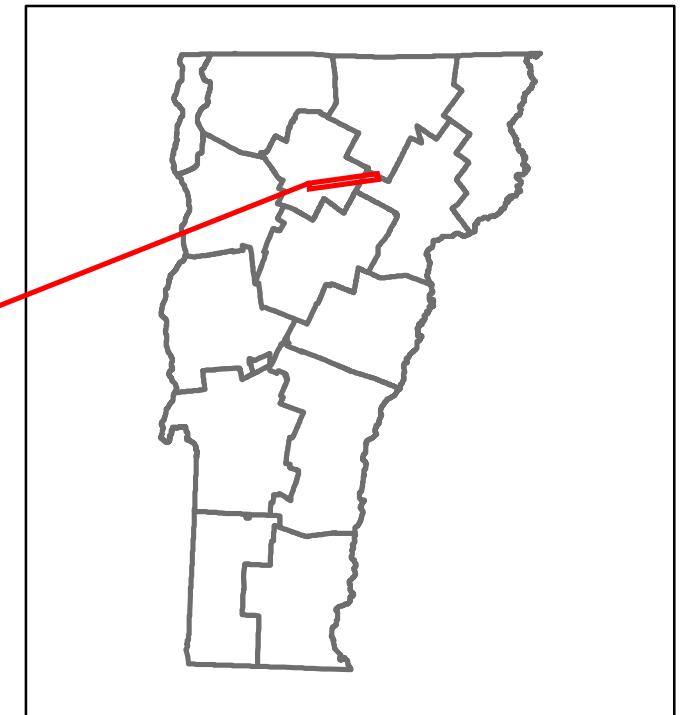

Maj-0324

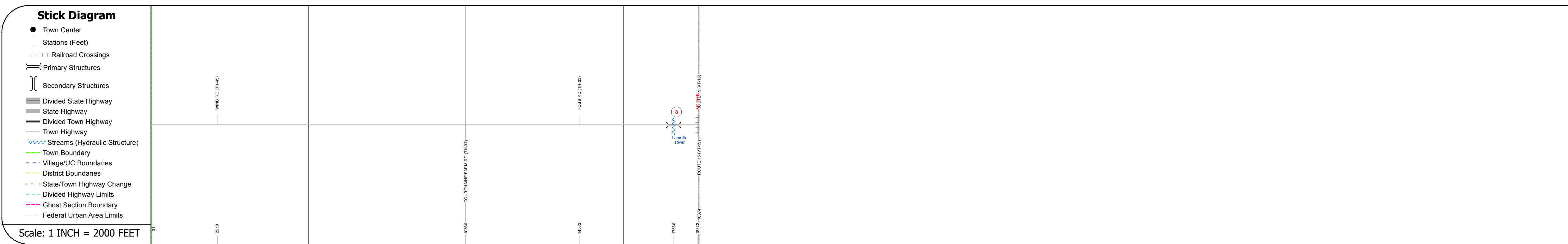

STRUCTURE DESCRIPTIONS	
Bridge 8:	Stringer/multi-beam or girder - 1984
Structure No:	100810000808101
Length:	102'
Width:	26.7'
Weight Limit:	0
Facility Carried:	C2004
Bridge Type:	WELDED GIRDER
Features Intersected:	LAMOILLE RIVER
Maintenance/Ownership:	Town

0	1	2	3
Road Widths			
Travellane		20	
Roadway		20	
Lane Count		2	
Base			
Subbase			
Curves			
Grades			
Historic Projects			
Maintenance Garage			
Speed Zone			
Functional Class 5			
National Highway System			
Limited Access Highway			
Traffic Counters L187			
AADT Counts			
2014		530	
2013		520	
2012		500	
2011		490	
2010		480	
Crash Locations			
2014			
2013			
2012			
2011			
2010			

Historic Projects	Functional Class	Curves	Road Widths	AADT	Mileage by Functional Class By Sheet	Mileage by Town By Sheet	DISTRICT	TOWN	Date: 11/11/16	ROUTE
Unknown, Retreatment, Resurface, Bituminous Mix, Skinny Mix, Bituminous Seal	1- Interstate System, 2- Other, 3- Principal Arterial, 4- Minor Arterial, 5- Major Collector, 6- Minor Collector	Left (degrees), Right	(ft)	(count)	0324 5 - Major collector 3.480	WOLCOTT - S03240810 3.48 of 3.48	8	WOLCOTT	1 of 1 ETE mileage: 0.0 to 3.88	Maj-0324 ETE mileage: 0.4 to 3.88
Indicated plans available - http://vtransmap01.ad.state.vt.us/rp/cpr/D/webstore/					Page Total Mileage: 3.480 mi		Page Total Mileage: 3.48 mi			