



Route Log and Progress Chart

DRAFT

Please Note: Errors and Omissions May Exist.
Contact the VTrans Mapping Section with questions or concerns.

DISTRICT	TOWN	ROUTE
7	ST. JOHNSBURY, WATERFORD	I-93

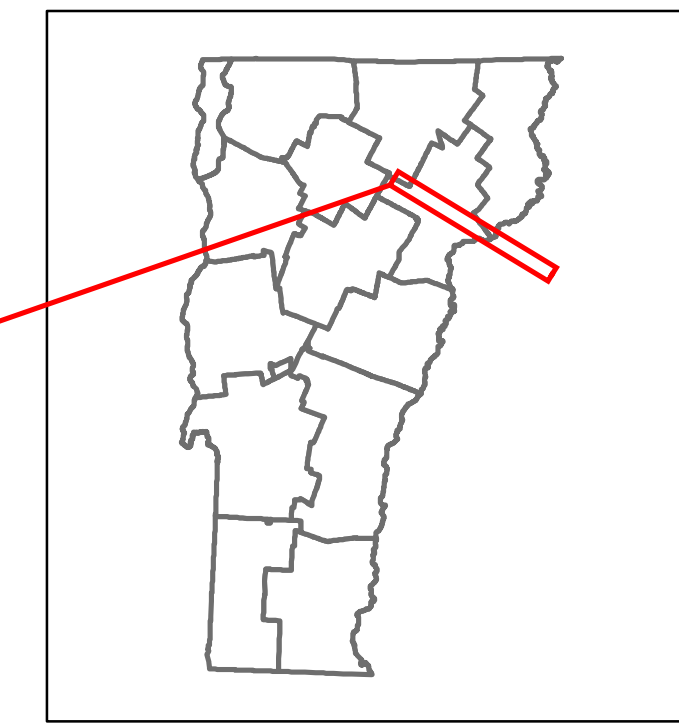

Base Map

1 in = 2 miles

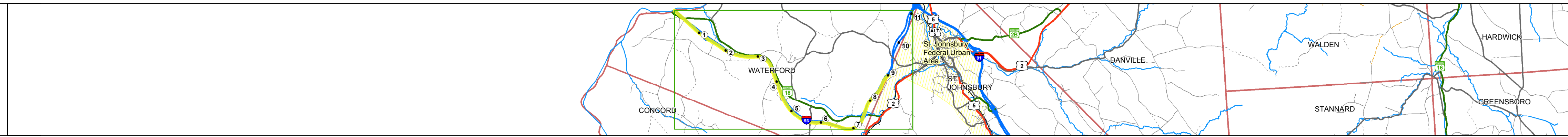

Stick Diagram

- Town Center
- Stations (Feet)
- Railroad Crossings
- Primary Structures
- Secondary Structures
- Divided State Highway
- State Highway
- Divided Town Highway
- Town Highway
- Streams (Hydraulic Structure)
- Town Boundary
- Village/UC Boundaries
- District Boundaries
- State/Town Highway Change
- Divided Highway Limits
- Ghost Section Boundary
- Federal Urban Area Limits

Scale: 1 INCH = 2000 FEET

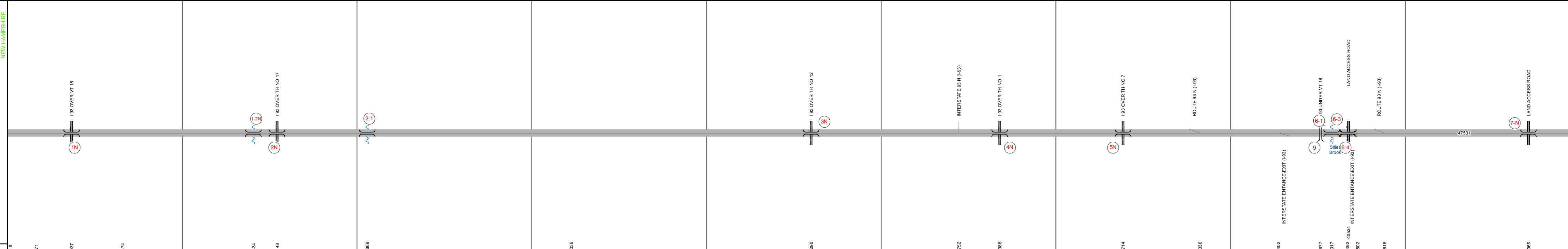

Road Widths

Station	Travellane	Roadway	Lane Count	Base	Subbase
0+00	25'	22'	2	24" Crushed Gravel Course	
1+00					
2+00					
3+00					
4+00					
5+00					
6+00					
7+00					
8+00					
9+00					

Curves

Station	Curve Data
1+00	
2+00	
3+00	
4+00	
5+00	
6+00	
7+00	
8+00	
9+00	

Grades

Station	Grade (%)
0+00	
1+00	
2+00	
3+00	
4+00	
5+00	
6+00	
7+00	
8+00	
9+00	

Historic Projects

Station	Project Description
1+00	
2+00	
3+00	
4+00	
5+00	
6+00	
7+00	
8+00	
9+00	

Maintenance Garage

Station	Garage Location
4+00	District 7 - St. Johnsbury Garage

Speed Zone

Station	Speed Limit
0+00	
1+00	
2+00	
3+00	
4+00	
5+00	
6+00	
7+00	
8+00	
9+00	

Functional Class

Station	Functional Class
0+00	1 - Interstate
1+00	1 - Interstate
2+00	1 - Interstate
3+00	1 - Interstate
4+00	1 - Interstate
5+00	1 - Interstate
6+00	1 - Interstate
7+00	1 - Interstate
8+00	1 - Interstate
9+00	1 - Interstate

National Highway System

Station	NHS Designation
0+00	NHS - Interstate
1+00	NHS - Interstate
2+00	NHS - Interstate
3+00	NHS - Interstate
4+00	NHS - Interstate
5+00	NHS - Interstate
6+00	NHS - Interstate
7+00	NHS - Interstate
8+00	NHS - Interstate
9+00	NHS - Interstate

Traffic Counters

Station	Counter ID
4+00	0201
8+00	0215

AADT Counts

Year	Station 1	Station 2	Station 3	Station 4	Station 5
2014		6100			6500
2013		6100			6200
2012		6200			5900
2011		6200			5900
2010		6100			5900

Crash Locations

Year	Station	Crash Type
2014	1+00	Property Damage Only
2014	2+00	Property Damage Only
2014	3+00	Property Damage Only
2014	4+00	Property Damage Only
2014	5+00	Property Damage Only
2014	6+00	Property Damage Only
2014	7+00	Property Damage Only
2014	8+00	Property Damage Only
2014	9+00	Property Damage Only
2013	1+00	Property Damage Only
2013	2+00	Property Damage Only
2013	3+00	Property Damage Only
2013	4+00	Property Damage Only
2013	5+00	Property Damage Only
2013	6+00	Property Damage Only
2013	7+00	Property Damage Only
2013	8+00	Property Damage Only
2013	9+00	Property Damage Only
2012	1+00	Property Damage Only
2012	2+00	Property Damage Only
2012	3+00	Property Damage Only
2012	4+00	Property Damage Only
2012	5+00	Property Damage Only
2012	6+00	Property Damage Only
2012	7+00	Property Damage Only
2012	8+00	Property Damage Only
2012	9+00	Property Damage Only
2011	1+00	Property Damage Only
2011	2+00	Property Damage Only
2011	3+00	Property Damage Only
2011	4+00	Property Damage Only
2011	5+00	Property Damage Only
2011	6+00	Property Damage Only
2011	7+00	Property Damage Only
2011	8+00	Property Damage Only
2011	9+00	Property Damage Only
2010	1+00	Property Damage Only
2010	2+00	Property Damage Only
2010	3+00	Property Damage Only
2010	4+00	Property Damage Only
2010	5+00	Property Damage Only
2010	6+00	Property Damage Only
2010	7+00	Property Damage Only
2010	8+00	Property Damage Only
2010	9+00	Property Damage Only

STRUCTURE DESCRIPTIONS

<p>Bridge 1-N: Frame - 1982 Structure No. 200093001N03162 Length: 205' Width: 36.7' Under Clearance: 16.83' Facility Carried: I 00093 ML Bridge Type: STEEL RIGID FRAME Features Intersected: I 93 OVER VT 18 Surface: Bituminous Maintenance/Ownership: State</p>	<p>Bridge 6-4: Culvert - 1982 Structure No. 30009306-403161 Length: 14' Under Clearance: 12.0' Facility Carried: I93 Bridge Type: R C BOX Features Intersected: LAND ACCESS ROAD Maintenance: State</p>
<p>Culvert 1-2N: Culvert - 1982 Structure No. 3000931-2N03161 Length: 6' Under Clearance: 6.0' Facility Carried: I93 Bridge Type: ACCCOMP Features Intersected: BROOK Maintenance: State</p>	<p>Bridge 7-N: Culvert - 1982 Structure No. 300093007N03161 Length: 14' Under Clearance: 12.0' Facility Carried: I93 Bridge Type: R C BOX Features Intersected: LAND ACCESS ROAD Maintenance: State</p>
<p>Culvert 2N: Culvert - 1982 Structure No. 200093002N03162 Length: 28' Under Clearance: 13.92' Facility Carried: I 00093 ML Bridge Type: CONCRETE BOX Features Intersected: I 93 OVER TH NO 17 Maintenance/Ownership: State</p>	<p>Culvert 2-1: Culvert - 1982 Structure No. 30009302-103161 Length: 7' Under Clearance: 7.0' Facility Carried: I93 Bridge Type: CGMPP Features Intersected: BROOK Maintenance: State</p>
<p>Bridge 3N: Stringer/multi-beam or girder - 1982 Structure No. 200093003N03162 Length: 113' Width: 36.7' Under Clearance: 15.17' Facility Carried: I 00093 ML Bridge Type: WELDED PLATE GIRDER Features Intersected: I 93 OVER TH NO 12 Surface: Bituminous Maintenance/Ownership: State</p>	<p>Culvert 4N: Culvert - 1982 Structure No. 200093004N03162 Length: 28' Under Clearance: 14.67' Facility Carried: I 00093 ML Bridge Type: CONCRETE BOX Features Intersected: I 93 OVER TH NO 1 Maintenance/Ownership: State</p>
<p>Bridge 5N: Stringer/multi-beam or girder - 1982 Structure No. 200093005N03162 Length: 109' Width: 36.7' Under Clearance: 18.5' Facility Carried: I 00093 ML Bridge Type: WELDED PLATE GIRDER Features Intersected: I 93 OVER TH NO 7 Surface: Bituminous Maintenance/Ownership: State</p>	<p>Bridge 9: Stringer/multi-beam or girder - 1982 Structure No. 20022500903162 Length: 214' Width: 51.0' Under Clearance: 16.33' Facility Carried: VT 00018 ML Bridge Type: 2 SP CONT WLD PL GIR Features Intersected: I 93 UNDER VT 18 Surface: Bituminous Maintenance/Ownership: State</p>
<p>Culvert 6-1: Culvert - 1982 Structure No. 30009306-103161 Length: 14' Under Clearance: 7.0' Facility Carried: I93 Features Intersected: STILES BROOK Maintenance: State</p>	<p>Culvert 6-3: Culvert - 1982 Structure No. 30009306-303161 Length: 9' Under Clearance: 7.0' Facility Carried: I93 Bridge Type: R C BOX Features Intersected: WATER MAIN SLEEVE Maintenance: State</p>

Historic Projects	Functional Class	Curves	Road Widths	AADT	Mileage by Functional Class By Sheet	Mileage by Town By Sheet	DISTRICT	TOWN	Date: 10/27/16	ROUTE
<ul style="list-style-type: none"> Unknown Bituminous Seal Retreatment Resurface Bituminous Mix Skimny Mix 	<ul style="list-style-type: none"> 1 - Interstate System 2 - Other 3 - Principal Arterial 4 - Minor Arterial 5 - Major Collector 6 - Minor Collector 	<ul style="list-style-type: none"> Left Right grade up grade down 	<ul style="list-style-type: none"> Width (ft) Counters (ID) 	<ul style="list-style-type: none"> Count Fatal Injury Property Damage Only Unknown Crash Type 	93-1 1 - Interstate 9.000	ETE - I093-0000 9.0 of 11.104	7	ST. JOHNSBURY, WATERFORD	1 of 2 TWN mileage: 0.0 to 9.0	I-93 ETE mileage: 0.0 to 9.0
<p>Indicated plans available - http://vtransmap01.ad.state.vt.us/rp/cpr/D/webstore/</p>					<p>Page Total Mileage: 9.000 mi</p>		<p>Page Total Mileage: 9.0 mi</p>		<p>For More Information Contact - Vermont Agency of Transportation, Policy, Planning and Intermodal Development Division - Mapping Section, 1 National Life Drive, Montpelier, VT 05633-5001 Telephone: 802-828-2600.</p>	