



# Route Log and Progress Chart

DRAFT

Please Note: Errors and Omissions May Exist.  
Contact the VTrans Mapping Section with questions or concerns.

DISTRICT	TOWN	ROUTE
7	BRADFORD, NEWBURY	I-91

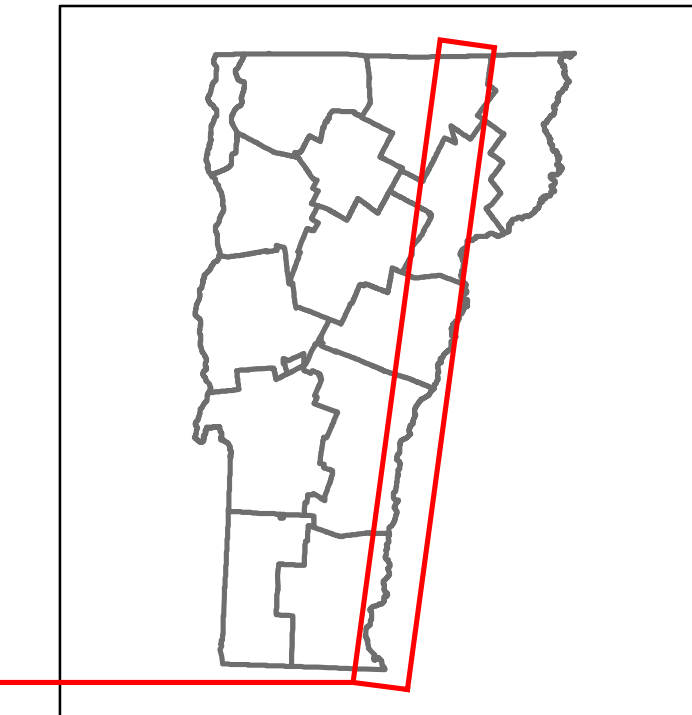

**Base Map**

1 in = 7 miles

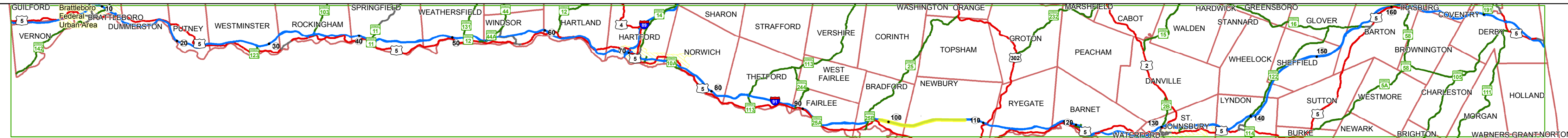

**Stick Diagram**

- Town Center
- Stations (Feet)
- Railroad Crossings
- Primary Structures
- Secondary Structures
- Divided State Highway
- State Highway
- Divided Town Highway
- Town Highway
- Streams (Hydraulic Structure)
- Town Boundary
- Village/UC Boundaries
- District Boundaries
- State/Town Highway Change
- Divided Highway Limits
- Ghost Section Boundary
- Federal Urban Area Limits

Scale: 1 INCH = 2000 FEET

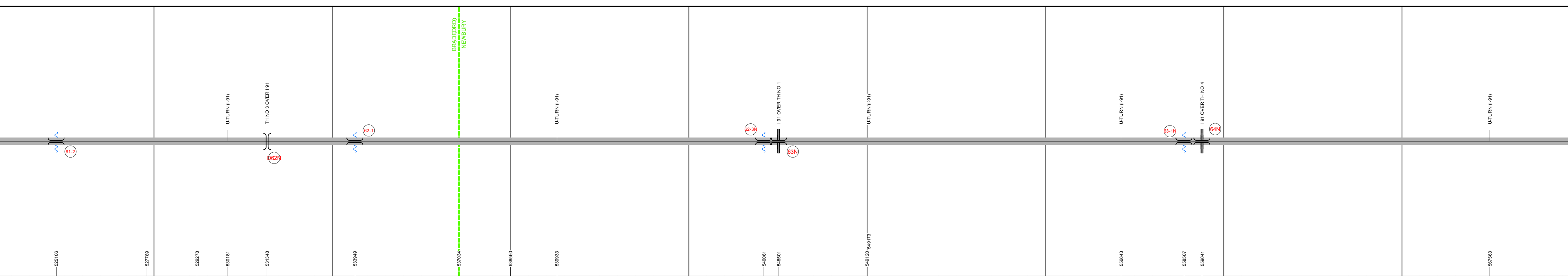

**Road Widths**

Travellane	
Roadway	
Lane Count	
Base	
Subbase	

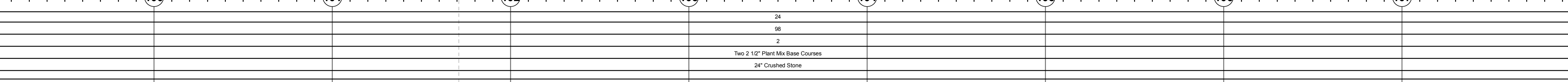

**Curves**



**Grades**



**Historic Projects**

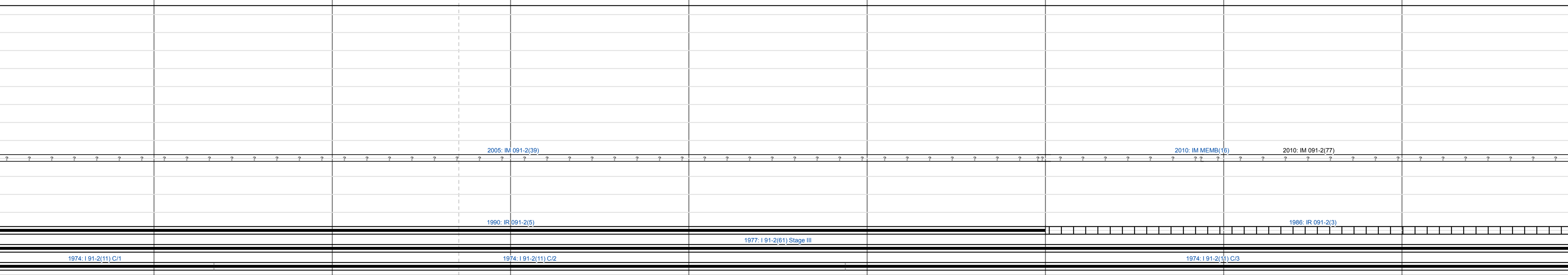

**Maintenance Garage**



**Speed Zone**

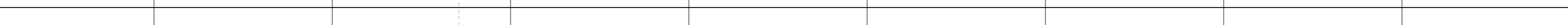

**Functional Class**

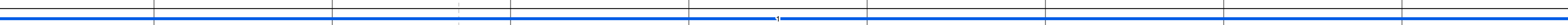

**National Highway System**

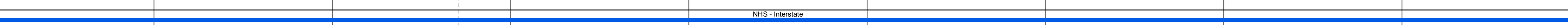

**Traffic Counters**

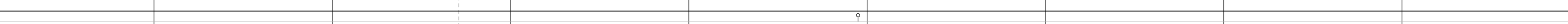

**AADT Counts**

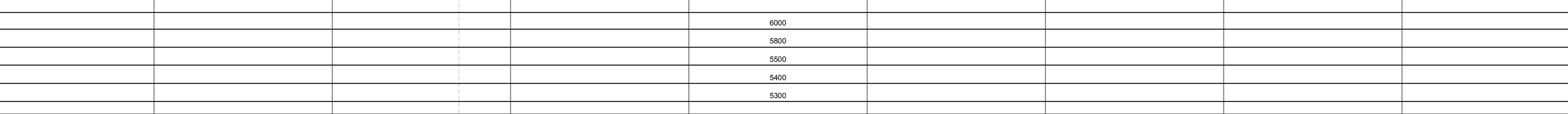

**Crash Locations**

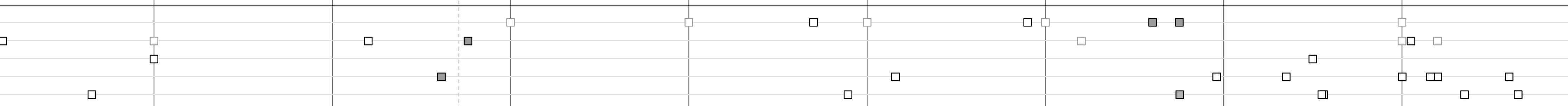

## STRUCTURE DESCRIPTIONS

<p><b>Culvert 61-2:</b> Culvert - 1972 Structure No. 30009161-209011 Length: 7' Under Clearance: 8.0' Facility Carried: I91 Bridge Type: CGMPP Features Intersected: BROOK Maintenance: State</p>
<p><b>Bridge D62N:</b> Stringer/multi-beam or girder - 1973 Structure No. 200901D62N09011 Length: 132' Width: 26.6' Under Clearance: 16.75' Facility Carried: TR 00TH3 Bridge Type: WELDED PLATE GIRDER Features Intersected: TH NO 3 OVER I 91 Surface: Bituminous Maintenance/Ownership: State</p>
<p><b>Culvert 62-1:</b> Culvert - 1972 Structure No. 30009162-109011 Length: 17' Under Clearance: 8.0' Facility Carried: I91 Bridge Type: R C BOX Features Intersected: ROARING BROOK Maintenance: State</p>
<p><b>Culvert 62-3N:</b> Culvert - 1974 Structure No. 300091623N09071 Length: 10' Under Clearance: 10.0' Facility Carried: I91 Bridge Type: C.G.M.P.P. Features Intersected: HALLS BROOK Maintenance: State</p>
<p><b>Bridge 63N:</b> Stringer/multi-beam or girder - 1973 Structure No. 200091063N09072 Length: 105' Width: 39.5' Under Clearance: 14.17' Facility Carried: I 00091 ML Bridge Type: WELDED PLATE GIRDER Features Intersected: I 91 OVER TH NO 1 Surface: Bituminous Maintenance/Ownership: State</p>
<p><b>Culvert 63-1N:</b> Culvert - 1973 Structure No. 300091631N09071 Length: 18' Under Clearance: 12.0' Facility Carried: I91 Bridge Type: C.G.M.P.A. Features Intersected: PEACH BROOK Maintenance: State</p>
<p><b>Bridge 64N:</b> Stringer/multi-beam or girder - 1973 Structure No. 200091064N09072 Length: 99' Width: 36.6' Under Clearance: 14.67' Facility Carried: I 00091 ML Bridge Type: WELDED PLATE GIRDER Features Intersected: I 91 OVER TH NO 4 Surface: Bituminous Maintenance/Ownership: State</p>

<p><b>Historic Projects</b></p> <ul style="list-style-type: none"> <li>Unknown</li> <li>Bituminous Seal</li> <li>Retreatment</li> <li>Resurface</li> <li>Bituminous Mix</li> <li>Skimny Mix</li> <li>Gravel</li> <li>Surface Treated Gravel</li> <li>Plant Mix</li> <li>Reclaimed Base and Expressways</li> <li>Bituminous Concrete</li> <li>Concrete</li> </ul>	<p><b>Functional Class</b></p> <ul style="list-style-type: none"> <li>1 - Interstate</li> <li>2 - Other</li> <li>3 - Principal Arterial</li> <li>4 - Minor Arterial</li> <li>5 - Major Collector</li> <li>6 - Minor Collector</li> </ul>	<p><b>Curves</b></p> <ul style="list-style-type: none"> <li>Left</li> <li>Right</li> </ul>	<p><b>Road Widths</b></p> <p>(ft)</p>	<p><b>AADT</b></p> <p>(count)</p>	<p><b>Mileage by Functional Class By Sheet</b></p> <p>91-2 1 - Interstate 9.000</p>	<p><b>Mileage by Town By Sheet</b></p> <p>ETE - I091-0000 9.0 of 177.432</p>	<p><b>DISTRICT</b></p> <p>7</p>	<p><b>TOWN</b></p> <p>BRADFORD, NEWBURY</p>	<p><b>Date: 10/26/16</b></p> <p>12 of 20 TWN mileage: 99.0 to 108.0</p>	<p><b>ROUTE</b></p> <p>I-91</p> <p>ETE mileage: 99.0 to 108.0</p>
--	--	--	---------------------------------------	-----------------------------------	---	--	---------------------------------	---	---	---

Indicated plans available - <http://vtransmap01.ad.state.vt.us/rp/dpr/DWebstore/>

Page Total Mileage: 9.000 mi

Page Total Mileage: 9.0 mi