



# Route Log and Progress Chart

**DRAFT**

Please Note: Errors and Omissions May Exist.  
Contact the VTrans Mapping Section with questions or concerns.

DISTRICT	TOWN	ROUTE
2	ROCKINGHAM, SPRINGFIELD	I-91

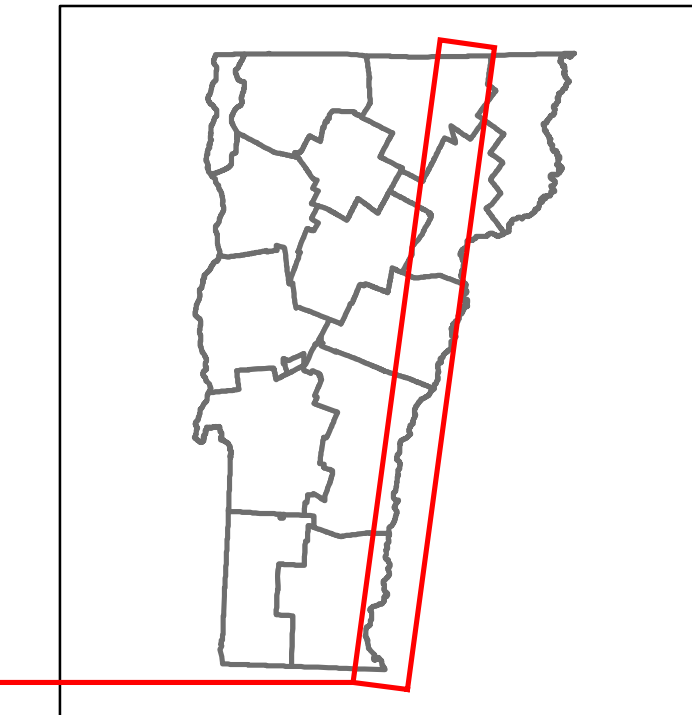

**Base Map**

1 in = 7 miles

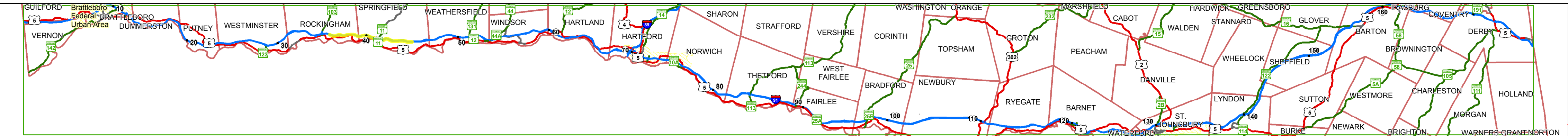

**Stick Diagram**

- Town Center
- Stations (Feet)
- Railroad Crossings
- Primary Structures
- Secondary Structures
- Divided State Highway
- State Highway
- Divided Town Highway
- Town Highway
- Streams (Hydraulic Structure)
- Town Boundary
- Village/UC Boundaries
- District Boundaries
- State/Town Highway Change
- Divided Highway Limits
- Ghost Section Boundary
- Federal Urban Area Limits

Scale: 1 INCH = 2000 FEET

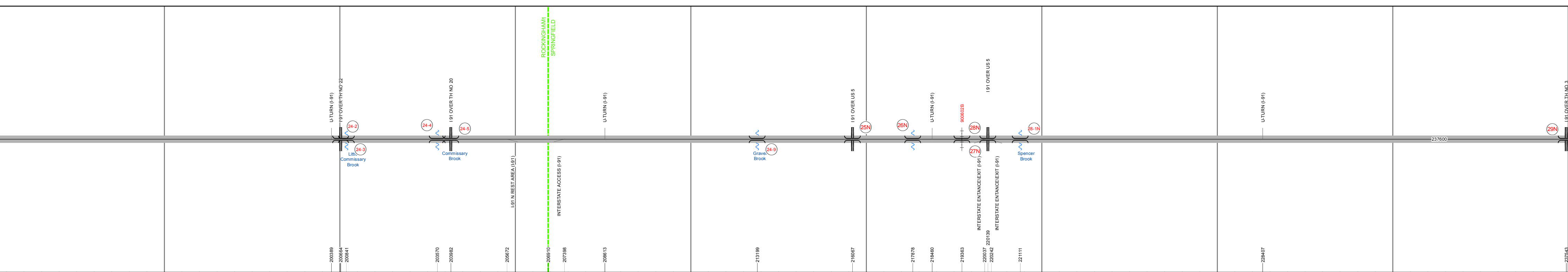

## STRUCTURE DESCRIPTIONS

**Culvert 24-2:**  
Culvert - 1965  
Structure No. 20009124-213142  
Length: 21'  
Under Clearance: 13.0'  
Facility Carried: I 00091 ML  
Bridge Type: REINFORCED CONC. BOX  
Features Intersected: I 91 OVER TH NO 22  
Maintenance/Ownership: State

**Culvert 24-3:**  
Culvert - 1965  
Structure No. 30009124-313141  
Length: 6'  
Under Clearance: 6.0'  
Facility Carried: I91  
Bridge Type: CGMPP  
Features Intersected: BROOK  
Maintenance: State

**Culvert 24-4:**  
Culvert - 1965  
Structure No. 30009124-413141  
Length: 8'  
Under Clearance: 9.0'  
Facility Carried: I91  
Bridge Type: CGMPP  
Features Intersected: BROOK  
Maintenance: State

**Culvert 24-5:**  
Culvert - 1965  
Structure No. 20009124-513142  
Length: 21'  
Under Clearance: 12.92'  
Facility Carried: I 00091 ML  
Bridge Type: REINFORCED CONC BOX  
Features Intersected: I 91 OVER TH NO 20  
Maintenance/Ownership: State

**Culvert 24-9:**  
Culvert - 1965  
Structure No. 30009124-914181  
Length: 7'  
Under Clearance: 8.0'  
Facility Carried: I91  
Bridge Type: CGMPP  
Features Intersected: BROOK  
Maintenance: State

**Bridge 25N:**  
Stringer/multi-beam or girder - 1965  
Structure No. 200091025N14182  
Length: 231'  
Width: 30.0'  
Under Clearance: 17.42'  
Facility Carried: I 00091 ML  
Bridge Type: 3 SP CONT ROLLED BM  
Features Intersected: I 91 OVER US 5  
Surface: Bituminous  
Maintenance/Ownership: State

**Bridge 26N:**  
Stringer/multi-beam or girder - 1965  
Structure No. 200091026N14182  
Length: 316'  
Width: 30.0'  
Facility Carried: I 00091 ML  
Bridge Type: 3 SP CONT WLD GIRDER  
Features Intersected: BLACK RIVER  
Surface: Bituminous  
Maintenance/Ownership: State

**Bridge 27N:**  
Stringer/multi-beam or girder - 1965  
Structure No. 200091027N14182  
Length: 74'  
Width: 38.0'  
Facility Carried: I 00091 ML  
Bridge Type: ROLLED BEAM  
Features Intersected: BIKE PATH  
Surface: Bituminous  
Maintenance/Ownership: State

**Bridge 28N:**  
Stringer/multi-beam or girder - 1965  
Structure No. 200091028N14182  
Length: 202'  
Width: 42.0'  
Under Clearance: 14.92'  
Facility Carried: I 00091 ML  
Bridge Type: 4 SP CONT ROLLED BM  
Features Intersected: I 91 OVER US 5  
Surface: Bituminous  
Maintenance/Ownership: State

**Culvert 28-1N:**  
Culvert - 1965  
Structure No. 300091281N14181  
Length: 13'  
Under Clearance: 11.0'  
Facility Carried: I91  
Bridge Type: RC BOX  
Features Intersected: SPENCER BROOK  
Maintenance: State

**Road Widths**

Travellane	
Roadway	
Lane Count	
Base	
Subbase	

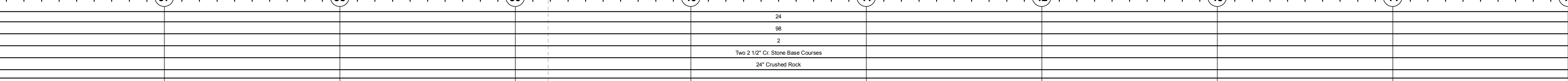

**Curves**

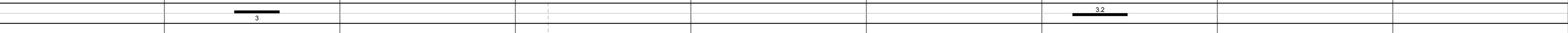

**Grades**



**Historic Projects**

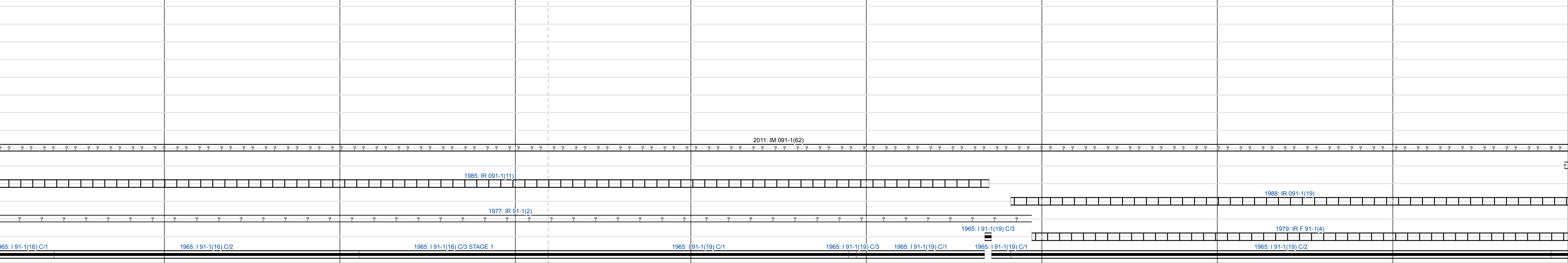

**Maintenance Garage**



**Speed Zone**

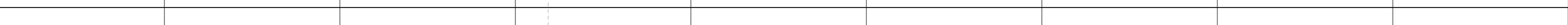

**Functional Class**

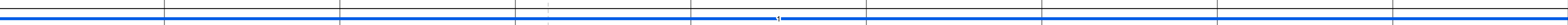

**National Highway System**

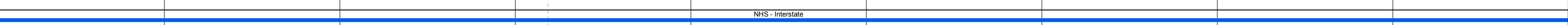

**Traffic Counters**

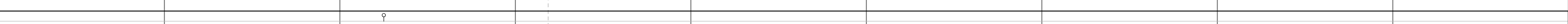

**AADT Counts**

2014		13300		11800
2013		12100		11000
2012		10900		10200
2011		11700		11000
2010		12500		11800

**Crash Locations**

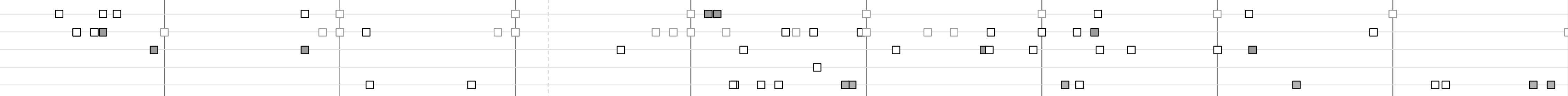

<p><b>Historic Projects</b></p> <ul style="list-style-type: none"> <li>Unknown</li> <li>Bituminous Seal</li> <li>Retreatment</li> <li>Resurface</li> <li>Bituminous Mix</li> <li>Skimny Mix</li> </ul>	<p><b>Functional Class</b></p> <ul style="list-style-type: none"> <li>1 - Interstate System</li> <li>2 - Other</li> <li>3 - Principal Arterial</li> <li>4 - Minor Arterial</li> <li>5 - Major Collector</li> <li>6 - Minor Collector</li> </ul> <p><b>Speed Zones</b></p> <ul style="list-style-type: none"> <li>25</li> <li>30</li> <li>35</li> <li>40</li> <li>45</li> <li>50</li> <li>55</li> <li>60</li> <li>65</li> </ul>	<p><b>Curves</b></p> <ul style="list-style-type: none"> <li>Left</li> <li>Right</li> </ul> <p><b>Grades</b></p> <ul style="list-style-type: none"> <li>grade up</li> <li>grade down</li> </ul>	<p><b>Road Widths</b></p> <p>(ft)</p>	<p><b>Traffic Counters</b></p> <p>(counter ID)</p>	<p><b>Crash Locations</b></p> <ul style="list-style-type: none"> <li>Fatal</li> <li>Injury</li> <li>Property Damage Only</li> <li>Unknown Crash Type</li> </ul>	<p><b>Mileage by Functional Class By Sheet</b></p> <p>91-1 1 - Interstate 9.000</p>	<p><b>Mileage by Town By Sheet</b></p> <p>ETE - I091-0000 9.0 of 177.432</p>	<p><b>DISTRICT</b></p> <p>2</p>	<p><b>TOWN</b></p> <p>ROCKINGHAM, SPRINGFIELD</p>	<p><b>Date: 10/26/16</b></p>	<p><b>ROUTE</b></p> <p>I-91</p> <p>ETE mileage: 36.0 to 45.0</p>
--	--	--	---------------------------------------	--	---	---	--	---------------------------------	---	------------------------------	--

Page Total Mileage: 9.000 mi

Page Total Mileage: 9.0 mi