



Route Log and Progress Chart

DRAFT

Please Note: Errors and Omissions May Exist.
Contact the VTrans Mapping Section with questions or concerns.

DISTRICT	TOWN	ROUTE
7	BRADFORD, NEWBURY	I-91

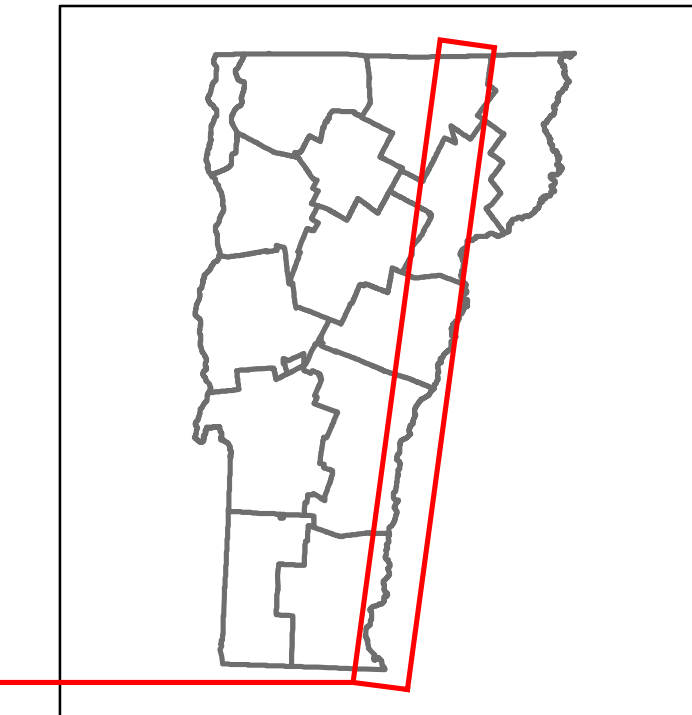

Base Map

1 in = 7 miles

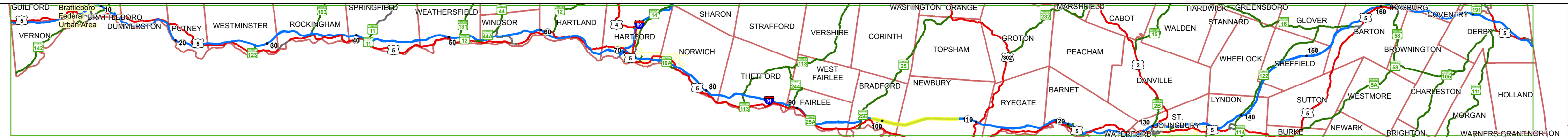

Stick Diagram

- Town Center
- Stations (Feet)
- Railroad Crossings
- Primary Structures
- Secondary Structures
- Divided State Highway
- State Highway
- Divided Town Highway
- Town Highway
- Streams (Hydraulic Structure)
- Town Boundary
- Village/UC Boundaries
- District Boundaries
- State/Town Highway Change
- Divided Highway Limits
- Ghost Section Boundary
- Federal Urban Area Limits

Scale: 1 INCH = 2000 FEET

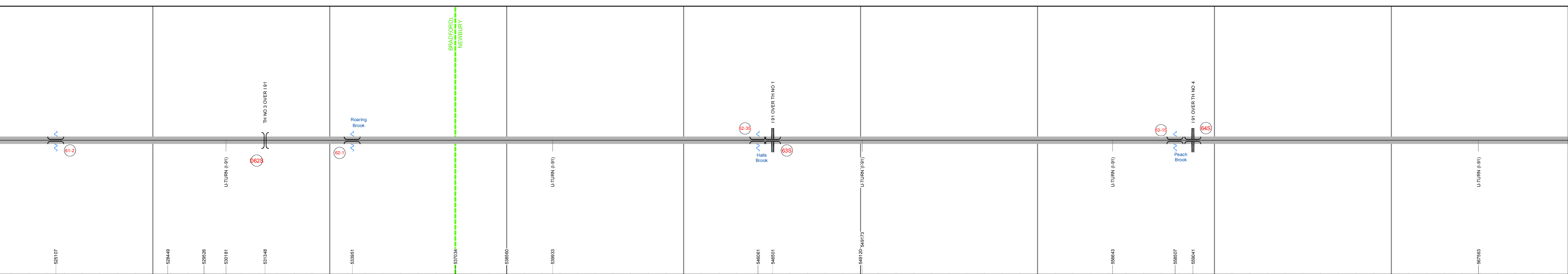

Road Widths

Travellane	24
Roadway	98
Lane Count	2
Base	Two 2 1/2" Plant Mix Base Courses
Subbase	24" Crushed Stone

Curves

Grades

Station 100.00	+5
Station 101.00	+3.2
Station 102.00	-4.4
Station 103.00	+5
Station 104.00	-4.6
Station 105.00	+4.8
Station 106.00	+5.1

Historic Projects

Station 100.00	1974 I 91-2(11)C1
Station 101.00	1974 I 91-2(11)C2
Station 102.00	1990 R 091-2(5)
Station 103.00	1977 I 91-2(61) Stage III
Station 104.00	1974 I 91-2(10)C3
Station 105.00	2010 RR MEMB(19)
Station 106.00	1996 R 091-2(3)

Maintenance Garage

District 7 - Bradford Garage

Speed Zone

Functional Class

1 - Interstate

National Highway System

NHS - Interstate

Traffic Counters

AADT Counts

Year	2014	2013	2012	2011	2010
Count					

Crash Locations

Year	2014	2013	2012	2011	2010
Location					

STRUCTURE DESCRIPTIONS

Culvert 61-2:
Culvert - 1972
Structure No. 30009161-209011
Length: 7'
Under Clearance: 8.0'
Facility Carried: I91
Bridge Type: CGMPP
Features Intersected: BROOK
Maintenance: State

Bridge D62S:
Stringer/multi-beam or girder - 1973
Structure No. 200901D62S09011
Length: 132'
Width: 26.6'
Under Clearance: 16.75'
Facility Carried: TR 00TH3
Bridge Type: WELDED PLATE GIRDER
Features Intersected: TH NO 3 OVER I 91
Surface: Bituminous
Maintenance/Ownership: State

Culvert 62-1:
Culvert - 1972
Structure No. 30009162-109011
Length: 17'
Under Clearance: 8.0'
Facility Carried: I91
Bridge Type: R C BOX
Features Intersected: ROARING BROOK
Maintenance: State

Culvert 62-3S:
Culvert - 1974
Structure No. 300091623S09071
Length: 10'
Under Clearance: 10.0'
Facility Carried: I91
Bridge Type: C.G.M.P.P.
Features Intersected: HALLS BROOK
Maintenance: State

Bridge 63S:
Stringer/multi-beam or girder - 1973
Structure No. 200091063S09072
Length: 105'
Width: 39.3'
Under Clearance: 13.83'
Facility Carried: I 00091 ML
Bridge Type: WELDED PLATE GIRDER
Features Intersected: I 91 OVER TH NO 1
Surface: Bituminous
Maintenance/Ownership: State

Culvert 63-1S:
Culvert - 1973
Structure No. 300091631S09071
Length: 18'
Under Clearance: 12.0'
Facility Carried: I91
Bridge Type: C.G.M.P.A.
Features Intersected: PEACH BROOK
Maintenance: State

Bridge 64S:
Stringer/multi-beam or girder - 1973
Structure No. 200091064S09072
Length: 128'
Width: 36.6'
Under Clearance: 14.0'
Facility Carried: I 00091 ML
Bridge Type: WELDED PLATE GIRDER
Features Intersected: I 91 OVER TH NO 4
Surface: Bituminous
Maintenance/Ownership: State

<p>Historic Projects</p> <ul style="list-style-type: none"> Unknown Bituminous Seal Retreatment Resurface Bituminous Mix Bituminous Concrete Skinny Mix Gravel Surface Treated Gravel Plant Mix Reclaimed Base and Expressways Bituminous Concrete Concrete 	<p>Functional Class</p> <ul style="list-style-type: none"> 1 - Interstate System 2 - Other 3 - Principal Arterial 4 - Minor Arterial 5 - Major Collector 6 - Minor Collector Freeways and Expressways 	<p>Curves</p> <ul style="list-style-type: none"> Left (degrees) Right 	<p>Road Widths</p> <p>(ft)</p>	<p>AADT</p> <p>(count)</p>	<p>Mileage by Functional Class By Sheet</p> <p>91-2 1 - Interstate 9.000</p>	<p>Mileage by Town By Sheet</p> <p>ETE - I091-0000S 9.0 of 177.432</p>	<p>DISTRICT</p> <p>7</p>	<p>TOWN</p> <p>BRADFORD, NEWBURY</p>	<p>Date: 10/26/16</p> <p>12 of 20 TWN mileage: 99.0 to 108.0</p>	<p>ROUTE</p> <p>I-91</p> <p>ETE mileage: 99.0 to 108.0</p>
---	---	--	---------------------------------------	-----------------------------------	---	---	---------------------------------	---	--	---

Indicated plans available - <http://vtransmap01.ad.state.vt.us/rp/dpr/DWebstore/>

For More Information Contact - Vermont Agency of Transportation, Policy, Planning and Intermodal Development Division - Mapping Section, 1 National Life Drive, Montpelier, VT 05633-5001 Telephone: 802-828-2600.