

DISTRICT	TOWN	ROUTE
2	ROCKINGHAM, SPRINGFIELD	I-91

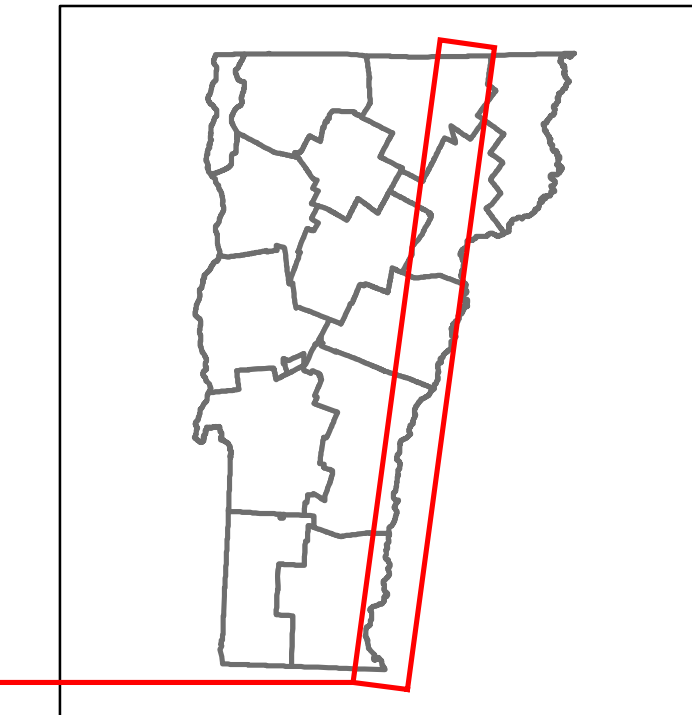

**Base Map**

1 in = 7 miles

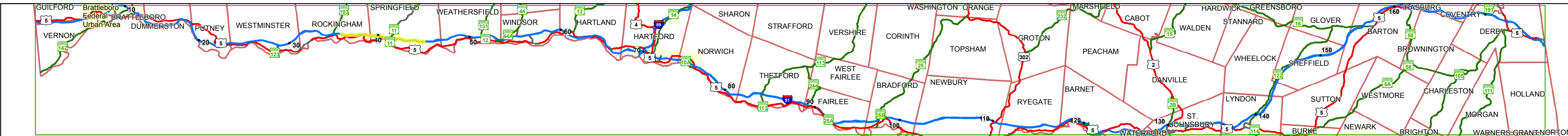

**Stick Diagram**

- Town Center
- Stations (Feet)
- Railroad Crossings
- Primary Structures
- Secondary Structures
- Divided State Highway
- State Highway
- Divided Town Highway
- Town Highway
- Streams (Hydraulic Structure)
- Town Boundary
- Village/UC Boundaries
- District Boundaries
- State/Town Highway Change
- Divided Highway Limits
- Ghost Section Boundary
- Federal Urban Area Limits

Scale: 1 INCH = 2000 FEET

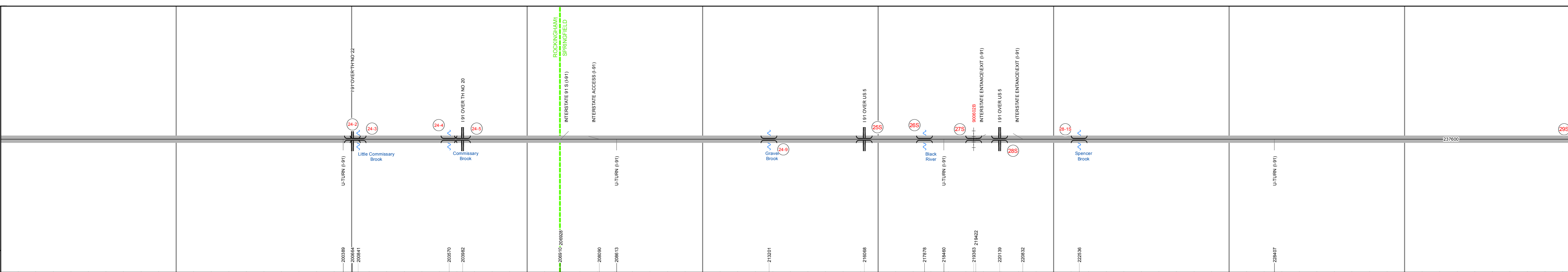

Station	6	37	38	39	40	41	42	43	44	4	
<b>Road Widths</b>	Travellane: 24 Roadway: 98 Lane Count: 2 Base: Two 2 1/2" Cr. Gravel Plant Mix Base Courses Subbase: 24" Crushed Rock										
<b>Curves</b>	3										
<b>Grades</b>	+6, +4.5, -4.8, +5, +5, +6, -5, -5, +3.7, +2.4, +5, +2, +5.8, -2.8										

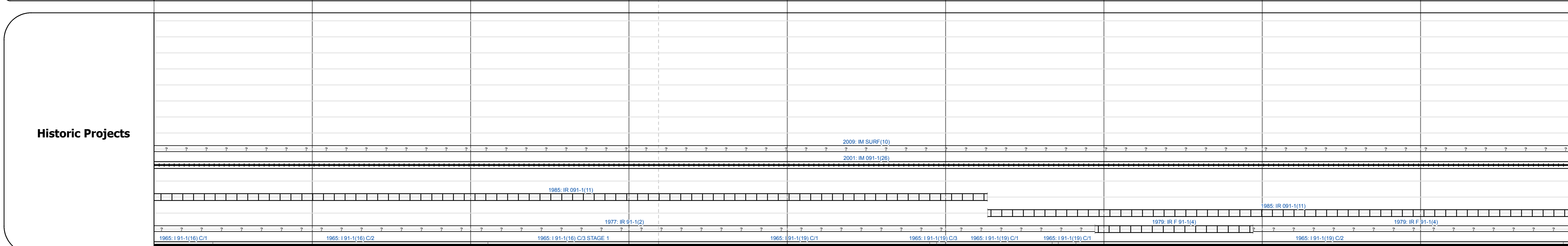

<b>Maintenance Garage</b>	District 2 - Rockingham Garage										
<b>Speed Zone</b>											
<b>Functional Class</b>	1										
<b>National Highway System</b>	NHS - Interstate										

<b>Traffic Counters</b>											
<b>ADT Counts</b>	2014 2013 2012 2011 2010										
<b>Crash Locations</b>	2014 2013 2012 2011 2010										

**STRUCTURE DESCRIPTIONS**

<p><b>Culvert 24-2:</b> Culvert - 1965 Structure No. 20009124-213142 Length: 21' Under Clearance: 13.0' Facility Carried: I 00091 ML Bridge Type: REINFORCED CONC. BOX Features Intersected: I 91 OVER TH NO 22 Maintenance/Ownership: State</p>	<p><b>Bridge 29S:</b> Stringer/multi-beam or girder - 1965 Structure No. 200091029S14182 Length: 123' Width: 36.0' Under Clearance: 14.0' Facility Carried: I 00091 ML Bridge Type: 3 SP CONT ROLLED BM Features Intersected: I 91 OVER TH NO 3 Surface: Bituminous Maintenance/Ownership: State</p>
<p><b>Culvert 24-3:</b> Culvert - 1965 Structure No. 30009124-313141 Length: 6' Under Clearance: 6.0' Facility Carried: I 91 Bridge Type: CGMPP Features Intersected: BROOK Maintenance: State</p>	<p><b>Culvert 24-4:</b> Culvert - 1965 Structure No. 30009124-413141 Length: 8' Under Clearance: 9.0' Facility Carried: I 91 Bridge Type: CGMPP Features Intersected: BROOK Maintenance: State</p>
<p><b>Culvert 24-5:</b> Culvert - 1965 Structure No. 20009124-513142 Length: 21' Under Clearance: 12.92' Facility Carried: I 00091 ML Bridge Type: REINFORCED CONC BOX Features Intersected: I 91 OVER TH NO 20 Maintenance/Ownership: State</p>	<p><b>Culvert 24-9:</b> Culvert - 1965 Structure No. 30009124-914181 Length: 7' Under Clearance: 8.0' Facility Carried: I 91 Bridge Type: CGMPP Features Intersected: BROOK Maintenance: State</p>
<p><b>Bridge 25S:</b> Stringer/multi-beam or girder - 1965 Structure No. 200091025S14182 Length: 211' Width: 30.0' Under Clearance: 14.25' Facility Carried: I 00091 ML Bridge Type: 3 SP CONT ROLLED BM Features Intersected: I 91 OVER US 5 Surface: Bituminous Maintenance/Ownership: State</p>	<p><b>Bridge 26S:</b> Stringer/multi-beam or girder - 1965 Structure No. 200091026S14182 Length: 316' Width: 30.0' Facility Carried: I 00091 ML Bridge Type: 3 SP CONT WLD GIRDER Features Intersected: BLACK RIVER Surface: Bituminous Maintenance/Ownership: State</p>
<p><b>Bridge 27S:</b> Stringer/multi-beam or girder - 1965 Structure No. 200091027S14182 Length: 74' Width: 42.0' Facility Carried: I 00091 ML Bridge Type: ROLLED BEAM Features Intersected: BIKE PATH Surface: Bituminous Maintenance/Ownership: State</p>	<p><b>Bridge 28S:</b> Stringer/multi-beam or girder - 1965 Structure No. 200091028S14182 Length: 207' Width: 30.0' Under Clearance: 17.33' Facility Carried: I 00091 ML Bridge Type: 4 SP CONT ROLLED BM Features Intersected: I 91 OVER US 5 Surface: Bituminous Maintenance/Ownership: State</p>
<p><b>Culvert 28-1S:</b> Culvert - 1965 Structure No. 300091281S14181 Length: 13' Facility Carried: I-91 Bridge Type: RC BOX Features Intersected: SPENCER BROOK Maintenance: State</p>	

<p><b>Historic Projects</b></p> <ul style="list-style-type: none"> <li>Unknown</li> <li>Bituminous Seal</li> <li>Resurfacing</li> <li>Bituminous Concrete</li> <li>Bituminous Macadam</li> <li>Bituminous Mix</li> <li>Cold Plane and Skimmy Mix</li> <li>Gravel</li> <li>Surface Treated Gravel</li> <li>Plant Mix</li> <li>Reclaimed Base and Bituminous Concrete</li> <li>Concrete</li> </ul>	<p><b>Functional Class</b></p> <ul style="list-style-type: none"> <li>1 - Interstate System</li> <li>2 - Other</li> <li>3 - Principal Arterial</li> <li>4 - Minor Arterial</li> <li>5 - Major Collector</li> <li>6 - Minor Collector</li> <li>Freeways and Expressways</li> </ul>	<p><b>Curves</b></p> <ul style="list-style-type: none"> <li>Left</li> <li>Right</li> </ul>	<p><b>Road Widths</b></p> <p>(ft)</p>	<p><b>Traffic Counters</b></p> <p>(counter ID)</p>	<p><b>Crash Locations</b></p> <ul style="list-style-type: none"> <li>Fatal</li> <li>Injury</li> <li>Property Damage Only</li> <li>Unknown Crash Type</li> </ul>	<p><b>AADT</b></p> <p>(count)</p>	<p><b>Mileage by Functional Class By Sheet</b></p> <p>91-1 1 - Interstate 9.000</p>	<p><b>Mileage by Town By Sheet</b></p> <p>ETE - I091-0000S 9.0 of 177.432</p>	<p><b>DISTRICT</b></p> <p>2</p>	<p><b>TOWN</b></p> <p>ROCKINGHAM, SPRINGFIELD</p>	<p><b>Date:</b> 10/26/16</p>	<p><b>ROUTE</b></p> <p>I-91</p> <p>ETE mileage: 36.0 to 45.0</p>
<p>Indicated plans available - <a href="http://vtransmap01.aot.state.vt.us/rp/cpr/DWebstor/">http://vtransmap01.aot.state.vt.us/rp/cpr/DWebstor/</a></p>							<p>Page Total Mileage: 9.000 mi</p>	<p>Page Total Mileage: 9.0 mi</p>	<p><b>5 of 20</b></p> <p>TWN mileage: 36.0 to 45.0</p>			