



Route Log and Progress Chart

DRAFT

Please Note: Errors and Omissions May Exist.
Contact the VTrans Mapping Section with questions or concerns.

DISTRICT	TOWN	ROUTE
4	ROYALTON, BETHEL, RANDOLPH	I-89

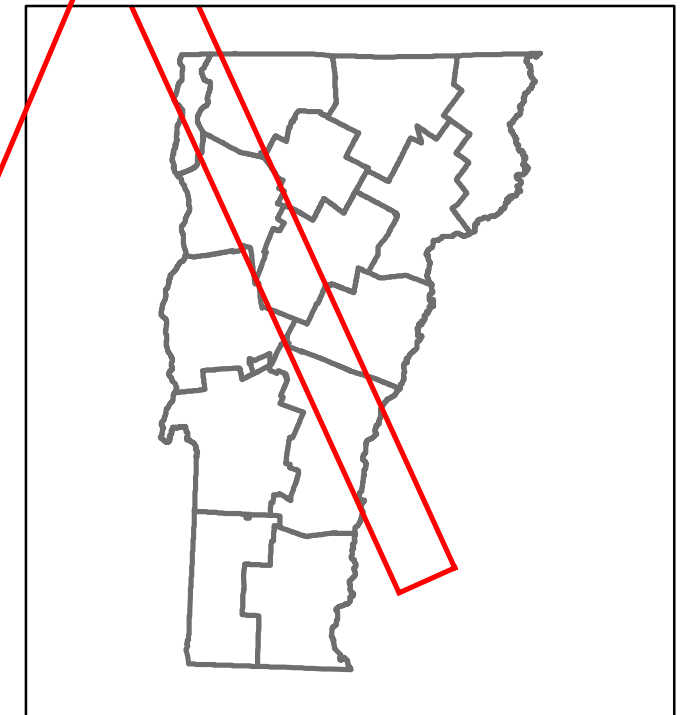

Base Map

1 in = 7.8 miles

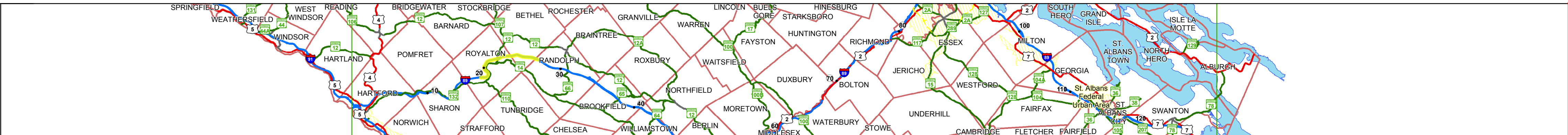

Stick Diagram

- Town Center
- Stations (Feet)
- Railroad Crossings
- Primary Structures
- Secondary Structures
- Divided State Highway
- State Highway
- Divided Town Highway
- Town Highway
- Streams (Hydraulic Structure)
- Town Boundary
- Village/UC Boundaries
- District Boundaries
- State/Town Highway Change
- Divided Highway Limits
- Ghost Section Boundary
- Federal Urban Area Limits

Scale: 1 INCH = 2000 FEET

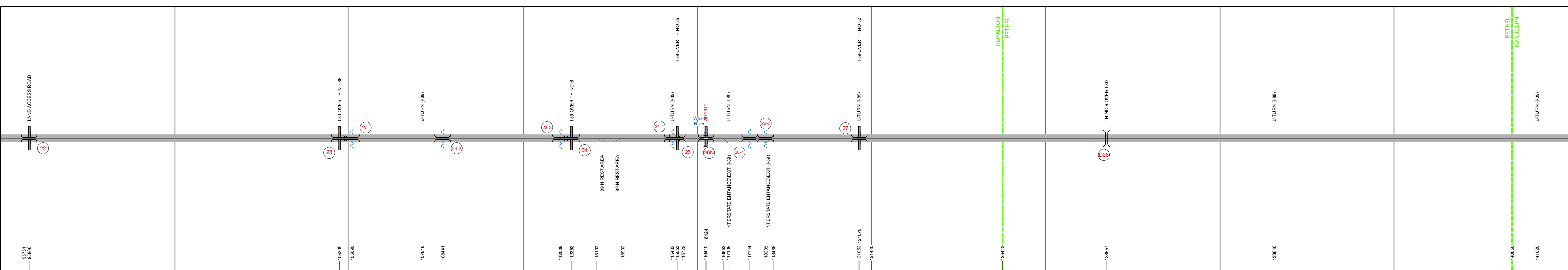

Road Widths

Travellane
Roadway
Lane Count
Base
Subbase

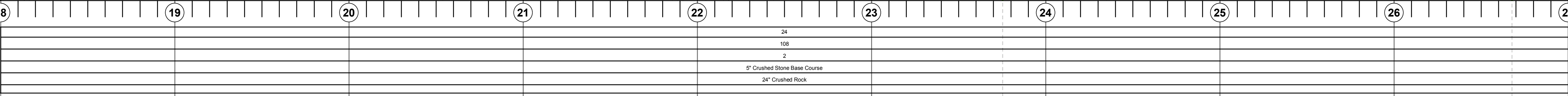

Curves

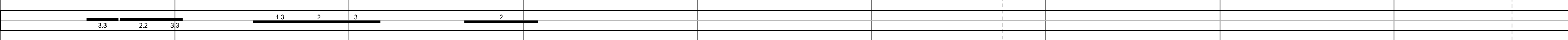

Grades



Historic Projects

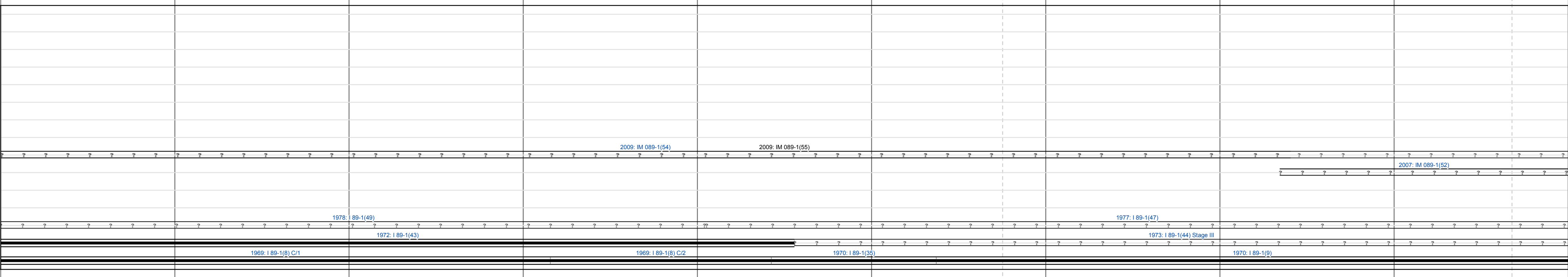

Maintenance Garage



Speed Zone

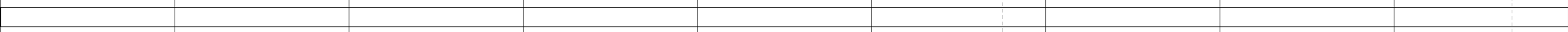

Functional Class



National Highway System

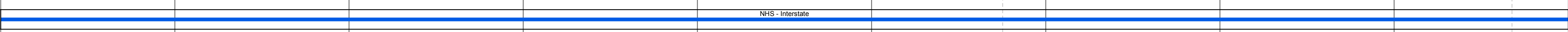

Traffic Counters



AADT Counts



Crash Locations

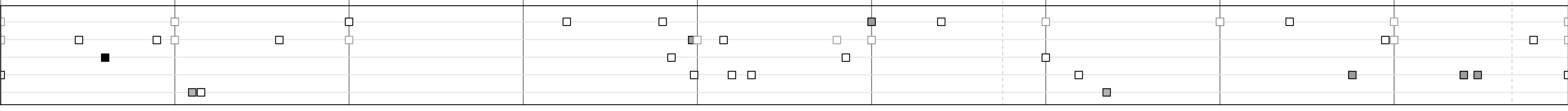

STRUCTURE DESCRIPTIONS

<p>Culvert 22-1: Culvert - 1969 Structure No. 300089002214161 Length: 14' Under Clearance: 12.0' Facility Carried: I89 Bridge Type: RC BOX Features Intersected: LAND ACCESS ROAD Maintenance/Ownership: State</p>	<p>Bridge 26-2: Culvert - 1969 Structure No. 30008926-214161 Length: 6' Under Clearance: 6.0' Facility Carried: I89 Bridge Type: CGMPP Features Intersected: BROOK Maintenance/Ownership: State</p>
<p>Culvert 23: Culvert - 1968 Structure No. 200089002314162 Length: 21' Under Clearance: 14.08' Facility Carried: I 00089 ML Bridge Type: REF CONC BOX Features Intersected: I 89 OVER TH NO 36 Maintenance/Ownership: State</p>	<p>Bridge 27: Culvert - 1968 Structure No. 200089002714162 Length: 21' Under Clearance: 14.08' Facility Carried: I 00089 ML Bridge Type: REF CONC BOX Features Intersected: I 89 OVER TH NO 32 Maintenance/Ownership: State</p>
<p>Culvert 23-1: Culvert - 1969 Structure No. 30008923-114161 Length: 6' Under Clearance: 6.0' Facility Carried: I89 Bridge Type: CGMPP Features Intersected: BROOK Maintenance/Ownership: State</p>	<p>Bridge D28: Stringer/multi-beam or girder - 1968 Structure No. 20140402814041 Length: 251' Width: 24.0' Under Clearance: 16.92' Facility Carried: TR 00TH6 Bridge Type: 4 SP ROLLED BEAM Features Intersected: TH NO 6 OVER I 89 Surface: Bituminous Maintenance/Ownership: State</p>
<p>Culvert 23-2: Culvert - 1969 Structure No. 30008923-214161 Length: 8' Under Clearance: 10.0' Facility Carried: I89 Bridge Type: RC BOX Features Intersected: BROOK Maintenance/Ownership: State</p>	
<p>Culvert 23-3: Culvert - 1969 Structure No. 30008923-314161 Length: 12' Under Clearance: 10.0' Facility Carried: I89 Bridge Type: RC BOX Features Intersected: BROOK Maintenance/Ownership: State</p>	
<p>Culvert 24: Culvert - 1968 Structure No. 200089002414162 Length: 21' Under Clearance: 14.08' Facility Carried: I 00089 ML Bridge Type: REF CONC BOX Features Intersected: I 89 OVER TH NO 6 Maintenance/Ownership: State</p>	
<p>Culvert 24-1: Culvert - 1969 Structure No. 30008924-114161 Length: 10' Under Clearance: 6.42' Facility Carried: I89 Bridge Type: RC BOX Features Intersected: CATTLE PASS Maintenance/Ownership: State</p>	
<p>Culvert 25: Culvert - 1968 Structure No. 200089002514162 Length: 21' Under Clearance: 14.08' Facility Carried: I 00089 ML Bridge Type: REF CONC BOX Features Intersected: I 89 OVER TH NO 35 Maintenance/Ownership: State</p>	
<p>Bridge 26N: Stringer/multi-beam or girder - 1968 Structure No. 200089026N14162 Length: 917' Width: 30.0' Under Clearance: 17.5' Facility Carried: I 00089 ML Bridge Type: 6 SP CONT GIRDER Features Intersected: I 89 OVER WR+NECR+107 Surface: Bituminous Maintenance/Ownership: State</p>	
<p>Culvert 26-1: Culvert - 1969 Structure No. 30008926-114161 Length: 6' Under Clearance: 6.0' Facility Carried: I89 Bridge Type: CGMPP Features Intersected: BROOK Maintenance/Ownership: State</p>	

<p>Historic Projects</p> <ul style="list-style-type: none"> Unknown Bituminous Seal Retreatment Resurface Bituminous Mix Bituminous Concrete Skinny Mix Gravel Surface Treated Gravel Plant Mix Reclaimed Base and Expressways Bituminous Concrete 	<p>Functional Class</p> <ul style="list-style-type: none"> 1 - Interstate System 2 - Other 3 - Principal Arterial 4 - Minor Arterial 5 - Major Collector 6 - Minor Collector <p>Speed Zones</p> <ul style="list-style-type: none"> 25 30 35 40 45 50 55 60 65 	<p>Curves</p> <ul style="list-style-type: none"> Left Right <p>Grades</p> <ul style="list-style-type: none"> grade up grade down 	<p>Road Widths</p> <p>(ft)</p>	<p>Traffic Counters</p> <p>(counter ID)</p>	<p>AADT</p> <p>(count)</p>	<p>Crash Locations</p> <ul style="list-style-type: none"> Fatal Injury Property Damage Only Unknown Crash Type 	<p>Mileage by Functional Class By Sheet</p> <p>89-1 1 - Interstate 9.000</p>	<p>Mileage by Town By Sheet</p> <p>ETE - I089-0000 9.0 of 130.254</p>	<p>DISTRICT</p> <p>4</p>	<p>TOWN</p> <p>ROYALTON, BETHEL, RANDOLPH</p>	<p>Date: 10/19/16</p> <p>3 of 15 TWN mileage: 18.0 to 27.0</p>	<p>ROUTE</p> <p>I-89</p> <p>ETE mileage: 18.0 to 27.0</p>
---	--	--	---------------------------------------	--	-----------------------------------	---	---	--	---------------------------------	--	---	--

Page Total Mileage: 9.000 mi Page Total Mileage: 9.0 mi