



Route Log Progress Chart

DRAFT

Please Note: Errors and Omissions May Exist.
Contact the VTrans Mapping Unit with questions or concerns.

DISTRICT	TOWN	ROUTE
6	NORTHFIELD	VT-12A

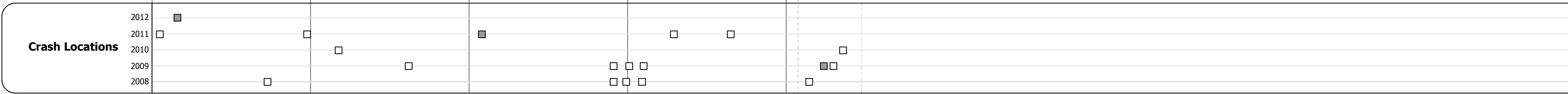
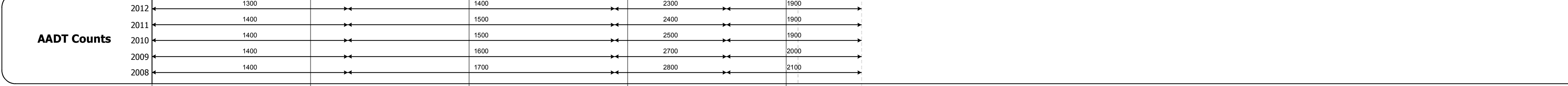
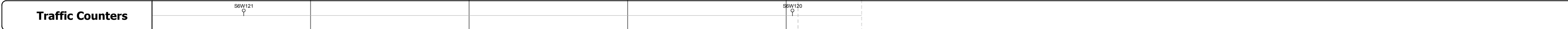
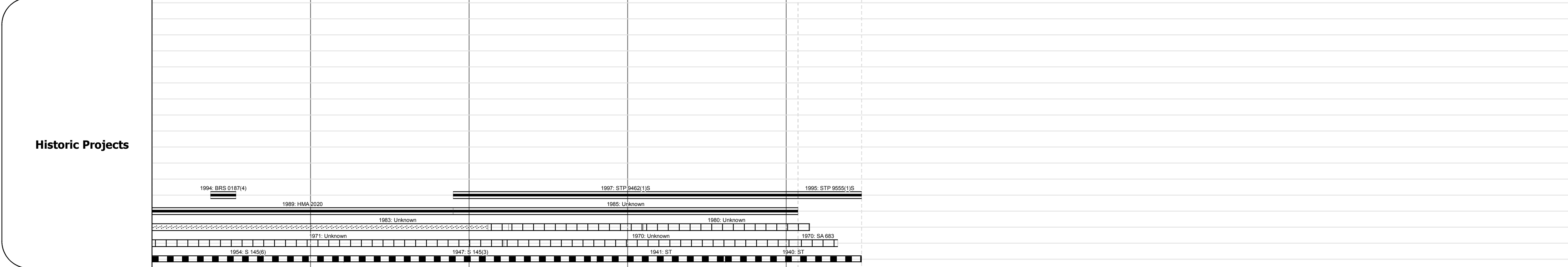
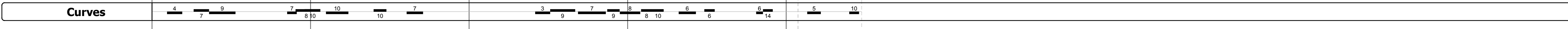
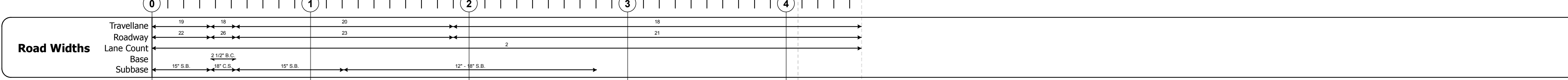
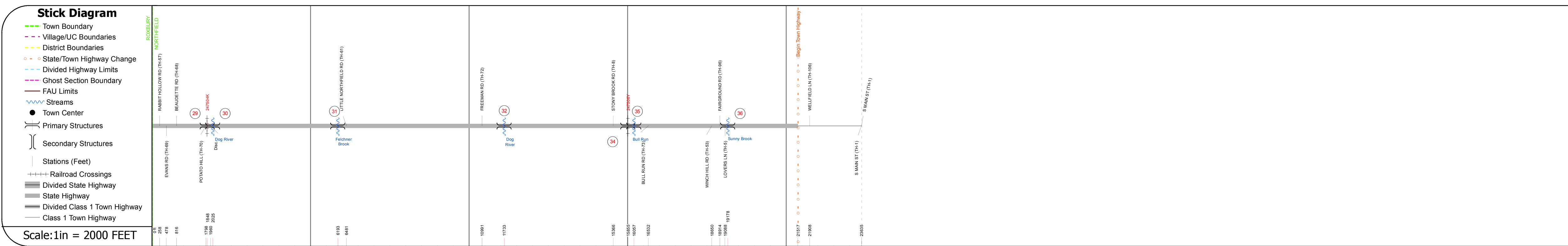
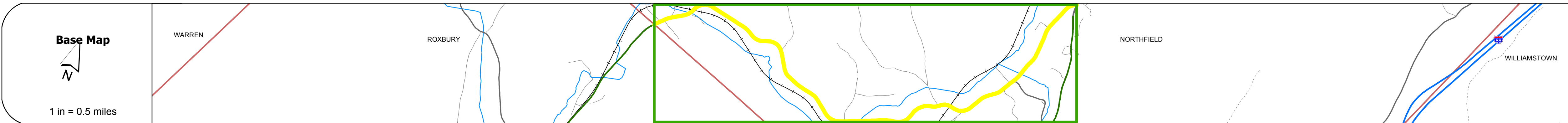
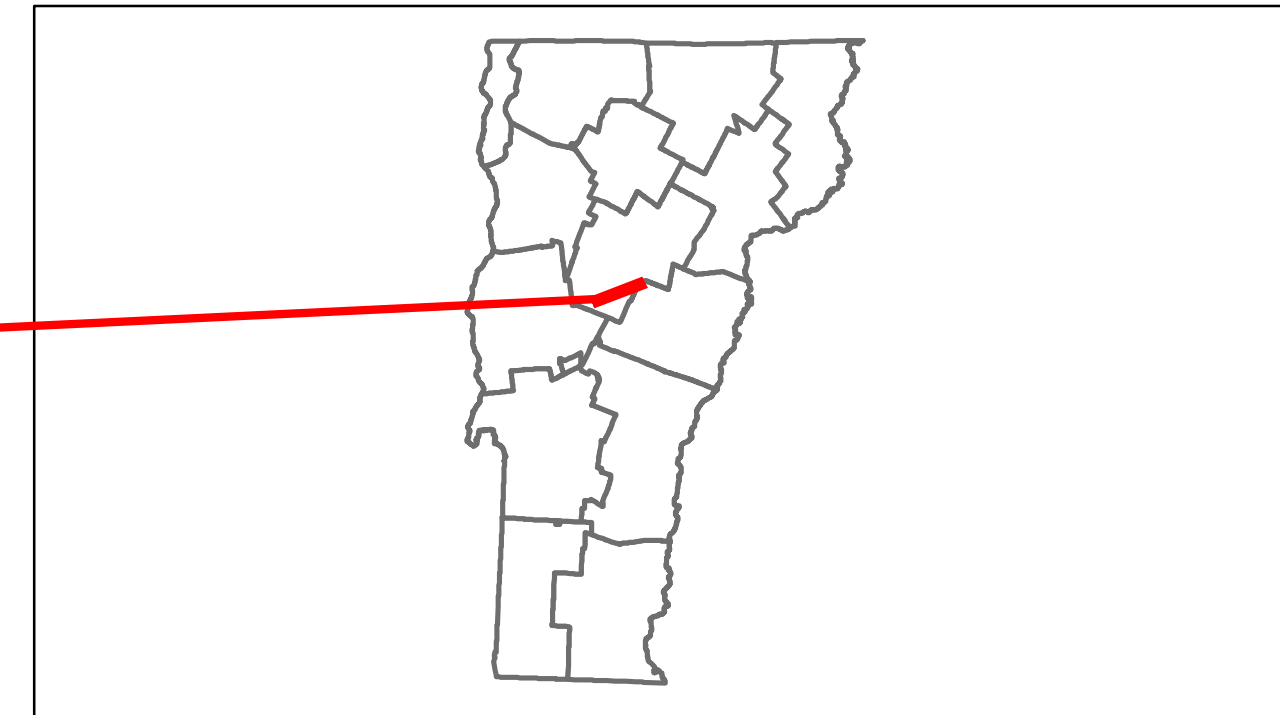

DESCRIPTION BLOCK

Bridge 29:
Stringer/multi-beam or girder - 1928
Structure No. 200187002912132
Length: 50'
Height: 0.0'
Facility Carried: RAILROAD
Bridge Type: RIVETED TWO GIRDER
Features Intersected: N.E.C.R.R. OVER VT 12A

Bridge 30:
Stringer/multi-beam or girder - 1993
Structure No. 200187003012132
Length: 92'
Width: 32.7'
Facility Carried: VT 0012A ALT
Bridge Type: WELDED PLATE GIRDER
Features Intersected: DOG RIVER
Surface: Bituminous
Maintenance/Ownership: State

Culvert 31:
Culvert - 1954
Structure No. 300187003112131
Length: 15'
Under Clearance: 9.0'
Facility Carried: VT 12A
Bridge Type: CGMPPA
Features Intersected: BROOK
Maintenance: State

Bridge 32:
Tee Beam - 1929
Structure No. 200187003212132
Length: 35'
Width: 20.3'
Facility Carried: VT 0012A ALT
Bridge Type: CONCRETE T-BEAM
Features Intersected: DOG RIVER
Surface: Bituminous
Maintenance/Ownership: State

Bridge 34:
Stringer/multi-beam or girder - 1930
Structure No. 200187003412132
Length: 299'
Height: 0.0'
Facility Carried: RAILROAD
Bridge Type: RIVETED TWO GIRDER
Features Intersected: N.E.C.R.R. OVER VT 12A

Bridge 35:
Tee Beam - 1929
Structure No. 200187003512132
Length: 34'
Width: 20.2'
Facility Carried: VT 0012A ALT
Bridge Type: CONCRETE T-BEAM
Features Intersected: BULL RUN BROOK
Surface: Bituminous
Maintenance/Ownership: State

Bridge 36:
Tee Beam - 1931
Structure No. 200187003612132
Length: 33'
Width: 20.5'
Facility Carried: VT 0012A ALT
Bridge Type: CONCRETE T-BEAM
Features Intersected: SUNNY BROOK
Surface: Bituminous
Maintenance/Ownership: State

Historic Projects Retreatment, Resurface, Unknown, Bituminous Mix, Skippy Mix, Bituminous Seal, Bituminous Concrete, Concrete, Gravel, Surface Treated Gravel, Plant Mix, Reclaimed Base and Bituminous Concrete, Concrete	Functional Class 1, 2, 3, 4, 5, 6, 7, 8, 9, 10, 11, 12, 13, 14, 15, 16, 17, 18, 19	Curves curve left, curve right	Road Widths (ft)	AADT (count)	Mileage by Functional Class By Sheet 0187 7 - Rural - Major collector 4.476	Mileage by Town By Sheet NORTHFIELD - V012A1213 4.476 of 4.476	DISTRICT 6	TOWN NORTHFIELD	Date: 04/02/14	ROUTE VT-12A ETE mileage: 16.366 to 20.842
Crash Locations Fatal, Injury, Property Damage Only, Unknown Crash Type	Speed Zones 25, 30, 35, 40, 45, 50, 55, 60, 65	Grades grade up, grade down	Traffic Counters (counter ID)	Total Mileage: 4.476 mi	Total Mileage: 4.476 mi	1 of 1 TOWN mileage: 0.0 to 4.476				