

DISTRICT	TOWN	ROUTE
4	BETHEL	VT-12

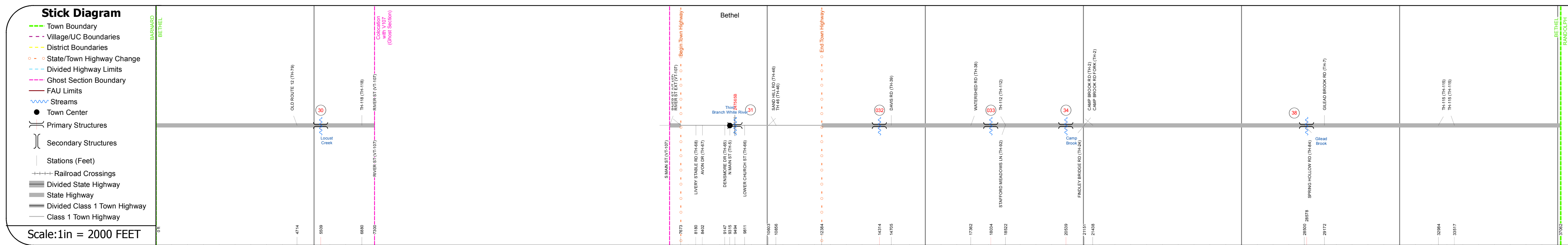
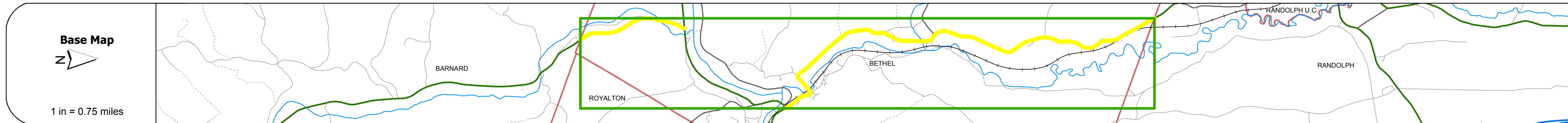
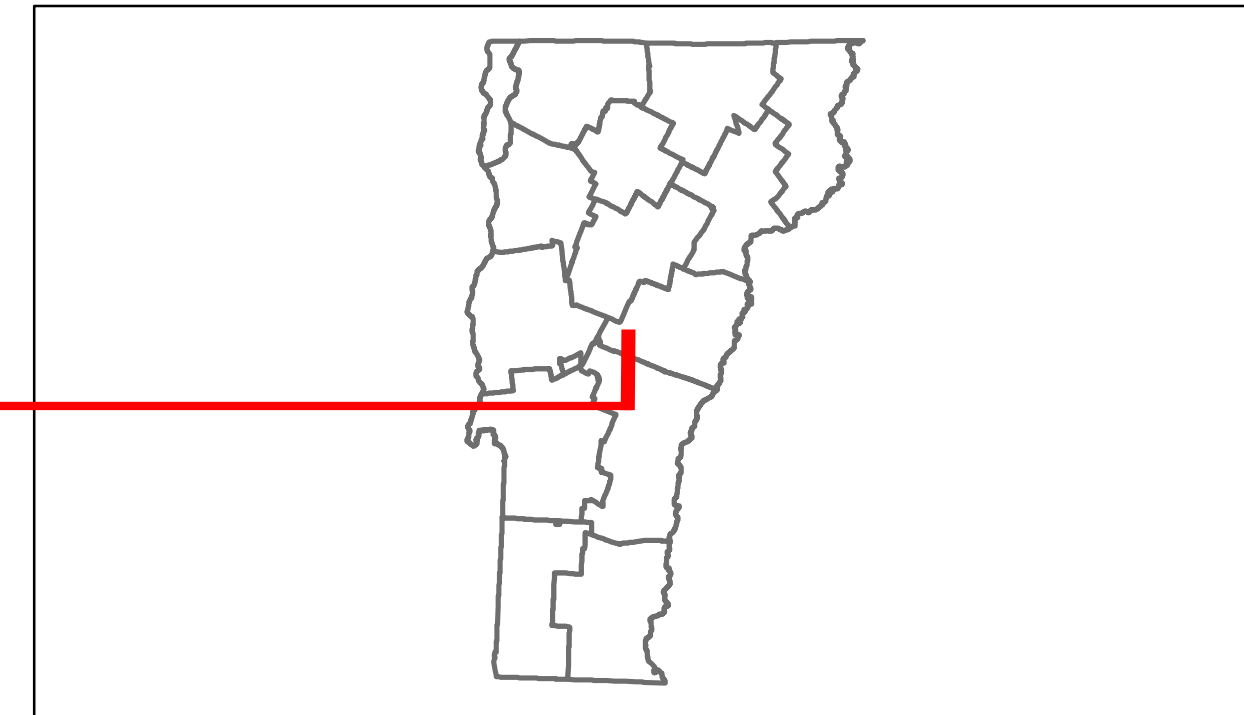

<b>Road Widths</b>	Travellane: 20, 27, 31 Roadway: 20, 27, 31 Lane Count: 2, 3, 4 Base: 18'	19, 20, 23, 24, 25, 26, 27, 28, 29, 30, 31, 32, 33, 34, 35, 36, 37, 38, 39, 40, 41, 42, 43, 44, 45, 46, 47, 48, 49, 50, 51, 52, 53, 54, 55, 56, 57, 58, 59, 60, 61, 62, 63, 64, 65, 66, 67, 68, 69, 70, 71, 72, 73, 74, 75, 76, 77, 78, 79, 80, 81, 82, 83, 84, 85, 86, 87, 88, 89, 90, 91, 92, 93, 94, 95, 96, 97, 98, 99, 100		
<b>Curves</b>	5, 3, 4	36, 6, 12, 10, 85, 13, 4, 30, 10, 14, 10, 6, 14, 7, 5, 6, 11, 5, 10, 4, 7, 6, 7, 8, 9		
<b>Grades</b>	-6.5	-7.1, +8.0, +5.4, +5.2, +8.0, -6.4A		
<b>Historic Projects</b>	1996: STP 9570(1)S, 2012: BHF 0241(30) 1973: Unknown 1956: F 142(2) 1959: DF 022-1(3) Approach 1980: Unknown 1988: HMA 2018	2000: AC STP 9821(1)S, 1995: STP 9556(1)S 1995: SA 1063 1954: SA 519(54) 1971: Unknown 1948: ADP 8148 1960: Village Project 1940: FAGH 101-D(1) Unknown 1935: NRH 87-D 1974: Unknown 1983: RS 0241(14) 1932: FAP 07-D 1929: FR 12-H	1993: STP 9326(1)S	
<b>Maintenance Garage</b>	District 4 - Royalton Garage	(Not State Maintained)	District 4 - Royalton Garage	
<b>Traffic Counters</b>	867468	867180, 867190, 867134		
<b>Functional Class</b>	7	7	7	
<b>Speed Zone</b>	25	25, 35	35	
<b>AADT Counts</b>	2012: 1000 2011: 1000 2010: 1000 2009: 1100 2008: 1100	2012: 6100, 4900 2011: 6100, 4900 2010: 6000, 4800 2009: 5800, 4600 2008: 5500, 4400	2012: 3800, 3900 2011: 3800, 3900 2010: 4000, 4300 2009: 4000, 4300 2008: 4000, 4200	2012: 4400 2011: 4400 2010: 4300 2009: 4300 2008: 4200
<b>Crash Locations</b>	2012, 2011, 2010, 2009, 2008	2012, 2011, 2010, 2009, 2008	2012, 2011, 2010, 2009, 2008	

DESCRIPTION BLOCK
<p><b>Bridge 30:</b> Stringer/multi-beam or girder - 2012 Structure No. 200241003014042 Length: 121' Width: 30.0' Facility Carried: VT 00012 ML Bridge Type: WELDED PLATE GIRDER Features Intersected: LOCUST CREEK Maintenance/Ownership: State</p> <p><b>Bridge 31:</b> Stringer/multi-beam or girder - 2006 Structure No. 200241003114042 Length: 183' Width: 28.7' Under Clearance: 20.58' Facility Carried: VT 00012 ML Bridge Type: WELDED PLATE GIRDER Features Intersected: 3RD BR WHITE R. + NECRR Surface: Bituminous Maintenance/Ownership: Town</p> <p><b>Bridge 32:</b> Slab - 1931 Structure No. 300241003214041 Length: 10' Width: 26.5' Under Clearance: 3.25' Facility Carried: VT12 Bridge Type: CONCRETE SLAB Features Intersected: BROOK Surface: Bituminous Maintenance: State</p> <p><b>Culvert 33:</b> Culvert - 1932 Structure No. 300241003314041 Length: 9' Under Clearance: 6.0' Facility Carried: VT12 Bridge Type: CONCRETE BOX Features Intersected: BROOK Maintenance: State</p> <p><b>Bridge 34:</b> Tee Beam - 1928 Structure No. 200241003414042 Length: 43' Width: 20.0' Facility Carried: VT 00012 ML Bridge Type: CONCRETE T-BEAM Features Intersected: CAMP BROOK Surface: Bituminous Maintenance/Ownership: State</p> <p><b>Bridge 38:</b> Truss - deck - 1928 Structure No. 200241003814042 Length: 326' Width: 24.0' Facility Carried: VT 00012 ML Bridge Type: 4 SP STL DECK TRUSS Features Intersected: GILEAD BROOK 1 Surface: Bituminous Maintenance/Ownership: State</p>

<b>Historic Projects</b> Retreatment, Resurface, Unknown, Bituminous Mix, Skimmy Mix, Bituminous Seal, Bituminous Concrete, Gravel, Surface Treated Gravel, Plant Mix, Reclaimed Base and Bituminous Concrete, Concrete	<b>Functional Class</b> 1, 2, 3, 4, 5, 6, 7, 8, 9, 10, 11, 12, 13, 14, 15, 16, 17, 18, 19	<b>Curves</b> curve left, curve right	<b>Road Widths</b> (ft)	<b>AADT</b> (count)	<b>Crash Locations</b> Fatal, Injury, Property Damage Only, Unknown Crash Type	<b>Mileage by Functional Class By Sheet</b> 0241 7 - Rural - Major collector 7.019	<b>Mileage by Town By Sheet</b> BETHEL - V012-1404 Ghost Section - VT-107 (1.536 to 3.402) 7.019 of 7.019 1.866	<b>DISTRICT</b> 4	<b>TOWN</b> BETHEL	<b>Date:</b> 04/02/14	<b>ROUTE</b> VT-12 ETE mileage: 23.105 to 30.124
						<b>Total Mileage:</b> 7.019 mi	<b>Total Mileage:</b> 7.019 mi	<b>1 of 1</b> <b>TWN mileage:</b> 0.0 to 7.019			