



Route Log Progress Chart

DRAFT

Please Note: Errors and Omissions May Exist.
Contact the VTrans Mapping Unit with questions or concerns.

DISTRICT	TOWN	ROUTE
8	ALBURGH	US-2

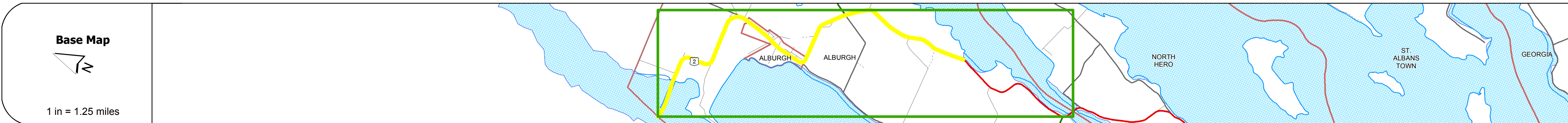
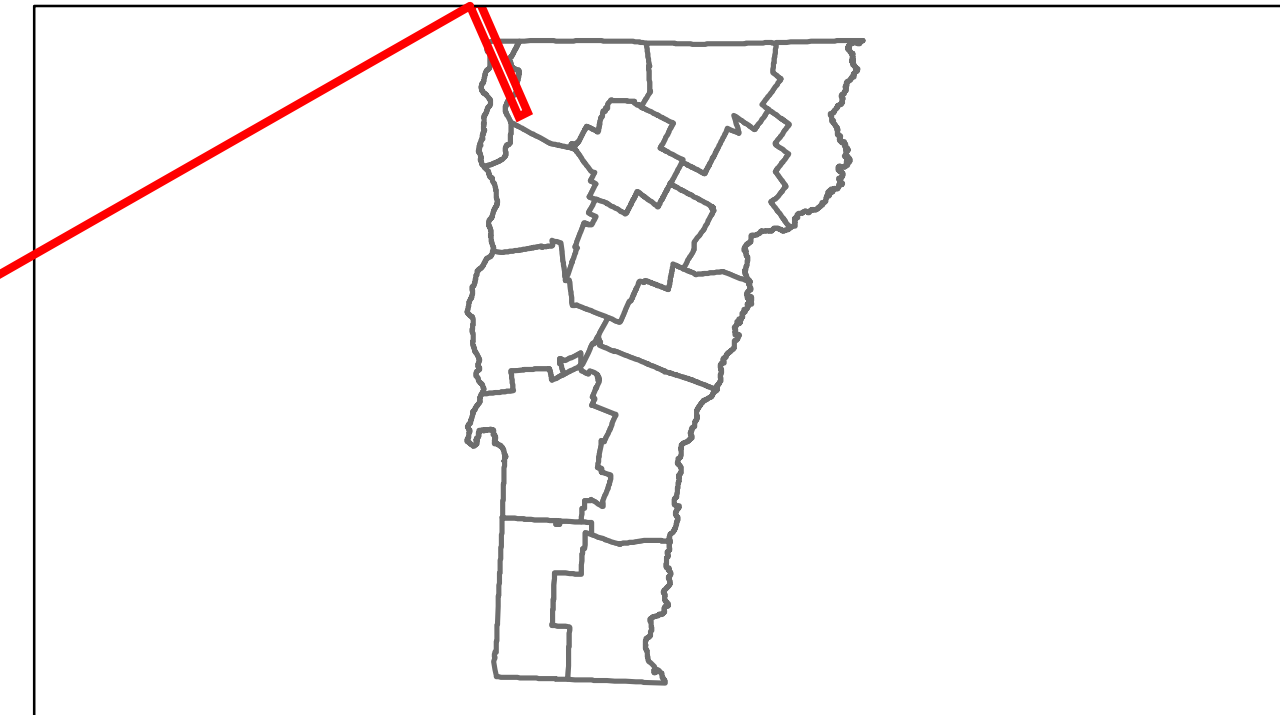

Stick Diagram

- Town Boundary
- Village/UC Boundaries
- District Boundaries
- State/Town Highway Change
- Divided Highway Limits
- Ghost Section Boundary
- FAU Limits
- Streams
- Town Center
- Primary Structures
- Secondary Structures
- Stations (Feet)
- Railroad Crossings
- Divided State Highway
- State Highway
- Divided Class 1 Town Highway
- Class 1 Town Highway

Scale: 1in = 2000 FEET

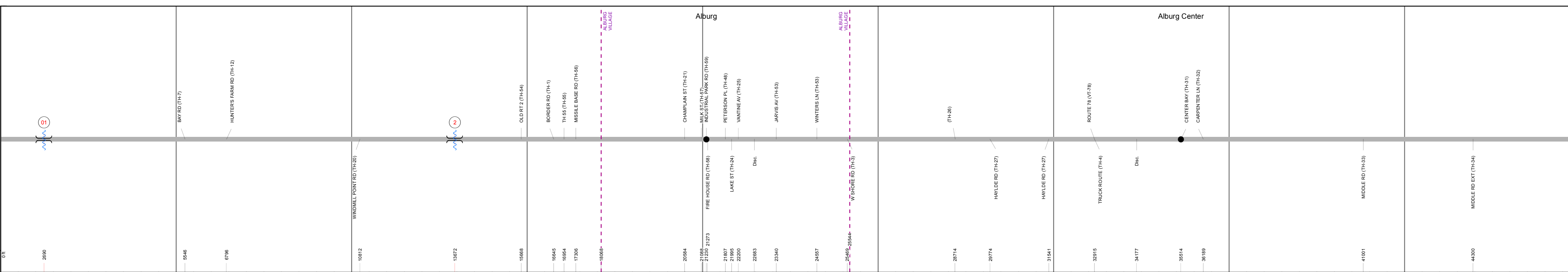

DESCRIPTION BLOCK

Bridge 1:
Stringer/multi-beam or girder - 1987
Structure No. 200028000107012
Length: 4052'
Width: 39.5'
Facility Carried: US 00002 ML
Bridge Type: 29 SPAN CONT GIRDER
Features Intersected: LAKE CHAMPLAIN
Surface: Bituminous
Maintenance/Ownership: State

Culvert 2:
Culvert - 1937
Structure No. 300028000207011
Length: 13'
Under Clearance: 3.0'
Facility Carried: US2
Bridge Type: RC BOX CULVERT
Features Intersected: BROOK
Maintenance: State

Road Widths	Travellane	Roadway	Lane Count	Base	Subbase
	38	22	26	18" Gravel	3" Crushed Rock
	40	32	44	18" Ledge Rock	8" - 12"
	22	24	30	3" PM	3" Crushed Rock
	24	40	2	3" C/S	10" - 12"

Curves	7	8	4.30'	12.30'
--------	---	---	-------	--------

Grades				
--------	--	--	--	--

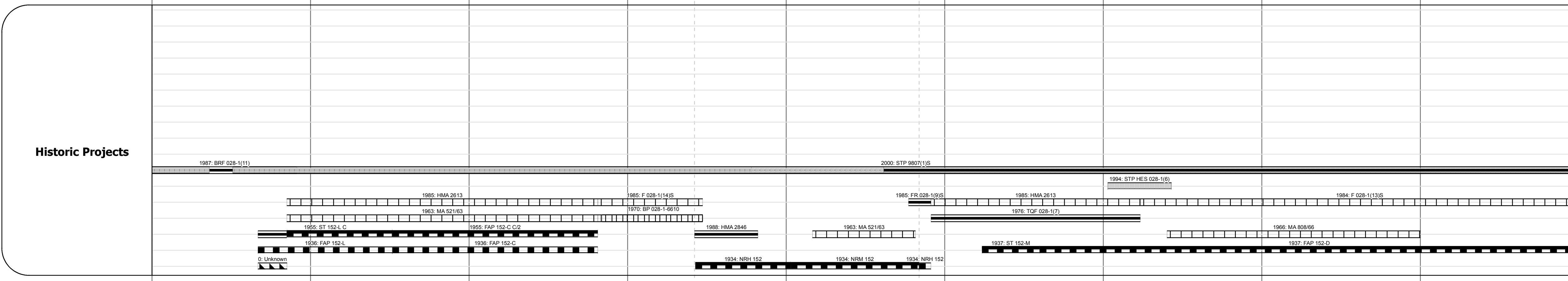

Maintenance Garage	District 8 - Highgate Garage
--------------------	------------------------------

Traffic Counters	58002, 58018, 58019, 58039, 58010
------------------	-----------------------------------

Functional Class	2 (Red line), 6 (Green line)
------------------	------------------------------

Speed Zone	40, 50, 55, 60, 65
------------	--------------------

AADT Counts	2012	4600	4600	4400	4600	5200	4900	1800	1800
	2011	4800	4800	4400	4600	5000	4500	2100	1800
	2010	4900	4900	4300	4600	4700	4100	2400	1800
	2009	4500	4500	4000	4300	4400	4300	2400	1800
	2008	4000	4000	3700	3900	4000	4400	2400	1700

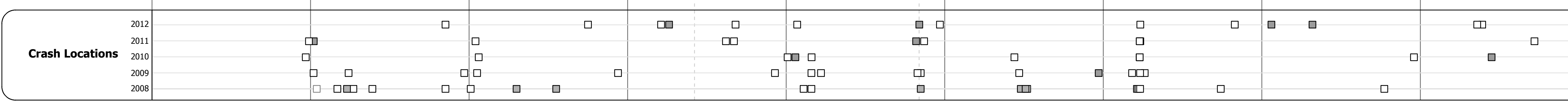

<p>Historic Projects</p> <ul style="list-style-type: none"> Retreatment Resurface Unknown Bituminous Mix Skimpy Mix Bituminous Seal Gravel Surface Treated Gravel Plant Mix Reclaimed Base and Bituminous Concrete Concrete 	<p>Functional Class</p> <ul style="list-style-type: none"> 1 (Blue) 2 (Red) 3 (Green) 4 (Yellow) 5 (Purple) 6 (Light Green) 7 (Orange) 8 (Light Blue) 9 (Light Purple) 10 (Light Orange) 11 (Light Yellow) 12 (Light Green) 13 (Light Blue) 14 (Light Purple) 15 (Light Orange) 16 (Light Yellow) 17 (Light Green) 18 (Light Blue) 19 (Light Purple) <p>Speed Zones</p> <ul style="list-style-type: none"> 25 30 35 40 45 50 55 60 65 	<p>Curves</p> <ul style="list-style-type: none"> curve left curve right <p>Grades</p> <ul style="list-style-type: none"> grade up grade down 	<p>Road Widths</p> <p>(ft)</p>	<p>Traffic Counters</p> <p>(counter ID)</p>	<p>AADT</p> <p>(count)</p>	<p>Crash Locations</p> <ul style="list-style-type: none"> Fatal Injury Property Damage Only Unknown Crash Type 	<p>Mileage by Functional Class By Sheet</p> <p>028-1 2 - Rural - Principal Arterial 6.234 028-1 6 - Rural - Minor Arterial 2.766</p> <p>Total Mileage: 9.000 mi</p>	<p>Mileage by Town By Sheet</p> <p>ALBURGH - U002-0701 9.0 of 11.732</p> <p>Total Mileage: 9.0 mi</p>	<p>DISTRICT</p> <p>8</p>	<p>TOWN</p> <p>ALBURGH</p>	<p>Date: 04/02/14</p>	<p>ROUTE</p> <p>US-2</p> <p>ETE mileage: 0.0 to 9.0</p>
---	---	--	---------------------------------------	--	-----------------------------------	---	---	---	---------------------------------	-----------------------------------	------------------------------	--

For More Information Contact - Vermont Agency of Transportation, Policy, Planning and Intermodal Development Division - Mapping Unit, 1 National Life Drive, Montpelier, VT 05633-5001 Telephone: 802-828-2600.