



# Route Log Progress Chart

**DRAFT**

Please Note: Errors and Omissions May Exist.  
Contact the VTrans Mapping Unit with questions or concerns.

DISTRICT	TOWN	ROUTE
8	FAIRFIELD	Min-0792

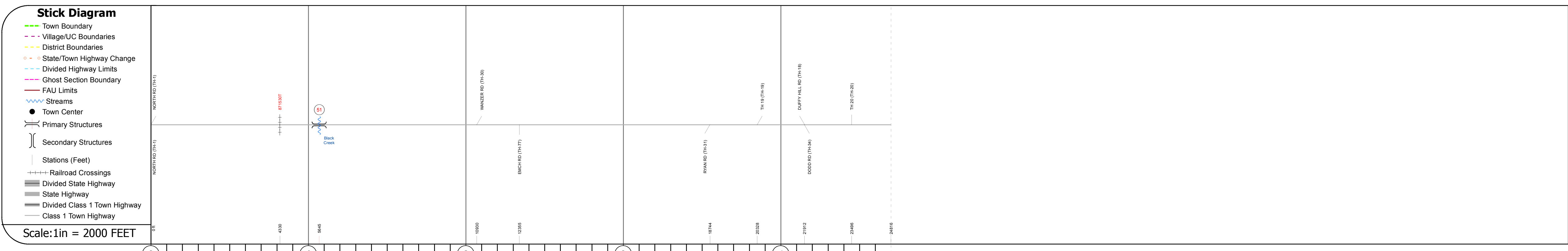
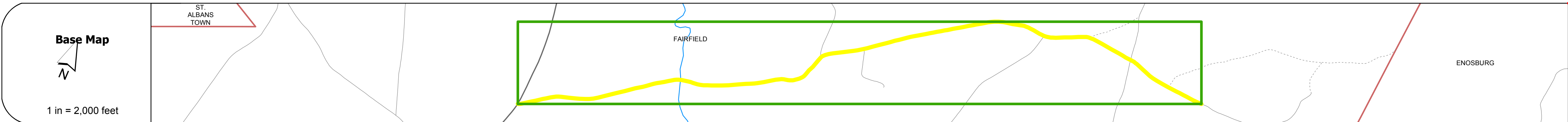
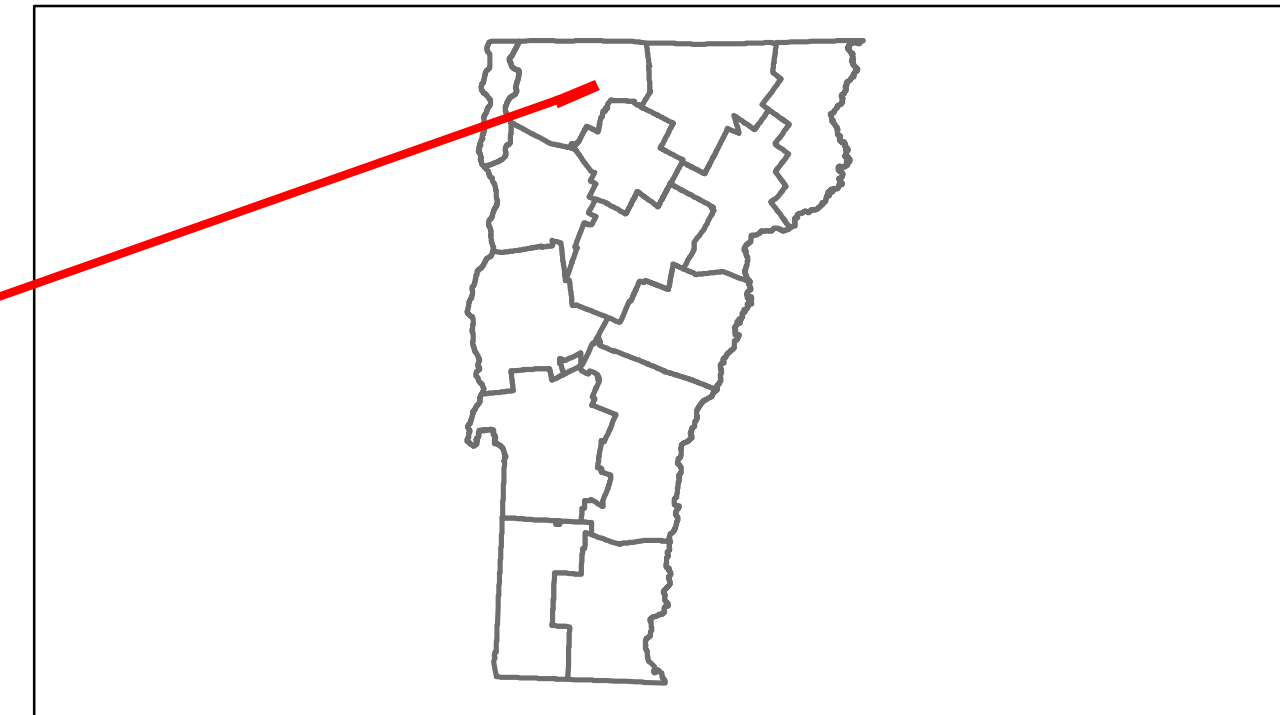

## DESCRIPTION BLOCK

**Bridge 51:**  
Stringer/multi-beam or girder - 1937  
Structure No. 100605005106051  
Length: 90'  
Width: 17.9'  
Facility Carried: C2002  
Bridge Type: ROLLED BEAM  
Features Intersected: BLACK CREEK  
Surface: Bituminous  
Maintenance/Ownership: Town

<b>Road Widths</b>	Travellane				
	Roadway				
	Lane Count				
	Base				
	Subbase				
<b>Curves</b>					
<b>Grades</b>					
<b>Historic Projects</b>					
<b>Maintenance Garage</b>		(Not State Maintained)			
<b>Traffic Counters</b>		SF3350	SF3375	SF3501	
<b>Functional Class</b>		8			
<b>Speed Zone</b>					
<b>AADT Counts</b>	2012				
	2011				
	2010				
	2009				
	2008				
<b>Crash Locations</b>	2012				
	2011				
	2010				
	2009				
	2008				

<b>Historic Projects</b> Retreatment, Resurface, Unknown, Bituminous Mix, Skippy Mix, Bituminous Seal, Bituminous Concrete, Surface Treated Gravel, Plant Mix, Reclaimed Base and Bituminous Concrete, Concrete	<b>Functional Class</b> 1-19, 2-19, 6-16, Speed Zones 25-65	<b>Curves</b> curve left, curve right	<b>Road Widths</b> (ft)	<b>Traffic Counters</b> (counter ID)	<b>AADT</b> (count)	<b>Crash Locations</b> Fatal, Injury, Property Damage Only, Unknown Crash Type	<b>Mileage by Functional Class By Sheet</b> 0792 8 - Rural - Minor collector 4.700	<b>Mileage by Town By Sheet</b> FAIRFIELD - S07920605 4.7 of 4.7	<b>DISTRICT</b> 8	<b>TOWN</b> FAIRFIELD	<b>Date:</b> 04/01/14	<b>ROUTE</b> Min-0792 ETE mileage: 0.0 to 4.7
							<b>Total Mileage: 4.700 mi</b>					