



Route Log Progress Chart

DRAFT

Please Note: Errors and Omissions May Exist.
Contact the VTrans Mapping Unit with questions or concerns.

DISTRICT	TOWN	ROUTE
9	GLOVER	Min-0774

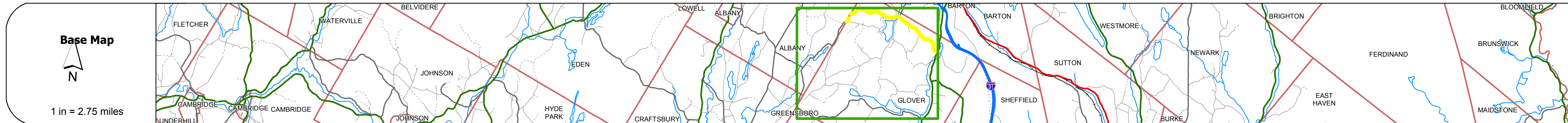
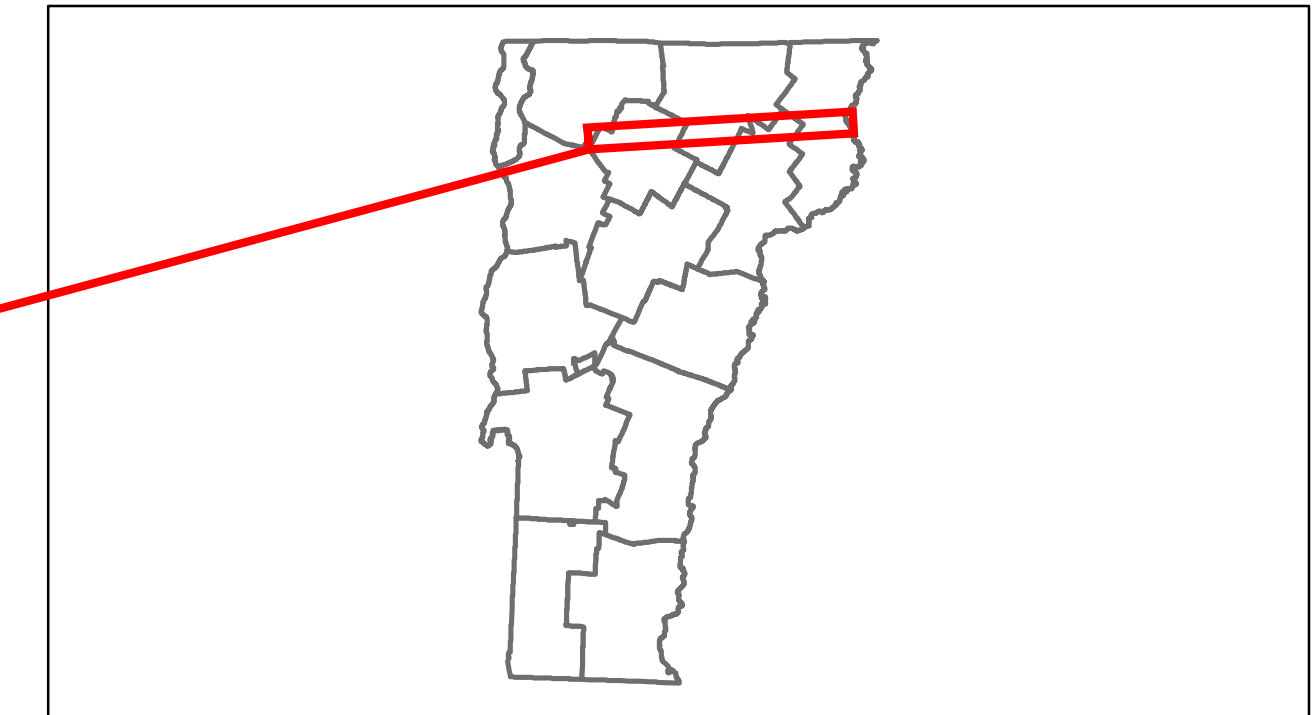

Stick Diagram

- Town Boundary
- Village/UC Boundaries
- District Boundaries
- State/Town Highway Change
- Divided Highway Limits
- Ghost Section Boundary
- FAU Limits
- Streams
- Town Center
- Primary Structures
- Secondary Structures
- Stations (Feet)
- Railroad Crossings
- Divided State Highway
- State Highway
- Divided Class 1 Town Highway
- Class 1 Town Highway

Scale: 1in = 2000 FEET

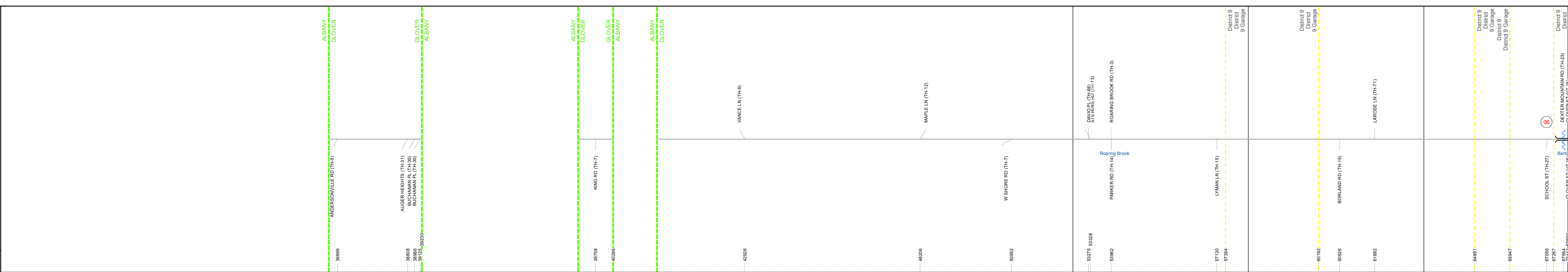

DESCRIPTION BLOCK

Bridge 6:
Slab - 1974
Structure No. 10100800610081
Length: 41'
Width: 27.7'
Facility Carried: C2003
Bridge Type: PRESTRESS CONC. SLAB
Features Intersected: BARTON RIVER
Surface: Bituminous
Maintenance/Ownership: Town

Road Widths	Travellane	Roadway	Lane Count	Base	Subbase

Curves	Grades

Historic Projects

Maintenance Garage
(Not State Maintained)

Traffic Counters
SEPS35, SEPS36, SEPS38

Functional Class
8

Speed Zone

ADT Counts
2012, 2011, 2010, 2009, 2008

Crash Locations
2012, 2011, 2010, 2009, 2008

Historic Projects Retreatment, Resurface, Unknown, Bituminous Mix, Skinny Mix, Bituminous Seal, Gravel, Surface Treated Gravel, Plant Mix, Reclaimed Base and Bituminous Concrete, Concrete	Functional Class 1, 2, 3, 4, 5, 6, 7, 8, 9, 10, 11, 12, 13, 14, 15, 16, 17, 18, 19	Curves curve left, curve right	Road Widths (ft)	Traffic Counters (counter ID)	Crash Locations Fatal, Injury, Property Damage Only, Unknown Crash Type	Mileage by Functional Class By Sheet 0774 8 - Rural - Minor collector 3.820	Mileage by Town By Sheet GLOVER - S07741008 7.79 of 16.79	DISTRICT 9	TOWN GLOVER	Date: 04/01/14	ROUTE Min-0774 ETE mileage: 9.0 to 16.79
						Total Mileage: 7.790 mi	Total Mileage: 7.79 mi	2 of 2 TWN mileage: 9.0 to 12.82			

For More Information Contact - Vermont Agency of Transportation, Policy, Planning and Intermodal Development Division - Mapping Unit, 1 National Life Drive, Montpelier, VT 05633-5001 Telephone: 802-828-2600.