



Route Log Progress Chart

DRAFT

Please Note: Errors and Omissions May Exist.
Contact the VTrans Mapping Unit with questions or concerns.

DISTRICT	TOWN	ROUTE
6	WAITSFIELD	Min-0682

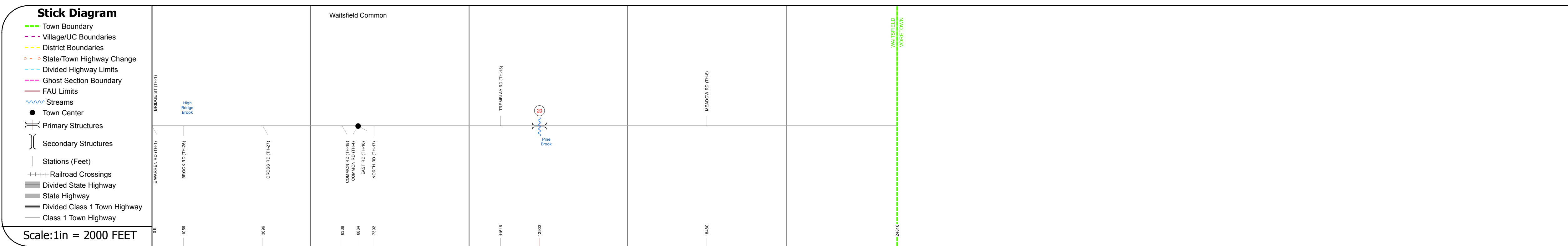
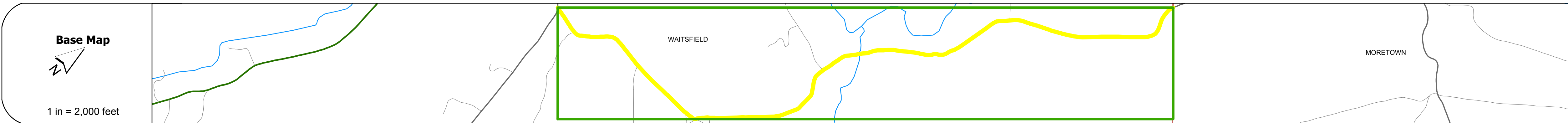
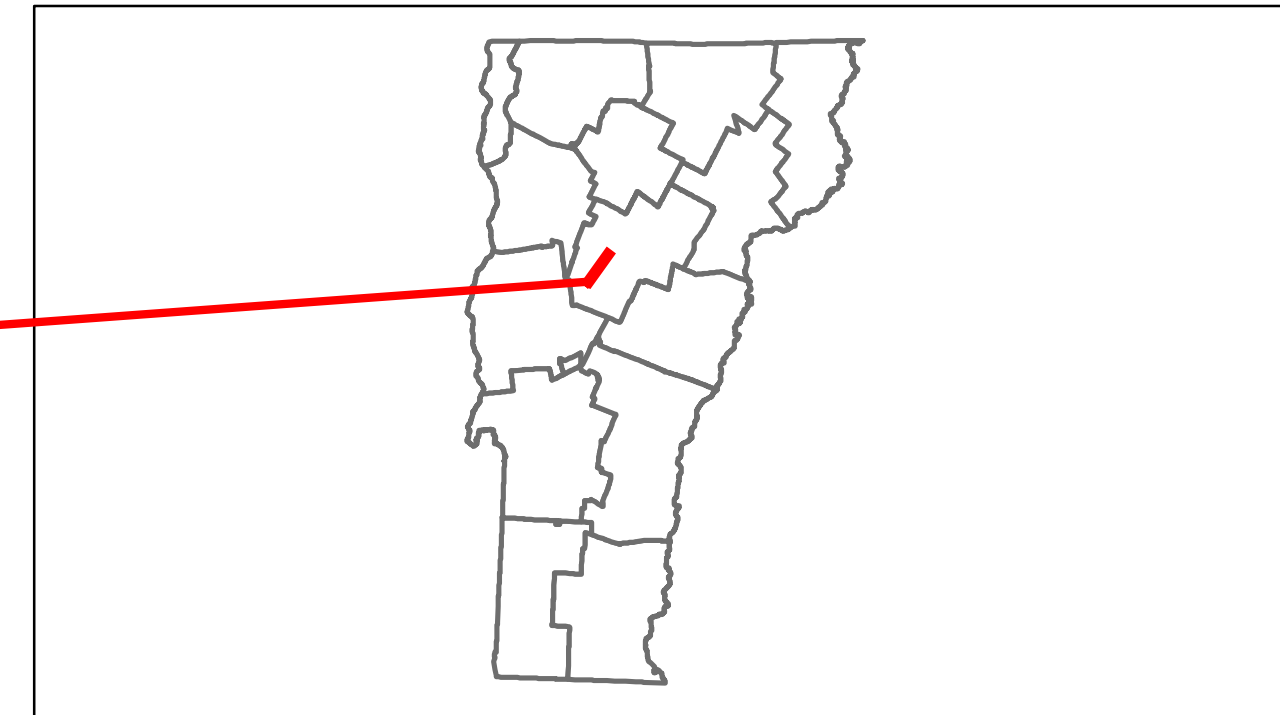

DESCRIPTION BLOCK	
<p>Bridge 20: Girder and floorbeam system - 1872 Structure No. 101216002012161 Length: 52' Height: 9.58' Width: 13.5' Weight Limit: 10 Facility Carried: C2003 Bridge Type: STL BMKING POST CB Features Intersected: PINE BROOK 1 Covered: PINE BROOK Surface: Timber Maintenance/Ownership: Town</p>	

Travellane	Roadway	Lane Count	Base	Subbase
Curves				
Grades				
Historic Projects				
Maintenance Garage				
				(Not State Maintained)
Traffic Counters				
		SRV331		SRV355 SRV399
Functional Class				
			8	
Speed Zone				
AADT Counts				
2012				
2011				
2010				
2009				
2008				
Crash Locations				
2012				
2011				
2010				
2009				
2008				

Historic Projects Retreatment, Resurface, Unknown, Bituminous Mix, Skippy Mix, Bituminous Seal, Gravel, Surface Treated Gravel, Plant Mix, Reclaimed Base and Bituminous Concrete, Concrete	Functional Class 1, 2, 6, 7, 8, 11, 12, 14, 16, 17, 19	Curves curve left, curve right	Road Widths (ft)	AADT (count)	Mileage by Functional Class By Sheet 0682 8 - Rural - Minor collector 4.700	Mileage by Town By Sheet WAITSFIELD - S06821216 4.7 of 4.7	DISTRICT 6	TOWN WAITSFIELD	Date: 04/01/14	ROUTE Min-0682 ETE mileage: 0.0 to 4.7
Total Mileage: 4.700 mi						Total Mileage: 4.7 mi				