

DISTRICT	TOWN	ROUTE
4	READING	Min-0584

Base Map

1 in = 0.5 miles

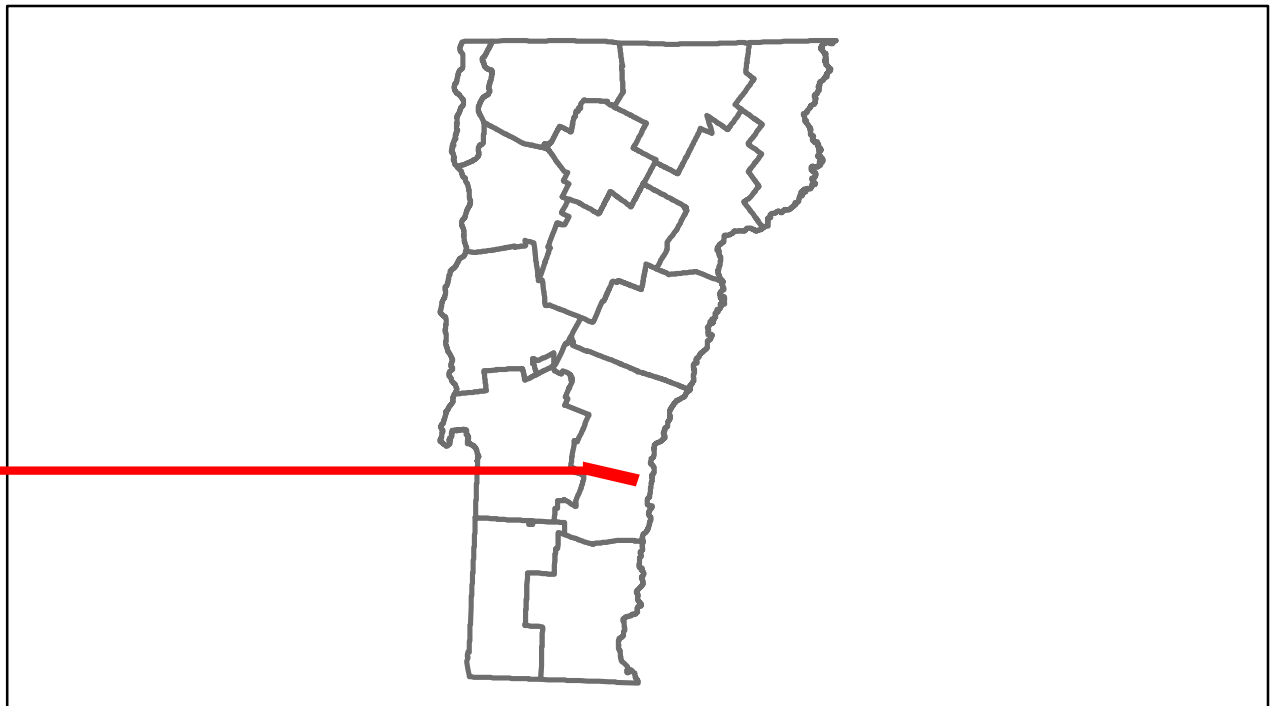

Stick Diagram

- Town Boundary
- Village/UC Boundaries
- District Boundaries
- State/Town Highway Change
- Divided Highway Limits
- Ghost Section Boundary
- FAU Limits
- Streams
- Town Center
- Primary Structures
- Secondary Structures
- Stations (Feet)
- Railroad Crossings
- Divided State Highway
- State Highway
- Divided Class 1 Town Highway
- Class 1 Town Highway

Scale: 1 in = 2000 FEET

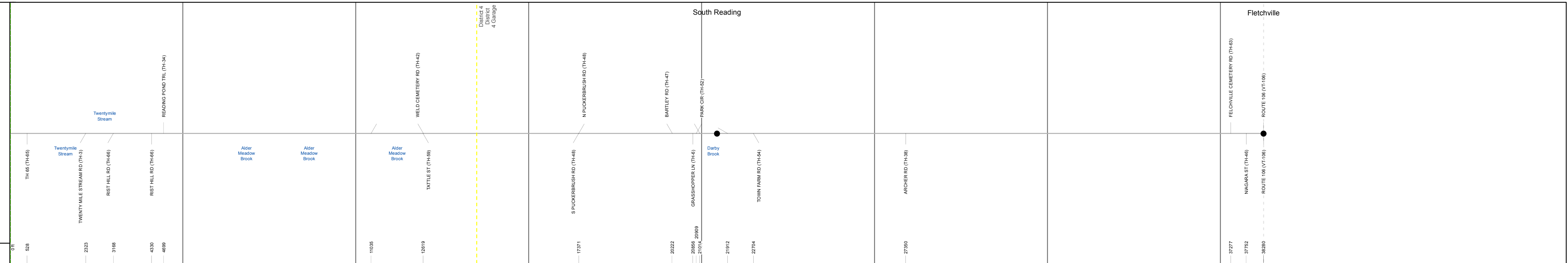

DESCRIPTION BLOCK

Road Widths	<ul style="list-style-type: none"> Travellane Roadway Lane Count Base Subbase 											
Curves												
Grades												
Historic Projects												
Maintenance Garage	(Not State Maintained)											
Traffic Counters			867359		867311				867358		867340	
Functional Class	8											
Speed Zone												
AADT Counts	2012											
2011												
2010												
2009												
2008												
Crash Locations	2012											
2011												
2010												
2009												
2008												

Historic Projects

- Retreatment
- Resurface
- Unknown
- Bituminous Mix
- Skimny Mix
- Bituminous Seal
- Gravel
- Surface Treated Gravel
- Plant Mix
- Reclaimed Base and Bituminous Concrete
- Concrete

Functional Class

1 2 3 4 5 6 7 8 9 10 11 12 13 14 15 16 17 18 19

Curves

- curve left
- curve right

Road Widths

(ft)

AADT

(count)

Mileage by Functional Class By Sheet

0584 8 - Rural - Minor collector 7.250

Mileage by Town By Sheet

READING - S05841414 7.25 of 7.25

DISTRICT

4

TOWN

READING

Date: 04/01/14

ROUTE

Min-0584

ETE mileage: 2.7 to 9.95

1 of 1

TWN mileage: 0.0 to 7.25

Total Mileage: 7.250 mi

For More Information Contact - Vermont Agency of Transportation, Policy, Planning and Intermodal Development Division - Mapping Unit, 1 National Life Drive, Montpelier, VT 05633-5001 Telephone: 802-828-2600.