



Route Log Progress Chart

DRAFT

Please Note: Errors and Omissions May Exist.
Contact the VTrans Mapping Unit with questions or concerns.

DISTRICT	TOWN	ROUTE
8	BERKSHIRE	Maj-0302

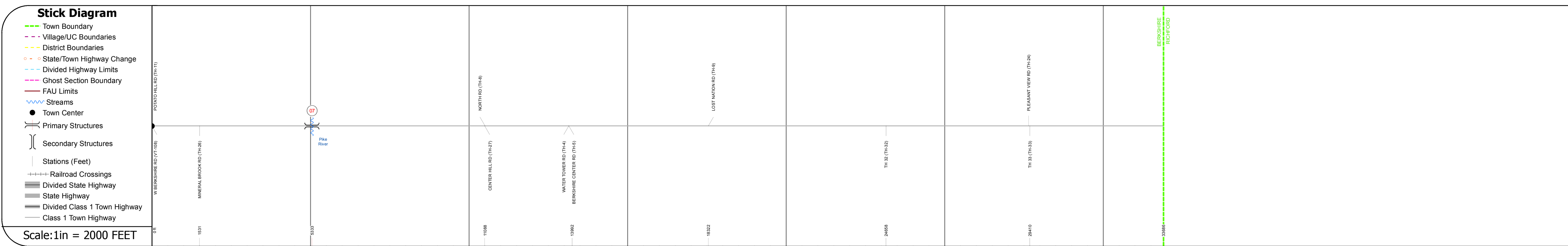
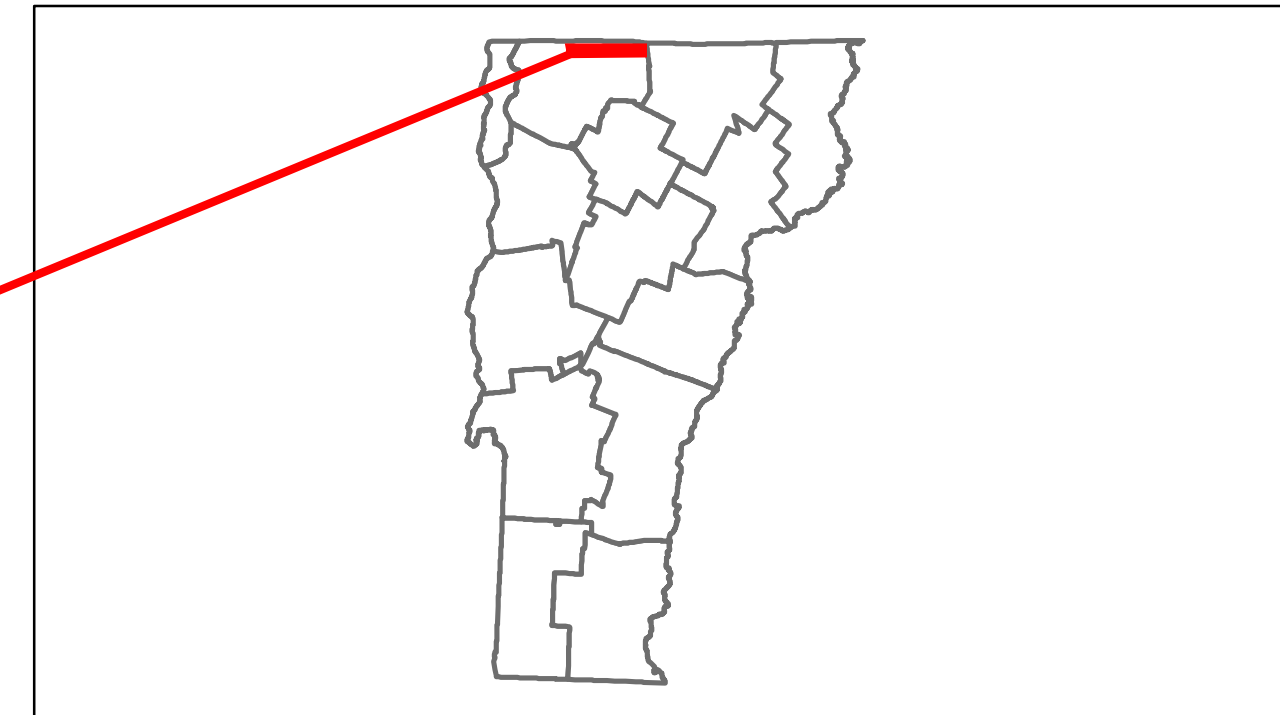

DESCRIPTION BLOCK

Bridge 7:
Stringer/multi-beam or girder - 1947
Structure No. 20030200706022
Length: 69'
Width: 24.9'
Facility Carried: TR 03 FAS 302
Bridge Type: ROLLED BEAM
Features Intersected: PIKE RIVER
Surface: Bituminous
Maintenance/Ownership: Town

Road Widths	Travellane	20
Roadway		
Lane Count		
Base		
Subbase		
Curves		
Grades		
Historic Projects	<p>1978: Unknown</p> <p>1974: Unknown</p> <p>1982: Unknown</p> <p>1975: Unknown</p> <p>1982: Unknown</p> <p>1979: Unknown</p> <p>1970: Unknown</p> <p>1973: Unknown</p> <p>1974: Unknown</p> <p>1956: S 0911</p> <p>1957: S 0922</p>	
Maintenance Garage		(Not State Maintained)
Traffic Counters	<p>567308</p> <p>567309</p> <p>567304</p>	
Functional Class		7
Speed Zone		
AADT Counts	<p>2012: 850</p> <p>2011: 840</p> <p>2010: 850</p> <p>2009: 850</p> <p>2008: 860</p>	<p>830</p> <p>820</p> <p>830</p> <p>850</p> <p>860</p>
Crash Locations	<p>2012</p> <p>2011</p> <p>2010</p> <p>2009</p> <p>2008</p>	<p>2012</p> <p>2011</p> <p>2010</p> <p>2009</p> <p>2008</p>

Historic Projects Retirement, Resurface, Unknown, Bituminous Mix, Skimny Mix, Bituminous Seal, Bituminous Concrete, Surface Treated Gravel, Plant Mix, Reclaimed Base and Bituminous Concrete, Concrete	Functional Class 1, 2, 3, 4, 5, 6, 7, 8, 9, 10, 11, 12, 13, 14, 15, 16, 17, 18, 19	Curves curve left, curve right	Road Widths (ft)	AADT (count)	Mileage by Functional Class By Sheet 0302 7 - Rural - Major collector 6.380	Mileage by Town By Sheet BERKSHIRE - S03020602 6.38 of 6.38	DISTRICT 8	TOWN BERKSHIRE	Date: 04/01/14	ROUTE Maj-0302
					Total Mileage: 6.380 mi	Total Mileage: 6.38 mi	1 of 1 TWN mileage: 0.0 to 6.38	ETE mileage: 0.0 to 6.38		

For More Information Contact - Vermont Agency of Transportation, Policy, Planning and Intermodal Development Division - Mapping Unit, 1 National Life Drive, Montpelier, VT 05633-5001 Telephone: 802-828-2600.