



Route Log Progress Chart

DRAFT

Please Note: Errors and Omissions May Exist.
Contact the VTrans Mapping Unit with questions or concerns.

DISTRICT	TOWN	ROUTE
7	VICTORY	Maj-0277

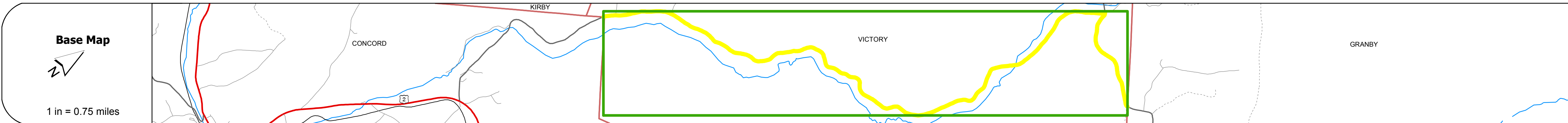
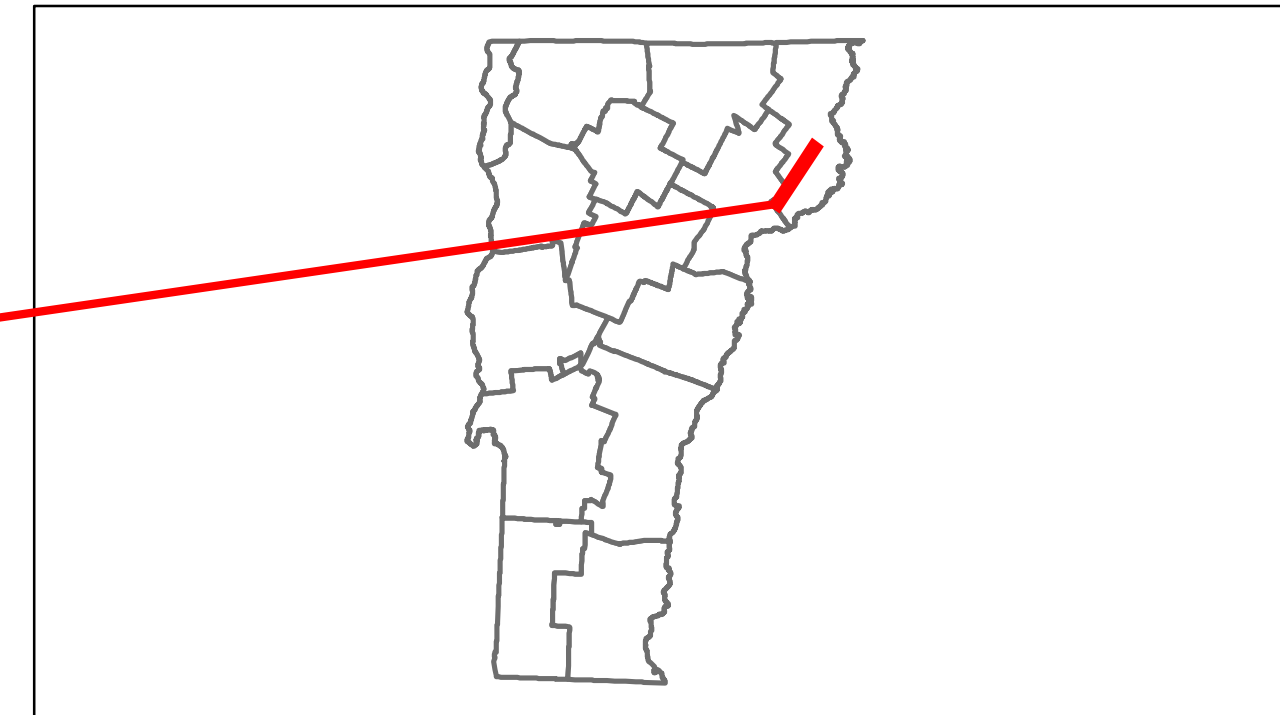

Stick Diagram

- Town Boundary
- Village/UC Boundaries
- District Boundaries
- State/Town Highway Change
- Divided Highway Limits
- Ghost Section Boundary
- FAU Limits
- Streams
- Town Center
- Primary Structures
- Secondary Structures
- Stations (Feet)
- Railroad Crossings
- Divided State Highway
- State Highway
- Divided Class 1 Town Highway
- Class 1 Town Highway

Scale: 1in = 2000 FEET

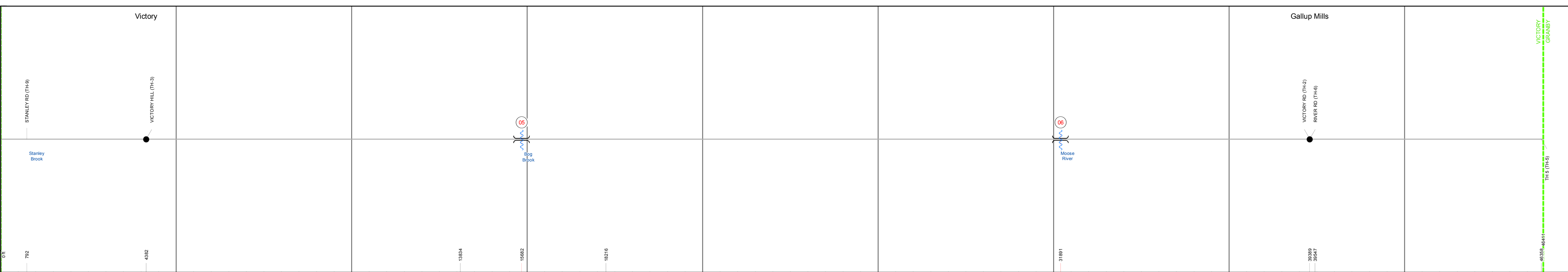

DESCRIPTION BLOCK

Bridge 5:
Stringer/multi-beam or girder - 1934
Structure No. 200277000505172
Length: 54'
Width: 24.0'
Facility Carried: TR 01 FAS 277
Bridge Type: ROLLED BEAM
Features Intersected: BOG BROOK
Maintenance/Ownership: Town

Bridge 6:
Stringer/multi-beam or girder - 1975
Structure No. 200277000605172
Length: 101'
Width: 26.6'
Facility Carried: TR 01 FAS 277
Bridge Type: WELDED PLATE GIRDER
Features Intersected: MOOSE RIVER
Maintenance/Ownership: Town

Road Widths	Travellane	← 25 →
	Roadway	← 25 →
	Lane Count	← 24 →
	Base	← 20 →
	Subbase	← 18 →

Curves	
---------------	--

Grades	
---------------	--

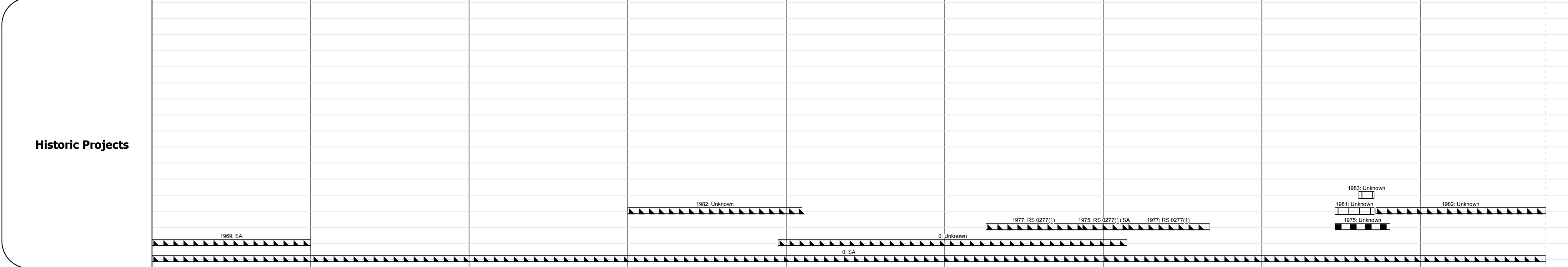

Maintenance Garage	(Not State Maintained)
---------------------------	------------------------

Traffic Counters	SREZAJ, SRE311, SREZAY, SRE312
-------------------------	--------------------------------

Functional Class	7
-------------------------	---

Speed Zone	
-------------------	--

ADT Counts	2012: 160, 270, 130
	2011: 160, 270, 130
	2010: 210, 270, 140
	2009: 260, 280, 160
	2008: 300, 280, 170

Crash Locations	2012, 2011, 2010, 2009, 2008
------------------------	------------------------------

<p>Historic Projects</p> <ul style="list-style-type: none"> Retreatment Resurface Unknown Bituminous Mix Skimny Mix Bituminous Seal Gravel Surface Treated Gravel Plant Mix Reclaimed Base and Bituminous Concrete Concrete 	<p>Functional Class</p> <ul style="list-style-type: none"> 1 (Blue) 2 (Red) 3 (Green) 4 (Yellow) 5 (Purple) 6 (Orange) 7 (Pink) 8 (Light Blue) 9 (Light Green) 10 (Light Yellow) 11 (Light Purple) 12 (Light Orange) 13 (Light Pink) 14 (Light Light Blue) 15 (Light Light Green) 16 (Light Light Yellow) 17 (Light Light Purple) 18 (Light Light Orange) 19 (Light Light Pink) <p>Speed Zones</p> <ul style="list-style-type: none"> 25, 30, 35, 40, 45, 50, 55, 60, 65 	<p>Curves</p> <ul style="list-style-type: none"> curve left curve right <p>Grades</p> <ul style="list-style-type: none"> grade up grade down 	<p>Road Widths</p> <p>(ft)</p>	<p>Traffic Counters</p> <p>(counter ID)</p>	<p>Crash Locations</p> <ul style="list-style-type: none"> Fatal Injury Property Damage Only Unknown Crash Type 	<p>Mileage by Functional Class By Sheet</p> <p>0277 7 - Rural - Major collector 8.790</p>	<p>Mileage by Town By Sheet</p> <p>VICTORY - S02770517 8.79 of 8.79</p>	<p>DISTRICT</p> <p>7</p>	<p>TOWN</p> <p>VICTORY</p>	<p>Date: 04/01/14</p>	<p>ROUTE</p> <p>Maj-0277</p> <p>ETE mileage: 2.62 to 11.41</p>	
							<p>Total Mileage: 8.790 mi</p>		<p>Total Mileage: 8.79 mi</p>		<p>1 of 1</p> <p>TWN mileage: 0.0 to 8.79</p>	

For More Information Contact - Vermont Agency of Transportation, Policy, Planning and Intermodal Development Division - Mapping Unit, 1 National Life Drive, Montpelier, VT 05633-5001 Telephone: 802-828-2600.