



Route Log Progress Chart

DRAFT

Please Note: Errors and Omissions May Exist.
Contact the VTrans Mapping Unit with questions or concerns.

DISTRICT	TOWN	ROUTE
5	JERICO	Maj-0209

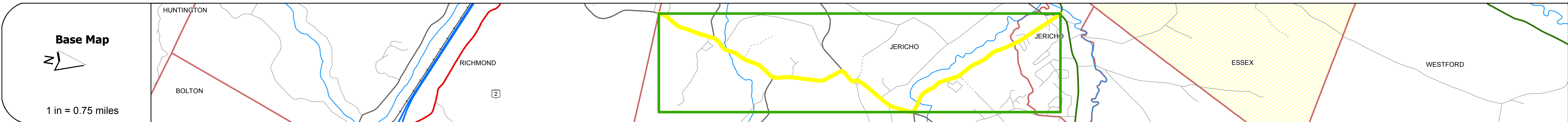
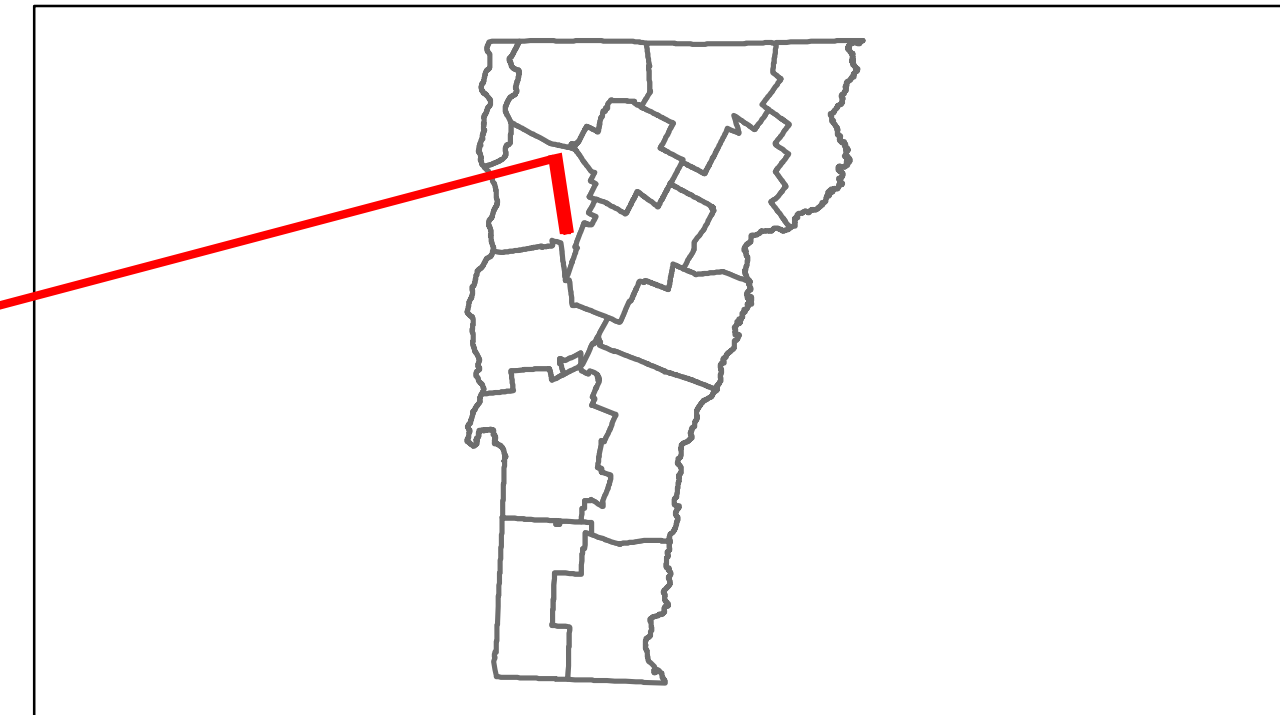

Stick Diagram

- Town Boundary
- Village/UC Boundaries
- District Boundaries
- State/Town Highway Change
- Divided Highway Limits
- Ghost Section Boundary
- FAU Limits
- Streams
- Town Center
- Primary Structures
- Secondary Structures
- Stations (Feet)
- Railroad Crossings
- Divided State Highway
- State Highway
- Divided Class 1 Town Highway
- Class 1 Town Highway

Scale: 1in = 2000 FEET

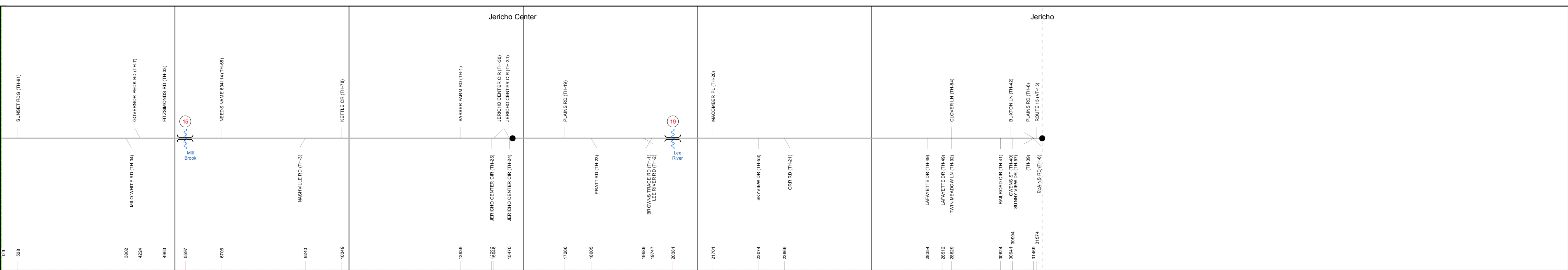

DESCRIPTION BLOCK

Bridge 15:
Tee Beam - 1927
Structure No. 200209001504092
Length: 39'
Width: 31.9'
Facility Carried: TR 04 FAS 209
Bridge Type: CONCRETE T-BEAM
Features Intersected: MILL BROOK
Surface: Bituminous
Maintenance/Ownership: Town

Bridge 16:
Stringer/multi-beam or girder - 1941
Structure No. 200209001904092
Length: 84'
Width: 25.5'
Facility Carried: TR 02 FAS 209
Bridge Type: ROLLED BEAM
Features Intersected: LEE RIVER
Surface: Bituminous
Maintenance/Ownership: Town

Road Widths	Travellane	22	22
Roadway	24		
Lane Count			
Base			
Subbase			

Curves	
---------------	--

Grades	
---------------	--

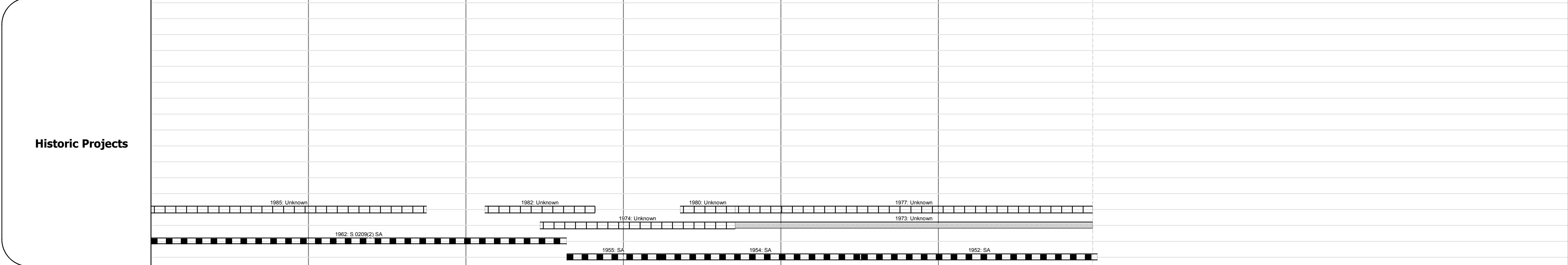

Maintenance Garage	
---------------------------	--

Traffic Counters	860300	860409	860410	860322
-------------------------	--------	--------	--------	--------

Functional Class	7
-------------------------	---

Speed Zone	
-------------------	--

AADT Counts	2012	3000	3000	3800	1200	3800
	2011	3000	3200	3800	1200	3800
	2010	3200	3200	3900	1300	3800
	2009	3500	3500	4000	1400	3900
	2008	3700	3700	4000	1500	3900

Crash Locations	2012					
	2011					
	2010					
	2009					
	2008					

Historic Projects Retreatment, Resurface, Unknown, Bituminous Mix, Skimny Mix, Bituminous Seal, Bituminous Concrete, Gravel, Surface Treated Gravel, Plant Mix, Reclaimed Base and Bituminous Concrete, Concrete	Functional Class 1-19, 6-16 Speed Zones 25, 30, 35, 40, 45, 50, 55, 60, 65	Curves curve left, curve right Grades grade up, grade down	Road Widths (ft) Traffic Counters (counter ID)	AADT (count) Crash Locations Fatal, Injury, Property Damage Only, Unknown Crash Type	Mileage by Functional Class By Sheet 0209 7 - Rural - Major collector 5.980	Mileage by Town By Sheet JERICHO - S02090409 5.98 of 5.98	DISTRICT 5	TOWN JERICHO	Date: 04/01/14	ROUTE Maj-0209 ETE mileage: 11.81 to 17.79
					Total Mileage: 5.98 mi					

For More Information Contact - Vermont Agency of Transportation, Policy, Planning and Intermodal Development Division - Mapping Unit, 1 National Life Drive, Montpelier, VT 05633-5001 Telephone: 802-828-2600.