



# Route Log Progress Chart

**DRAFT**

Please Note: Errors and Omissions May Exist.  
Contact the VTrans Mapping Unit with questions or concerns.

DISTRICT	TOWN	ROUTE
6	WARREN	Maj-0188

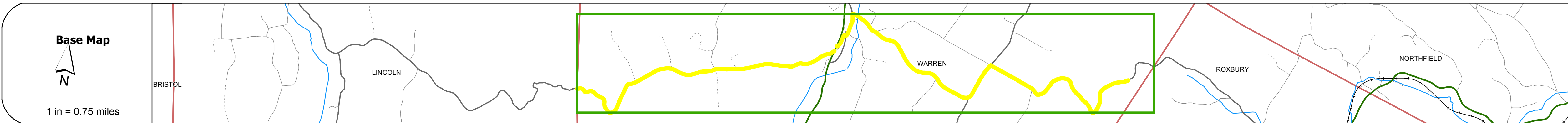
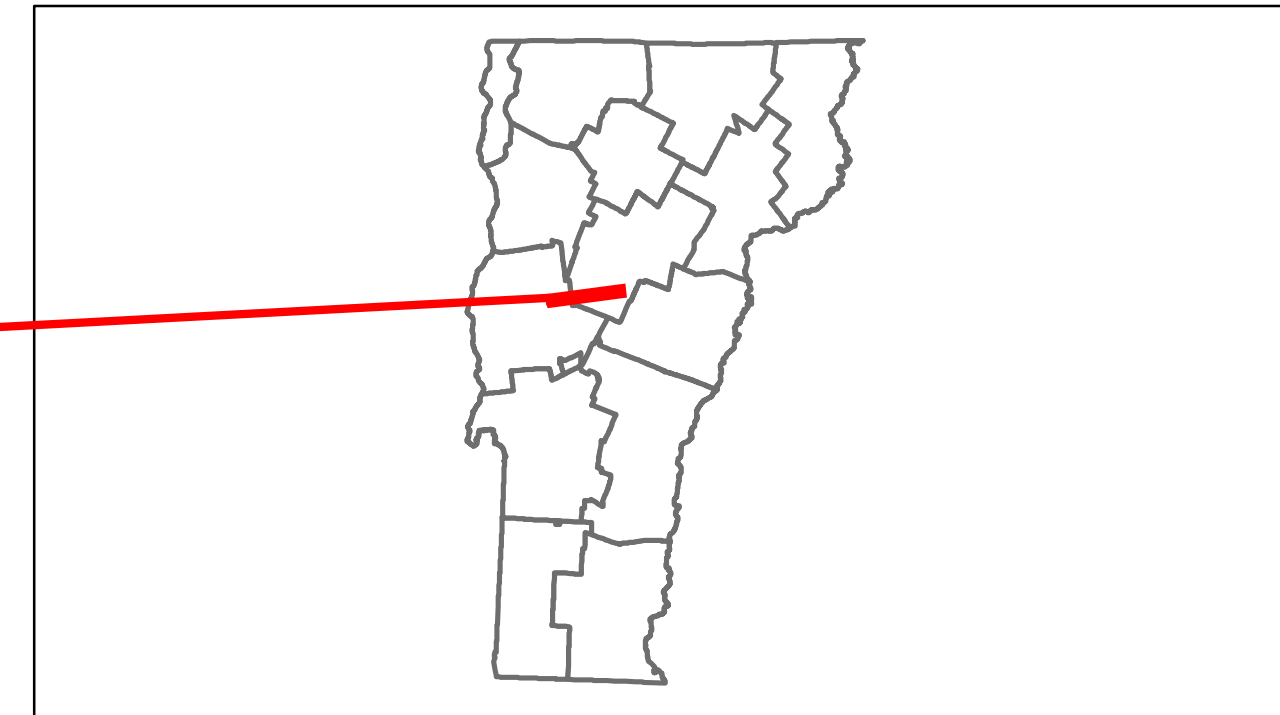

**Stick Diagram**

- Town Boundary
- Village/UC Boundaries
- District Boundaries
- State/Town Highway Change
- Divided Highway Limits
- Ghost Section Boundary
- FAU Limits
- Streams
- Town Center
- Primary Structures
- Secondary Structures
- Stations (Feet)
- Railroad Crossings
- Divided State Highway
- State Highway
- Divided Class 1 Town Highway
- Class 1 Town Highway

Scale: 1in = 2000 FEET

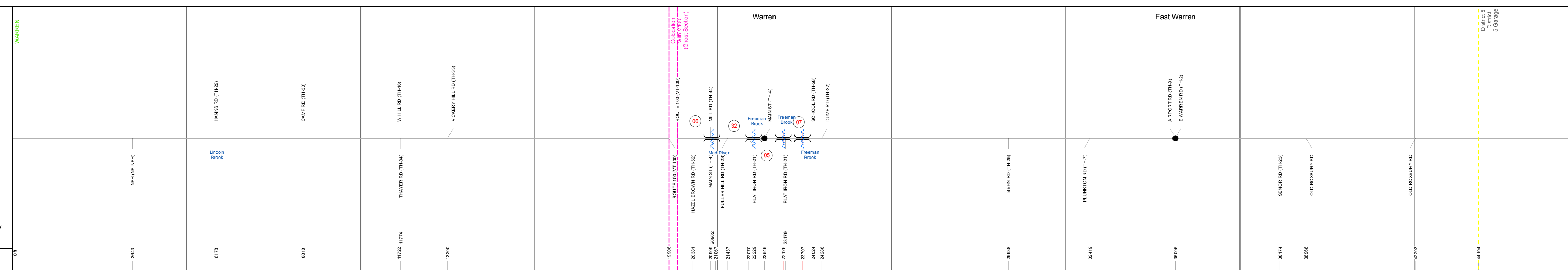

## DESCRIPTION BLOCK

**Bridge 6:**  
Truss - thru - 1879  
Structure No. 200188000612172  
Length: 58'  
Height: 10.0'  
Width: 13.4'  
Weight Limit: 0  
Facility Carried: TR 03 FAS 188  
Bridge Type: QUEEN POST COV. BR.  
Features Intersected: MAD RIVER  
1  
Covered: MAD RIVER  
Surface: Timber  
Maintenance/Ownership: Town

**Bridge 32:**  
Tee Beam - 1936  
Structure No. 200188003212172  
Length: 33'  
Width: 25.5'  
Facility Carried: TR 04 FAS 188  
Bridge Type: CONCRETE T-BEAM  
Features Intersected: FREEMANS BROOK  
Surface: Bituminous  
Maintenance/Ownership: Town

**Bridge 5:**  
Slab - 1963  
Structure No. 200188000512172  
Length: 25'  
Width: 31.3'  
Facility Carried: TR 01 FAS 188  
Bridge Type: CONCRETE SLAB  
Features Intersected: FREEMANS BROOK  
Surface: Bituminous  
Maintenance/Ownership: Town

**Bridge 7:**  
Stringer/multi-beam or girder - 1947  
Structure No. 200188000712172  
Length: 64'  
Width: 23.7'  
Facility Carried: TR 01 FAS 188  
Bridge Type: STEEL BEAM  
Features Intersected: FREEMANS BROOK  
Surface: Bituminous  
Maintenance/Ownership: Town

Travellane	18	22	22	22	22	24	24
Roadway	20	22	22	22	22	24	24
Lane Count							
Base							
Subbase					18" Gravel		

<b>Curves</b>							
---------------	--	--	--	--	--	--	--

<b>Grades</b>							
---------------	--	--	--	--	--	--	--

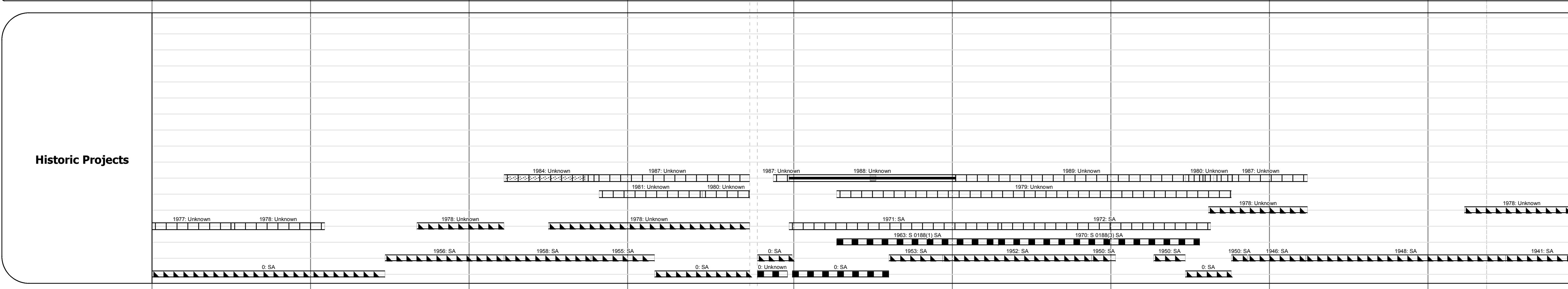

<b>Maintenance Garage</b>							(Not State Maintained)
---------------------------	--	--	--	--	--	--	------------------------

<b>Traffic Counters</b>	56W259	56W270	56W41	56W380	56W356	56W358	
-------------------------	--------	--------	-------	--------	--------	--------	--

<b>Functional Class</b>	7						
-------------------------	---	--	--	--	--	--	--

<b>Speed Zone</b>							
-------------------	--	--	--	--	--	--	--

<b>ADT Counts</b>	2012	270	520	580	810	990	670
	2011	270	510	570	800	980	660
	2010	270	510	590	810	990	660
	2009	280	520	610	810	990	670
	2008	280	520	620	820	1000	670

<b>Crash Locations</b>	2012						
	2011						
	2010						
	2009						
	2008						

<p><b>Historic Projects</b></p> <ul style="list-style-type: none"> <li>Retreatment</li> <li>Resurface</li> <li>Unknown</li> <li>Bituminous Mix</li> <li>Skimny Mix</li> <li>Bituminous Seal</li> <li>Gravel</li> <li>Surface Treated Gravel</li> <li>Plant Mix</li> <li>Reclaimed Base and Bituminous Concrete</li> <li>Concrete</li> </ul>	<p><b>Functional Class</b></p> <ul style="list-style-type: none"> <li>1</li> <li>2</li> <li>6</li> <li>7</li> <li>8</li> <li>11</li> <li>12</li> <li>14</li> <li>16</li> <li>17</li> <li>19</li> </ul> <p><b>Speed Zones</b></p> <ul style="list-style-type: none"> <li>25</li> <li>30</li> <li>35</li> <li>40</li> <li>45</li> <li>50</li> <li>55</li> <li>60</li> <li>65</li> </ul>	<p><b>Curves</b></p> <ul style="list-style-type: none"> <li>curve left</li> <li>curve right</li> </ul>	<p><b>Road Widths</b></p> <p>(ft)</p>	<p><b>Traffic Counters</b></p> <p>(counter ID)</p>	<p><b>Crash Locations</b></p> <ul style="list-style-type: none"> <li>Fatal</li> <li>Injury</li> <li>Property Damage Only</li> <li>Unknown Crash Type</li> </ul>	<p><b>Mileage by Functional Class By Sheet</b></p> <p>0188 7 - Rural - Major collector 9.000</p>	<p><b>Mileage by Town By Sheet</b></p> <p>WARREN - S01881217 9.0 of 9.528 Ghost Section - VT-100 (3.447 to 3.495) 0.048</p>	<p><b>DISTRICT</b></p> <p>6</p>	<p><b>TOWN</b></p> <p>WARREN</p>	<p><b>Date:</b> 04/01/14</p>	<p><b>ROUTE</b></p> <p>Maj-0188</p> <p>ETE mileage: 8.37 to 17.37</p>
						<p><b>Total Mileage: 9.000 mi</b></p>		<p><b>Total Mileage: 9.0 mi</b></p>		<p><b>1 of 2</b></p> <p>TWN mileage: 0.0 to 9.0</p>	

For More Information Contact - Vermont Agency of Transportation, Policy, Planning and Intermodal Development Division - Mapping Unit, 1 National Life Drive, Montpelier, VT 05633-5001 Telephone: 802-828-2600.