



Route Log Progress Chart

DRAFT

Please Note: Errors and Omissions May Exist.
Contact the VTrans Mapping Unit with questions or concerns.

DISTRICT	TOWN	ROUTE
3	PITTSFORD	Maj-0155

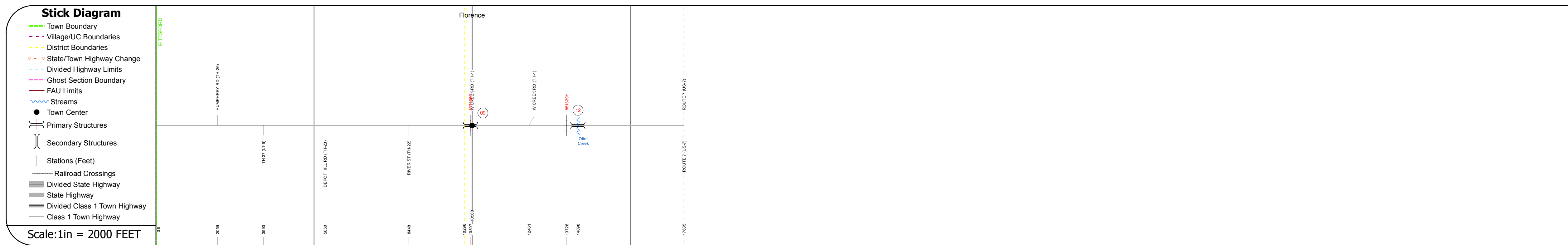
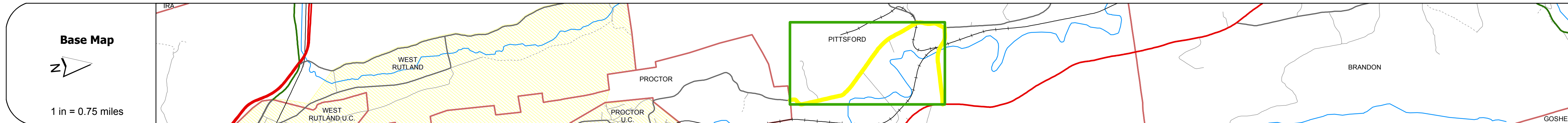
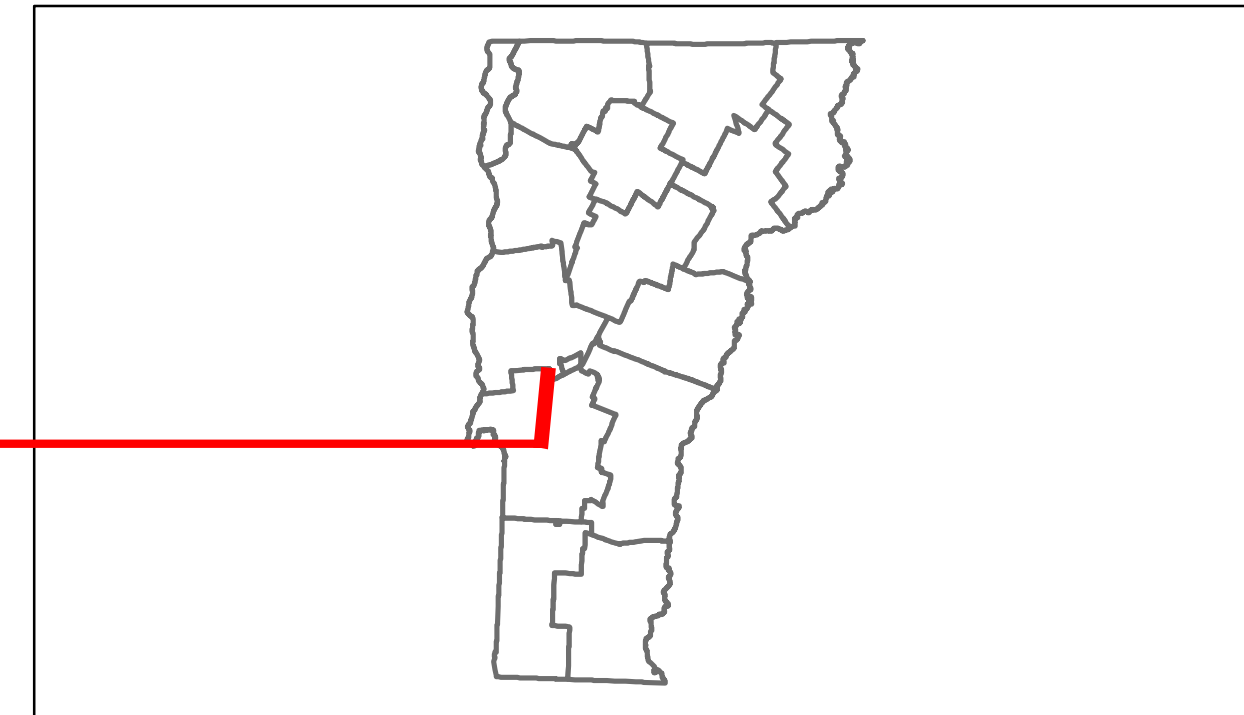

DESCRIPTION BLOCK

Bridge 9:
Stringer/multi-beam or girder - 1900
Structure No: 20015500911162
Length: 26'
Height: 0.0'
Facility Carried: RAILROAD
Bridge Type: ROLLED BEAM
Features Intersected: CL+P RR OVER TH NO 1

Bridge 12:
Stringer/multi-beam or girder - 1960
Structure No: 200155001211162
Length: 276'
Width: 26.0'
Weight Limit: 0
Facility Carried: TR 02 FAS 155
Bridge Type: 4 SPAN ROLLED BEAM
Features Intersected: OTTER CREEK
Maintenance/Ownership: Town

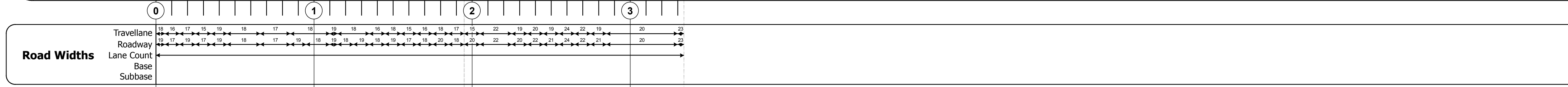

Curves

Grades

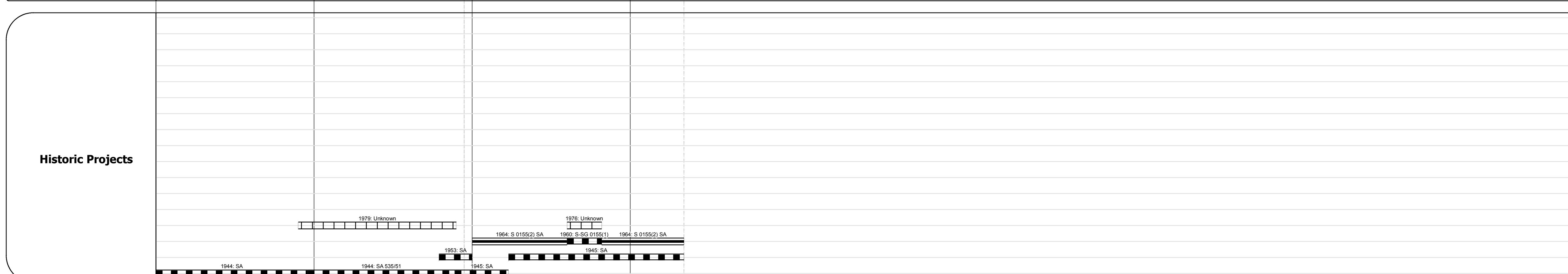

Maintenance Garage
(Not State Maintained)

Traffic Counters
586344, 586343

Functional Class
7

Speed Zone

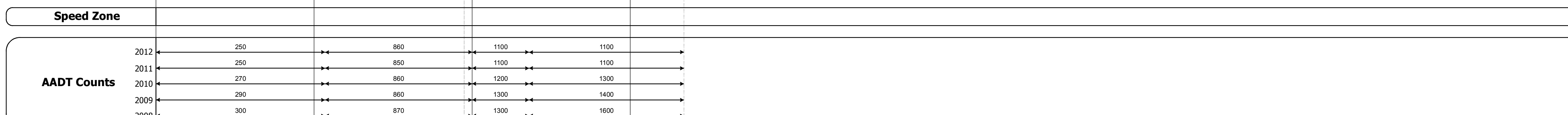

Crash Locations	
2012	
2011	
2010	
2009	
2008	

Historic Projects Retreatment, Resurface, Unknown, Bituminous Mix, Skippy Mix, Bituminous Seal, Bituminous Concrete, Gravel, Surface Treated Gravel, Plant Mix, Reclaimed Base and Bituminous Concrete, Concrete	Functional Class 1-19, 2-19, 6-16, Speed Zones: 25, 30, 35, 40, 45, 50, 55, 60, 65	Curves curve left, curve right	Road Widths (ft)	AADT (count)	Crash Locations Fatal, Injury, Property Damage Only, Unknown Crash Type	Mileage by Functional Class By Sheet 0155 7 - Rural - Major collector 3.340	Mileage by Town By Sheet PITTSFORD - S01551116 3.34 of 3.34	DISTRICT 3	TOWN PITTSFORD	Date: 04/01/14	ROUTE Maj-0155 ETE mileage: 1.95 to 5.29
Total Mileage: 3.340 mi						Total Mileage: 3.34 mi					

For More Information Contact - Vermont Agency of Transportation, Policy, Planning and Intermodal Development Division - Mapping Unit, 1 National Life Drive, Montpelier, VT 05633-5001 Telephone: 802-828-2600.