



Route Log Progress Chart

DRAFT

Please Note: Errors and Omissions May Exist.
Contact the VTrans Mapping Unit with questions or concerns.

DISTRICT	TOWN	ROUTE
2	SPRINGFIELD	Maj-0136

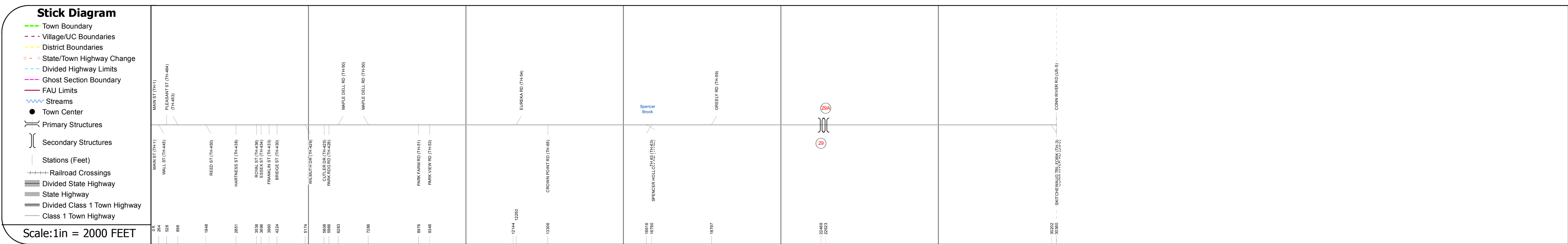
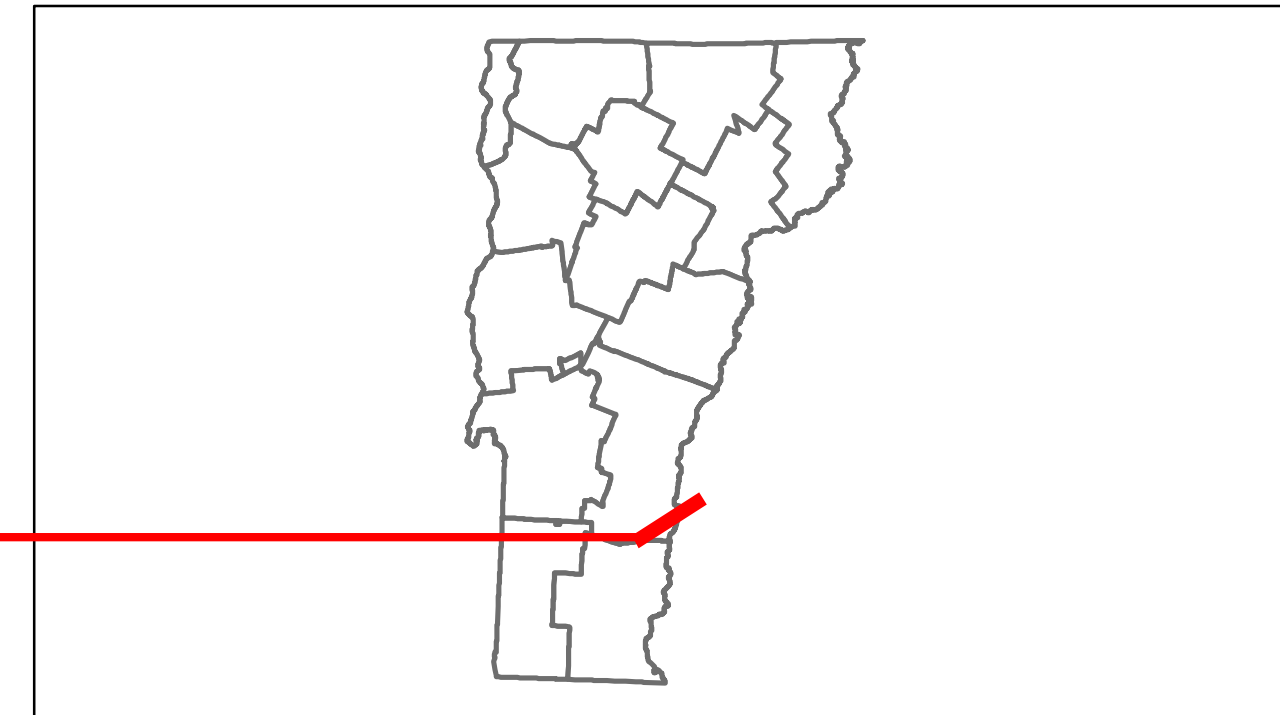

DESCRIPTION BLOCK
<p>Bridge 29: Stringer/multi-beam or girder - 1965 Structure No. 200091029S14182 Length: 123' Height: 0.0' Weight Limit: 0 Facility Carried: 1 00091 ML Bridge Type: 3 SP CONT ROLLED BM Features Intersected: 1 91 OVER TH NO 3</p> <p>Bridge 29A: Stringer/multi-beam or girder - 1965 Structure No. 200091029N14182 Length: 123' Height: 0.0' Weight Limit: 0 Facility Carried: 1 00091 ML Bridge Type: 3 SP CONT ROLLED BM Features Intersected: 1 91 OVER TH NO 3</p>

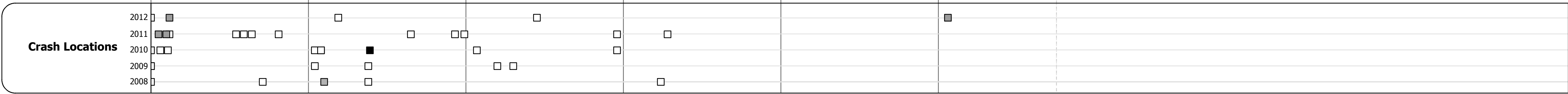
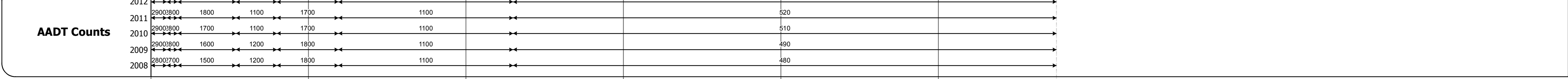
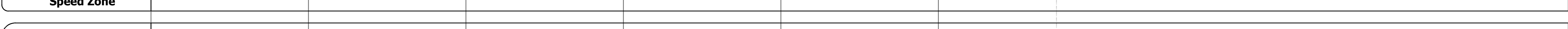
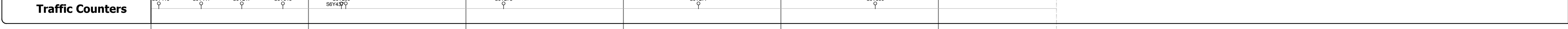
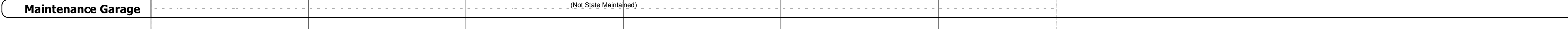
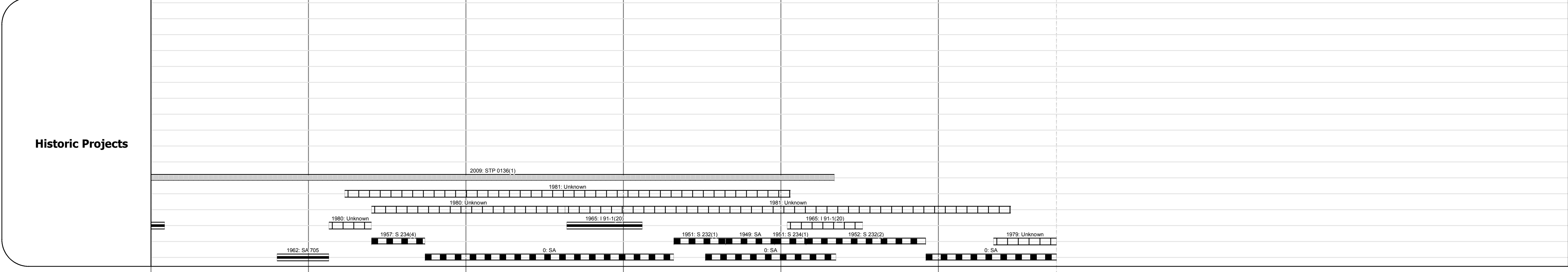
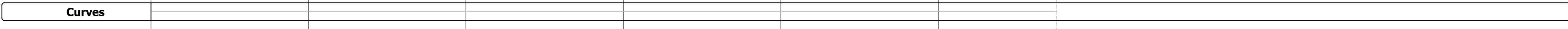
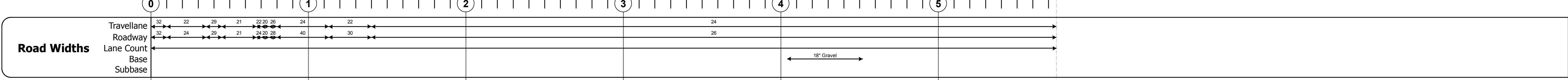

Historic Projects	Functional Class	Curves	Road Widths	AADT	Mileage by Functional Class By Sheet	Mileage by Town By Sheet	DISTRICT	TOWN	Date: 04/01/14	ROUTE
<ul style="list-style-type: none"> Retreatment Resurface Unknown Bituminous Mix Skimny Mix Bituminous Seal Concrete Gravel Surface Treated Gravel Plant Mix Reclaimed Base and Bituminous Concrete 	<ul style="list-style-type: none"> 1 2 6 7 11 12 14 16 17 19 	<ul style="list-style-type: none"> curve left curve right 	<ul style="list-style-type: none"> (ft) 	<ul style="list-style-type: none"> (count) 	0136 7 - Rural - Major collector 5.750	SPRINGFIELD - S01361418 5.75 of 5.75	2	SPRINGFIELD	1 of 1 TWN mileage: 0.0 to 5.75	Maj-0136 ETE mileage: 0.0 to 5.75
Total Mileage: 5.750 mi						Total Mileage: 5.75 mi				

For More Information Contact - Vermont Agency of Transportation, Policy, Planning and Intermodal Development Division - Mapping Unit, 1 National Life Drive, Montpelier, VT 05633-5001 Telephone: 802-828-2600.