



Route Log Progress Chart

DRAFT

Please Note: Errors and Omissions May Exist.
Contact the VTrans Mapping Unit with questions or concerns.

DISTRICT	TOWN	ROUTE
1	RUPERT	Maj-0122

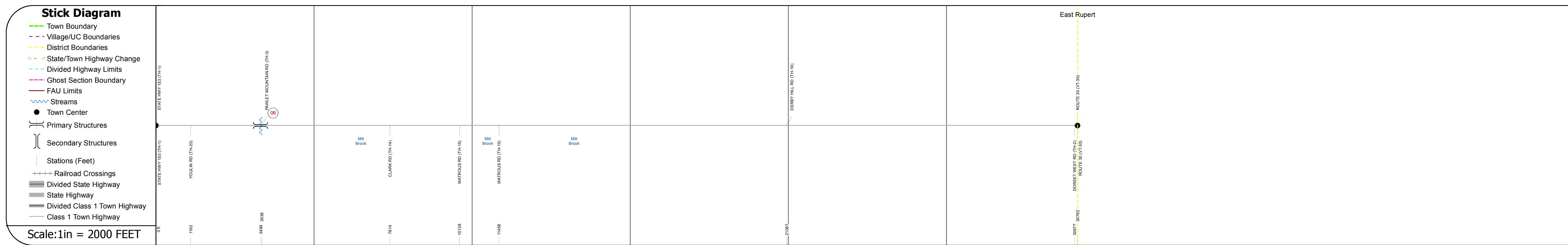
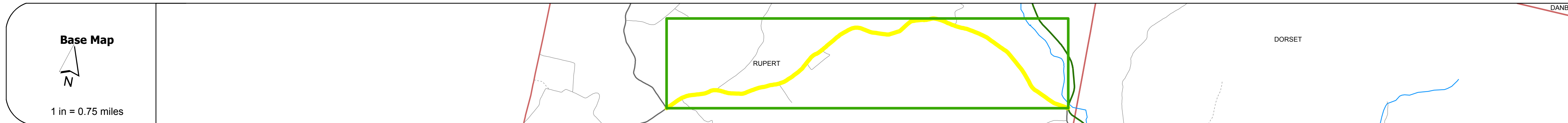
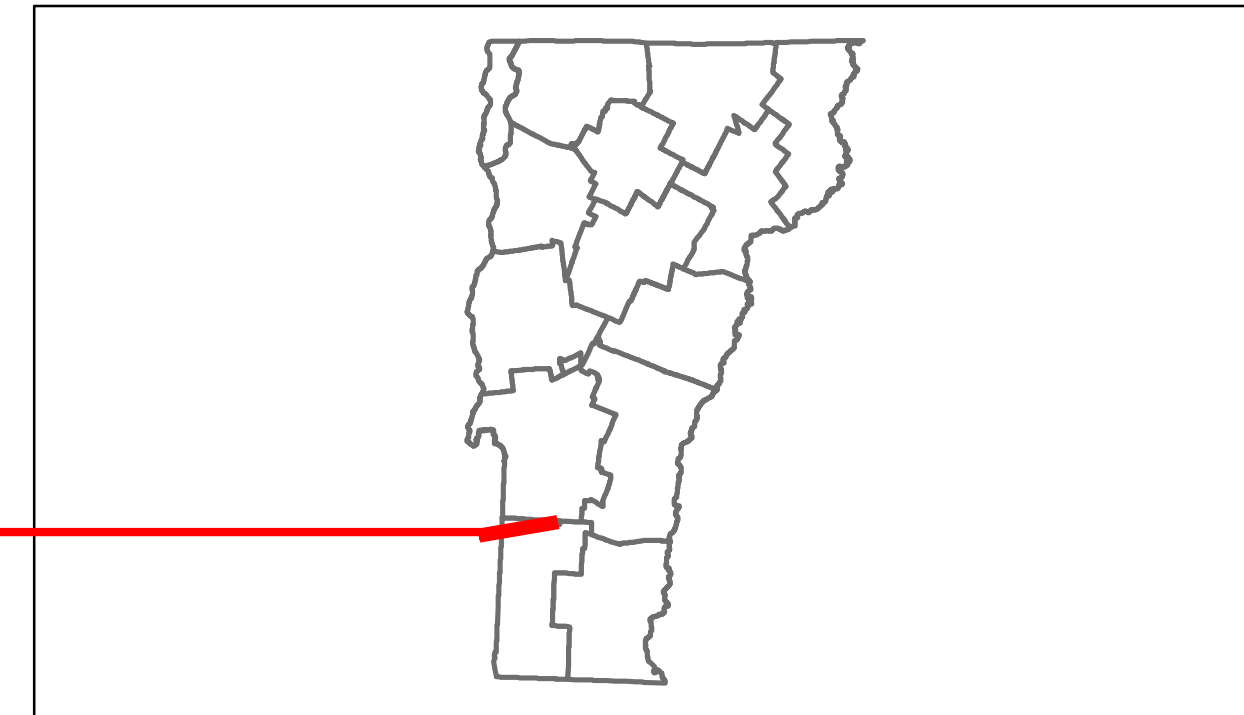

DESCRIPTION BLOCK

Culvert 6:
Culvert - 2004
Structure No. 200122000602102
Length: 32
Weight Limit: 0
Facility Carried: TR 02 FAS 122
Bridge Type: RC BOX (Segmental)
Features Intersected: MILL BROOK
Maintenance/Ownership: Town

Road Widths	Travellane	Roadway	Lane Count	Base	Subbase

Curves	
--------	--

Grades	
--------	--

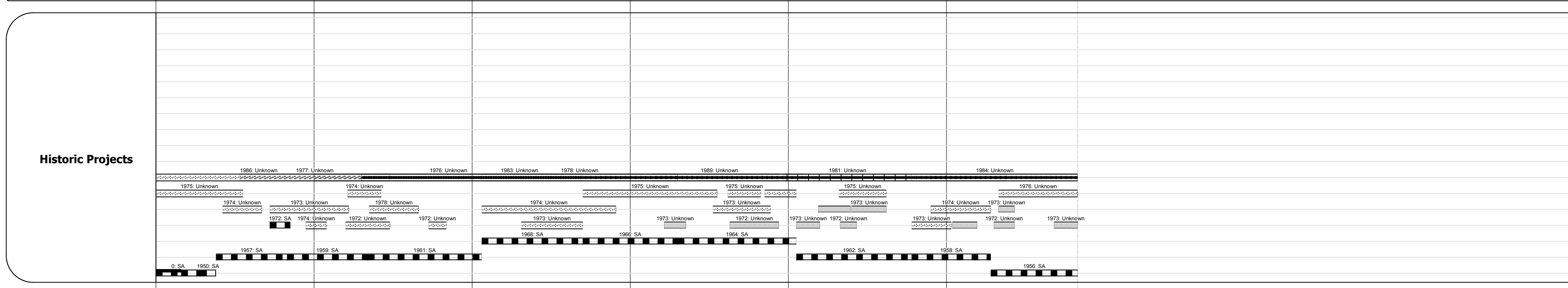

Maintenance Garage	(Not State Maintained)
--------------------	------------------------

Traffic Counters	566701	566321
------------------	--------	--------

Functional Class	7
------------------	---

Speed Zone	
------------	--

AADT Counts	2012: 880	2011: 870	2010: 880	2009: 900	2008: 910
-------------	-----------	-----------	-----------	-----------	-----------

Crash Locations	2012: 1	2011: 1	2010: 1	2009: 1	2008: 1
-----------------	---------	---------	---------	---------	---------

Historic Projects Retreatment, Resurface, Unknown, Bituminous Mix, Skippy Mix, Bituminous Seal, Bituminous Concrete, Gravel, Surface Treated Gravel, Plant Mix, Reclaimed Base and Bituminous Concrete, Concrete	Functional Class 1, 2, 3, 4, 5, 6, 7, 8, 9, 10, 11, 12, 13, 14, 15, 16, 17, 18, 19	Curves curve left, curve right	Road Widths (ft)	AADT (count)	Mileage by Functional Class By Sheet 0122 7 - Rural - Major collector 5.830	Mileage by Town By Sheet RUPERT - S01220210 5.83 of 5.83	DISTRICT 1	TOWN RUPERT	Date: 04/01/14	ROUTE Maj-0122 ETE mileage: 0.0 to 5.83
Speed Zones 25, 30, 35, 40, 45, 50, 55, 60, 65						Crash Locations Fatal, Injury, Property Damage Only, Unknown Crash Type		Total Mileage: 5.830 mi		

For More Information Contact - Vermont Agency of Transportation, Policy, Planning and Intermodal Development Division - Mapping Unit, 1 National Life Drive, Montpelier, VT 05633-5001 Telephone: 802-828-2600.