



Route Log Progress Chart

DRAFT

Please Note: Errors and Omissions May Exist.
Contact the VTrans Mapping Unit with questions or concerns.

DISTRICT	TOWN	ROUTE
2	CHESTER	Min-0562

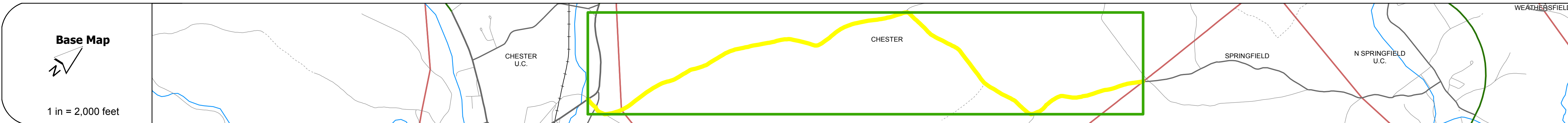
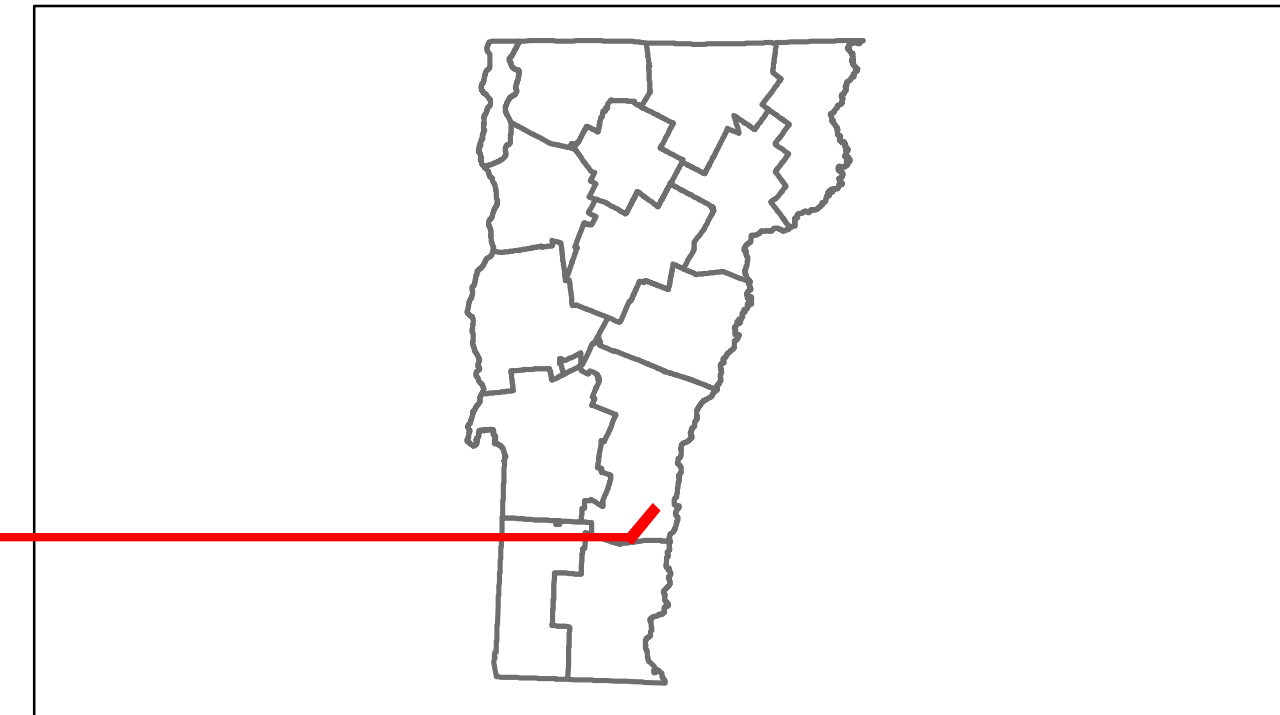

Stick Diagram

- Town Boundary
- Village/UC Boundaries
- District Boundaries
- State/Town Highway Change
- Divided Highway Limits
- Ghost Section Boundary
- FAU Limits
- Streams
- Town Center
- Primary Structures
- Secondary Structures
- Stations (Feet)
- Railroad Crossings
- Divided State Highway
- State Highway
- Divided Class 1 Town Highway
- Class 1 Town Highway

Scale: 1 INCH = 2000 FEET

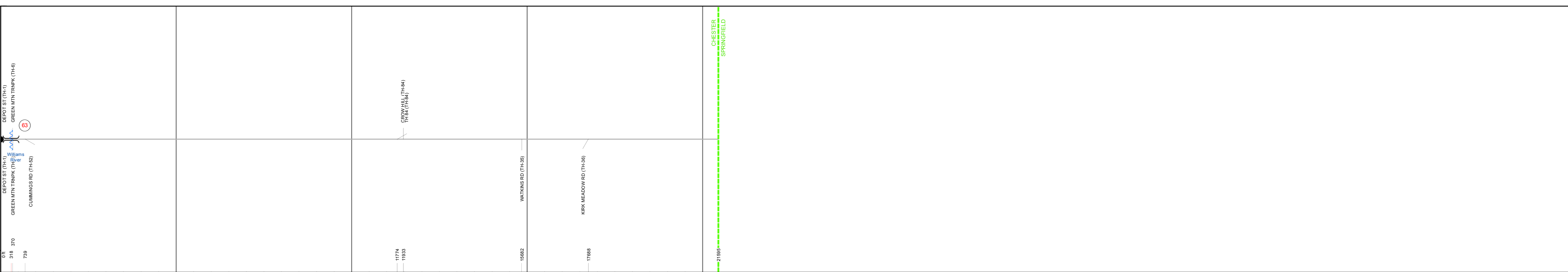

DESCRIPTION BLOCK

Bridge 63:
 Stringer/multi-beam or girder - 1919
 Structure No: 101407006314071
 Length: 45'
 Width: 15.1'
 Facility Carried: C2009
 Bridge Type: ROLLED BM TIMBER DK
 Features Intersected: WILLIAMS RIVER
 Surface: Timber
 Maintenance/Ownership: Town

Road Widths	Travellane				
	Roadway				
	Lane Count				
	Base				
	Subbase				
Curves					
Grades					
Historic Projects					
Maintenance Garage		(Not State Maintained)			
Traffic Counters	♂ 80201	♀ 80205			
Functional Class	8				
Speed Zone					
ADT Counts	2012				
	2011				
	2010				
	2009				
	2008				
Crash Locations	2012				
	2011				
	2010				
	2009				
	2008				

Historic Projects Retreatment, Resurface, Unknown, Bituminous Mix, Skimmy Mix, Bituminous Seal, Bituminous Concrete, Surface Treated Gravel, Plant Mix, Reclaimed Base and Bituminous Concrete, Concrete	Functional Class 1-19, 6-16 Speed Zones 25, 30, 35, 40, 45, 50, 55, 60, 65	Curves Left, Right Grades grade up, grade down	Road Widths (ft) Traffic Counters (counter ID)	ADT (count) Crash Locations Fatal, Injury, Property Damage Only, Unknown Crash Type	Mileage by Functional Class By Sheet 0562 8 - Rural - Minor collector 4.090 Total Mileage: 4.090 mi	Mileage by Town By Sheet CHESTER - S05621407 4.09 of 4.09 Total Mileage: 4.09 mi	DISTRICT 2	TOWN CHESTER	Date: 05/21/14 1 of 1 TWN mileage: 0.0 to 4.09	ROUTE Min-0562 ETE mileage: 0.0 to 4.09
--	---	---	---	--	---	--	----------------------	------------------------	---	--