



Route Log Progress Chart

DRAFT

Please Note: Errors and Omissions May Exist.
Contact the VTrans Mapping Unit with questions or concerns.

DISTRICT	TOWN	ROUTE
2	GUILFORD	Min-0510

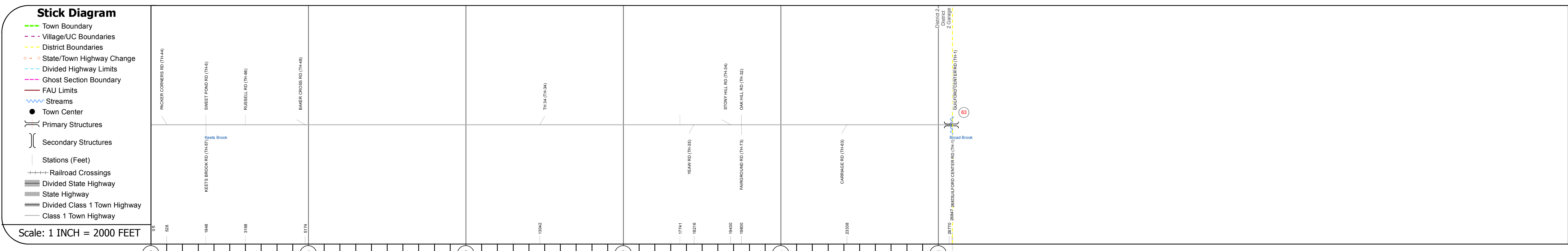
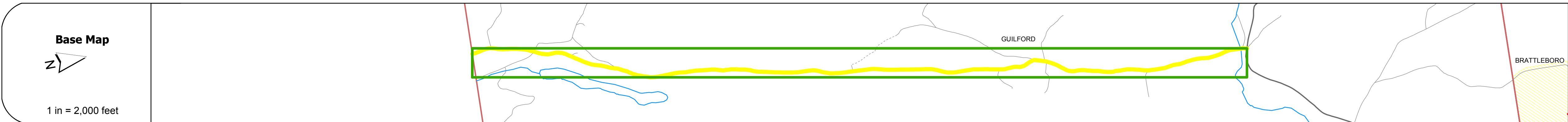
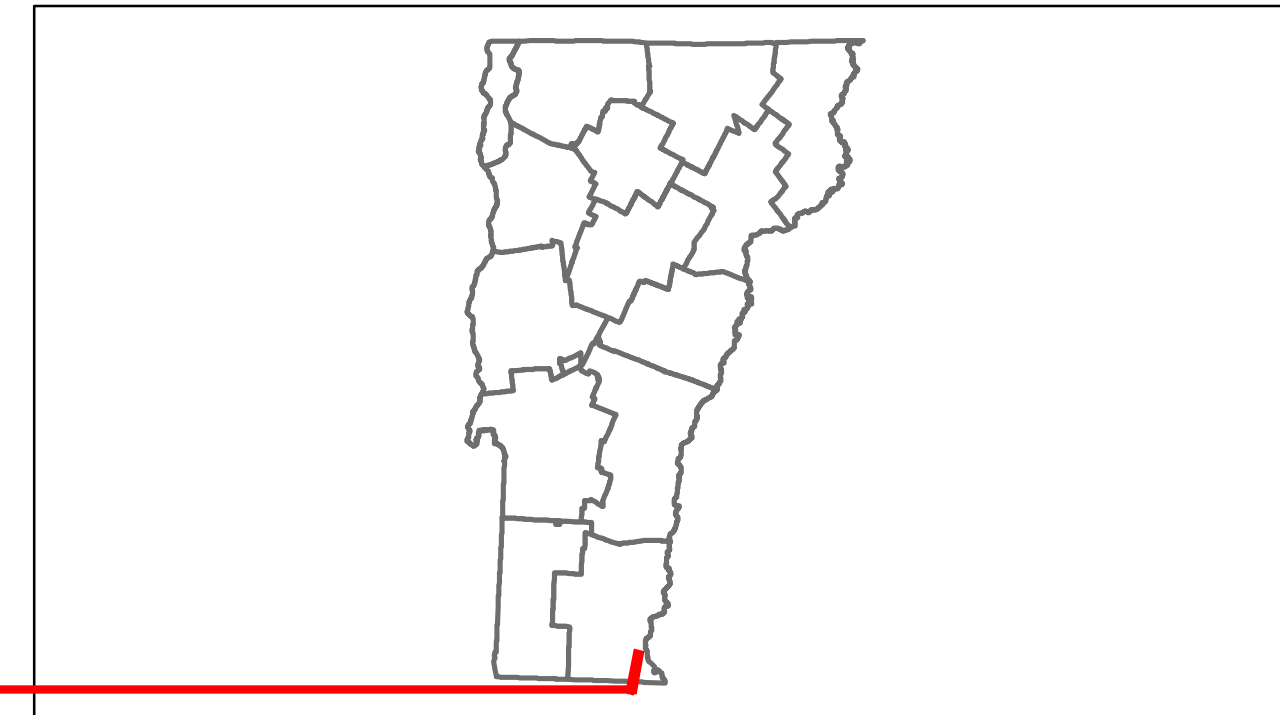

DESCRIPTION BLOCK	
Bridge 63:	Stringer/multi-beam or girder - 1957
	Structure No. 101307006313071
	Length: 64'
	Width: 23.8'
	Facility Carried: C2004
	Bridge Type: ROLLED BEAM
	Features Intersected: BROAD BROOK
	Surface: Bituminous
	Maintenance/Ownership: Town

Travellane	Roadway	Lane Count	Base	Subbase
Curves				
Grades				
Historic Projects				
Maintenance Garage				
Traffic Counters				
Functional Class				
Speed Zone				
AADT Counts				
Crash Locations				

Historic Projects Retreatment, Resurface, Unknown, Bituminous Mix, Skimmy Mix, Bituminous Seal, Bituminous Concrete, Surface Treated Gravel, Plant Mix, Reclaimed Base and Bituminous Concrete, Concrete	Functional Class 1, 2, 6, 7, 8, 11, 12, 14, 17, 19	Curves Left, Right	Grades grade up, grade down	Road Widths (ft)	Traffic Counters (counter ID)	AADT (count)	Crash Locations Fatal, Injury, Property Damage Only, Unknown Crash Type	Mileage by Functional Class By Sheet 0510 8 - Rural - Minor collector 5.090	Mileage by Town By Sheet GUILFORD - S05101307 5.09 of 5.09	DISTRICT 2	TOWN GUILFORD	Date: 05/21/14	ROUTE Min-0510 ETE mileage: 0.0 to 5.09
Total Mileage: 5.090 mi								Total Mileage: 5.09 mi					